

U.S. PUBLIC LAND SURVEY MONUMENT RECORD

Note: This form is intended and designed to fulfill all requirements of Wisconsin Administrative Code, Chapter A-E 7.08 U.S. Public Land Survey Monument Record (3) (a) (b) (c) (d) (e) (f) (g) (h) (i). An additional sheet may be added if necessary to conform with said requirements.

(a) Corner location: Township 38 North

Range 4 East/West

Town/City/Village MINOCQUA

County ONEIDA

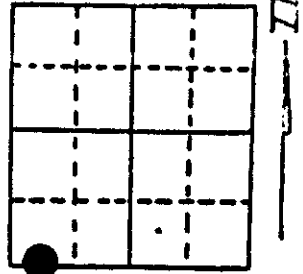

MC Section 27

(b) (f) (g) (h) Description of monument found at this corner and if it was accepted, state all evidence (material, testimonial, occupational, plats, records, other monuments) used as a basis for accepting. If not accepted or if nothing was found, state evidence used as basis for establishing location. If reestablished through lost corner proportionate methods, indicate all monuments, distances and directions used to establish. Indicate type of monument found or set and sign post.

The original government survey was performed by Alexander Anderson in April & May, 1865. A Birch 10" was used as the corner: Aspen 4" N49E, 18 lks., Aspen 4" S68E, 30 lks.

F. Wincentzen used this corner location in his subdivision of section 34, iron pipe (old MC iron pipe in lake 24.6' West): Maple 5" S18W, 16.2', W. Birch 5" S81E, 19.9'.

Inman - Foltz & Assoc. used this corner location in a survey map in Gov't. Lot 1: 1-1/2" iron pipe: W. Birch 7" S80E, 19.75', Maple 10" S17W, 15.9'.

I found and accepted: 1-1/2" dia. iron pipe witnessed by: W. Birch 7" S80E, 20.06', Maple 11" S19W, 16.23'.

(30" long)

I replaced the pipe with a 2-1/2" dia. aluminum pipe with an Oneida County aluminum tablet stamped as shown below. I established witnesses as shown in the diagram below.

(c) (d) (e) Plan view of corner with ties to at least 4 witness monuments. If in disagreement with previously established corner, show the distances between the two corners and also indicate the ties to the disputed corner.

1. W. Pine 10" N18E, 15.16'
 2. W. Birch 7" S80E, 20.06'
 3. N. Pine 11" S14W, 5.00'
 4. Maple 11" S19W, 16.23'
 5. plastic survey sign East, 1 foot.
- distances to nail in side of trees.

PIER

LAKE

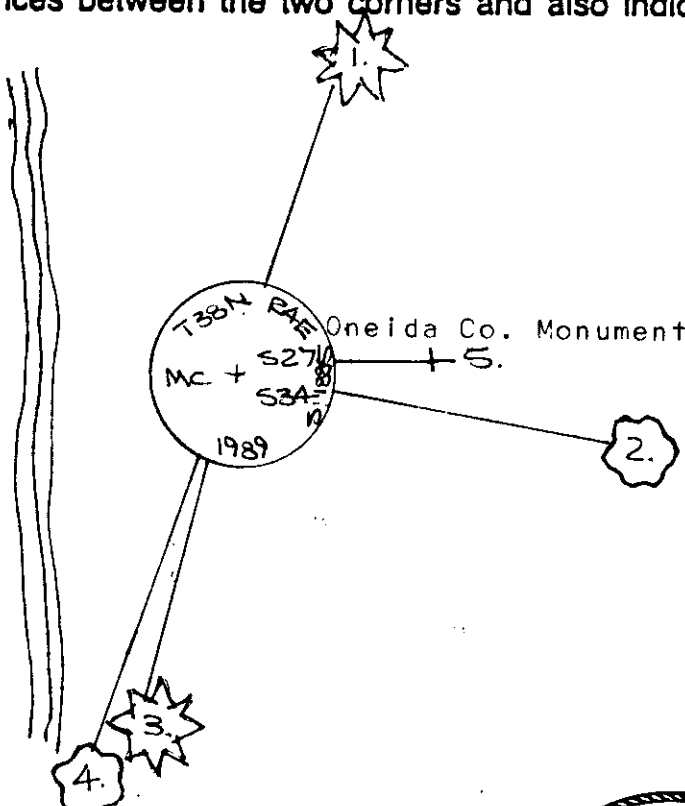

(i) I, JEFFREY W. AUSTIN S-1885

(type or print name) certify that the corner location on this record was determined by me or under my direction and control and that this U.S. Public Land Survey Monument Record is correct and complete to the best of my knowledge and belief.

Signature

Date

MAY 10, 1989



Index No. V-13,15

3804270036

U.S. PUBLIC LAND SURVEY MONUMENT RECORD

Note: This form is intended and designed to fulfill all requirements of Wisconsin Administrative Code, Chapter A-E 7.08 U.S. Public Land Survey Monument Record (3) (a) (b) (c) (d) (e) (f) (g) (h) (i). An additional sheet may be added if necessary to conform with said requirements.

(a) CORNER LOCATION: WISCRS (Oneida County)
Meander Cor. of Secs. 27 & 34 N: 204,334.23 USft
Township 38 North E: 119,168.63 USft
Range 4 East of the 4th P.M. Datum: NAD 1983(2011)
Town of Minocqua County of Oneida

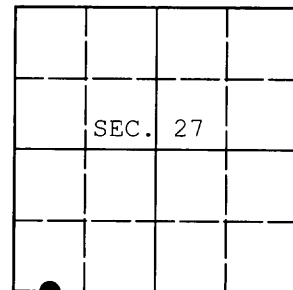

(b) HISTORY OF ORIGINAL CORNER ESTABLISHMENT

Original Surveyor: Original Accessories:
Date of Survey: Commenced:
Completed:

(b)(f)(g)(h) Description of monument found at this corner and if it was accepted, state all evidence (material, testimonial, occupational, plats, records, other monuments) used as a basis for accepting. If not accepted or if nothing was found, state evidence used as basis for establishing location. If re-established through lost corner proportionate methods, indicate all monuments, distances and directions used to establish. Indicate type of monument and sign post found or set.

NOTE: This is a perpetuation of a previous USPLS Monument Record by Jeffrey W. Austin, RLS dated May 10, 1989 and filed in the office of the Oneida County Register of Deeds. A complete history of the corner can be found on the previous monument record. I accept the previous location as a true and faithful perpetuation or reestablishment of the original corner location and further perpetuate it as follows.

August 5, 2014: I found and accepted my previously set monument, a 2-1/2" diam. aluminum pipe with 3-1/4" diam. Oneida Co. aluminum cap projecting 6" above the ground. My previously established accessories were found in substantial agreement with my previous record and were not remeasured as the sole purpose of this work is to report the coordinates of the corner point.

The coordinates shown were derived from offset static GPS observations referenced to the WISCRS network.

(c)(d)(e) Plan view of corner with ties to at least 4 witness monuments. If in disagreement with previously established corner, show the distances between the two corners and also indicate the ties to the disputed.

REGISTER OF DEEDS OFFICE
ONEIDA COUNTY
FILED

OCT 13 2014

AT _____ O'CLOCK _____ M
KYLE J. FRANSON
REGISTER OF DEEDS

(i) I, Jeffrey W. Austin, Registered Land Surveyor No. S-1885, hereby certify that the corner location on this record was determined by me or under my direction and control and that this U.S. Public Land Survey Monument Record is correct and complete to the best of my knowledge and belief.



Signature

Date

SEP. 7, 2014