

**U.S. PUBLIC LAND SURVEY MONUMENT RECORD**

Note: This form is intended and designed to fulfill all requirements of Wisconsin Administrative Code, Chapter A-8 7.08 U.S. Public Land Survey Monument Record (3)(a)(b)(c)(d)(e)(f)(g)(h)(i). An additional sheet may be added if necessary to conform with said requirements.

(a) CORNER LOCATION: State Plane Coordinates  
 NW corner of Sec. 17 X \_\_\_\_\_  
 Township 38 North Y \_\_\_\_\_  
 Range 6 East Datum Base \_\_\_\_\_  
 Town/City Hazelhurst County of Oneida

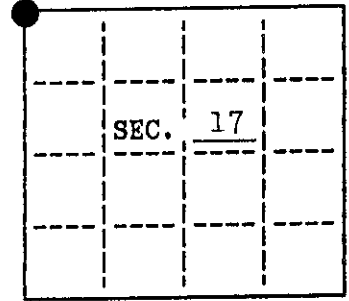

(b) HISTORY OF ORIGINAL CORNER ESTABLISHMENT. Original B.T.'S  
 Original Surveyor: Alexander Anderson Y.Pine 9 N68°E, 95  
 Date of Survey: Commenced Sept. 1863 Y.Pine 10 S79°E, 104  
 Completed Oct. 1863

(b)(f)(g)(h) Description of monument found at this corner and if it was accepted, state all evidence (material, testimonial, occupational, plats, records, other monuments) used as a basis for accepting. If not accepted or if nothing was found, state evidence used as basis for establishing location. If reestablished through lost corner proportionate methods, indicate all monuments, distances and directions used to establish. Indicate type of monument and sign post found or set.

See reverse...

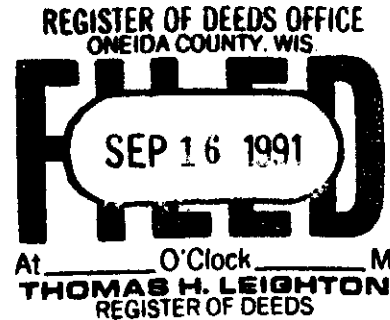

(c)(d)(e) Plan view of corner with ties to at least 4 witness monuments. If in disagreement with previously established corner, show the distances between the two corners and also indicate the ties to the disputed.

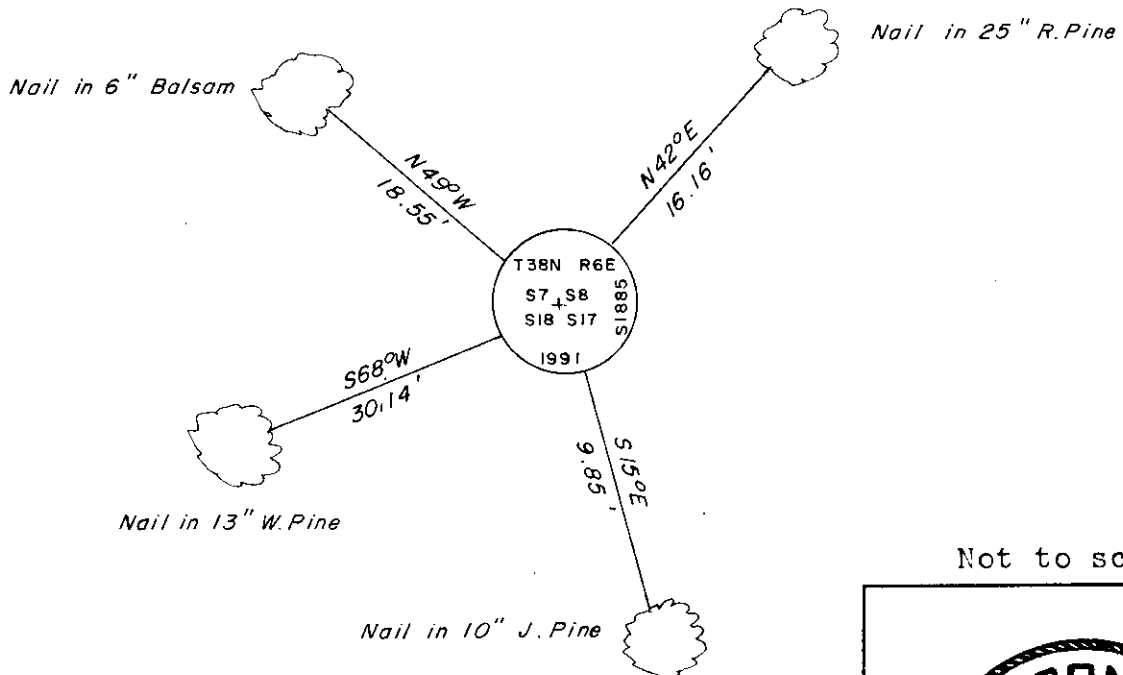

Not to scale.

(i) I, Jeffrey W. Austin, Registered Land Surveyor hereby certify that the corner location on this record was determined by me or under my direction and control and that this U.S. Public Land Survey Monument Record is correct and complete to the best of my knowledge and belief.

Signature *Jeffrey W. Austin* Date 9-12-1991

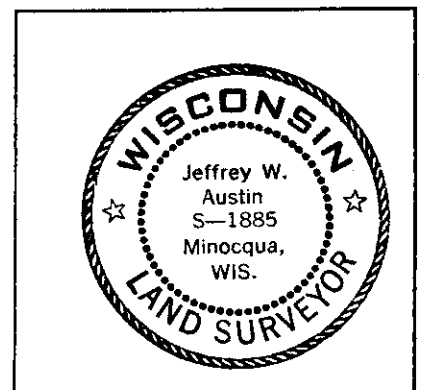

INDEX NO. J-5

3806070000

May, 1949: Notes by Wincentzen, concrete monument, Pine 16 N42°E, 22.5 lks. (old); Pine stp. 8 S20°W, 51.75 lks. (old); S.Pine 9 S19°30'E, 9.8'.

July, 1968: Section subdivision by John Fisher, concrete monument, 10" J.Pine S20°E, 9.6'; 22" N.Pine N40°E, 15.1'; 16" W.Pine stp. N70°E, 13.2'.

September 7, 1991: I found and accepted a 5" sq. 42" long concrete monument. I replaced this monument with a 2-1/2" dia. 30" long aluminum pipe with a 3-1/4" dia. Oneida Co. aluminum cap set 5" above the ground and marked as shown on the reverse side of this record. I found the following witnesses: (Wincentzen) set nail in R.Pine 25" N42°E, 16.16 feet; (Wincentzen) set nail in J.Pine 10" S15°E, 9.85 feet. I established the following witnesses: set nail in W.Pine 13" S68°W, 30.14 feet; set nail in Balsam 6" N49°W, 18.55 feet; set plastic sign post Northwest, 1-1/2 feet. Also a DEEP-1 magnet was set below the new monument.