

U.S. PUBLIC LAND SURVEY MONUMENT RECORD

Note: This form is intended and designed to fulfill all requirements of Wisconsin Administrative Code, Chapter A-E 7.08 U.S. Public Land Survey Monument Record (3) (a) (b) (c) (d) (e) (f) (g) (h) (i). An additional sheet may be added if necessary to conform with said requirements.

(a) CORNER LOCATION: WISCORS (Oneida County)
Meander Cor. of Secs. 15 & 16 N: 217,934.807 USft
Township 38 North E: 181,227.145 USft
Range 6 East of the 4th P.M. Datum: NAD 1983(2011)
Town of Hazelhurst County of Oneida

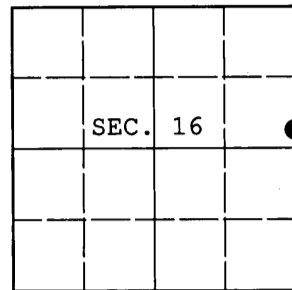

(b) HISTORY OF ORIGINAL CORNER ESTABLISHMENT

Original Surveyor: Original Accessories:
Date of Survey:

(b) (f) (g) (h) Description of monument found at this corner and if it was accepted, state all evidence (material, testimonial, occupational, plats, records, other monuments) used as a basis for accepting. If not accepted or if nothing was found, state evidence used as basis for establishing location. If re-established through lost corner proportionate methods, indicate all monuments, distances and directions used to establish. Indicate type of monument and sign post found or set.

NOTE: This is a perpetuation of a previous USPLS Monument Record by William C. Rohde, RLS dated August 1, 2003 and filed in the office of the Oneida County Register of Deeds. A complete history of the corner can be found on the previous monument record. I accept the previous location as a true and faithful perpetuation or reestablishment of the original corner location and further perpetuate it as follows.

April 27, 2013: I found and accepted Rohde's monument, a 2-1/2" diam. aluminum pipe with 3-1/4" diam. Oneida Co. aluminum cap projecting 4" above the ground surface. Rohde's accessories were found in substantial agreement with his previous record and were not remeasured as the sole purpose of this work is to report the coordinates of the corner point.

The coordinates shown were derived from offset static GPS observations referenced to a VRS control point generated by the WISCORS network.

(c) (d) (e) Plan view of corner with ties to at least 4 witness monuments. If in disagreement with previously established corner, show the distances between the two corners and also indicate the ties to the disputed.

REGISTER OF DEEDS OFFICE
ONEIDA COUNTY
FILED

MAY 14 2013

AT O'CLOCK M
KYLE J. FRANSON
REGISTER OF DEEDS

(i) I, Jeffrey W. Austin, Registered Land Surveyor No. S-1885, hereby certify that the corner location on this record was determined by me or under my direction and control and that this U.S. Public Land Survey Monument Record is correct and complete to the best of my knowledge and belief.



Signature

MAY 10, 2013
Date

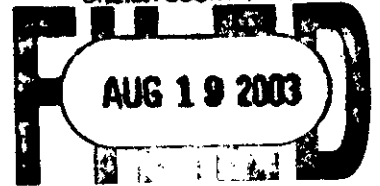

At _____ Clerk _____ M
THOMAS H. LEIGHTON
REGISTER OF DEEDS
Recorders Data

This form is intended to fulfill the requirements of Chapter A-E7.08 (3)(a) thru (i) U.S. Public Land Survey Monument Location Record, Wisconsin Administrative Code. Use the reverse side of form for continuation.

U.S. PUBLIC LAND SURVEY MONUMENT LOCATION RECORD

USPLS CORNER: SOUTH WITNESS MC SECTION: 15 TOWNSHIP: 38 NORTH RANGE: 6 EAST

NAME OF WATERWAY FOR M.C. CORNER : UPPER KAUBASHINE LAKE SECTION LINE: WEST

~~(CITY)(VILLAGE)(TOWN)~~ OF: HAZELHURST COUNTY OF: ONEIDA

Description of monument found or placed and all other evidence used as the basis for monument location; including monuments and measurements required if the corner location was reestablished by lost corner proportionate methods. Also indicate name of the original surveyor, original survey date and the corner monument, bearing trees, witness or other reference monuments established, including measured bearing and distance ties, from available survey records.

Found and accepted an old rusted 1.25" dia. iron pipe on crest of rocky lake shore bank with crimped cut top projecting about 20" and tipped 45°+- NW; I carefully dug to base of the 39" long crimped bottom iron pipe and removed it to reveal the original rust scaled plumb soil cavity for the iron pipe and I then drove a standard 2" dia. by 30" long aluminum pipe monument into the soil cavity with stamped Oneida County cap 4" up and measured new ties. I also set a standard white poly "T" marker post 14" NW of the monument set, which falls about 2 feet from the lake shoreline bearing N45°E this date and is at the NE corner of improved lake lot at Fire No. 1004 South Kaubashine Road.

In September/October 1863, Alexander Anderson/GLO set a wood post as the original corner and noted OBTs: an 8" Maple S10°W 31 links and an 8" Bw S34°E 28 links; all now obliterated.

In December 1977, James D. Rein/RLS 1234 references a 3 lot survey to this MC noted as a "crimped" 1.25" dia. iron pipe found as this Witness MC and to an 8" Bw BT S46°W 11.5' per Volume 2 of Certified Survey Maps Page 508 in Oneida County records.

No further records considered necessary to document the recovery of this record survey Witness MC corner.

This recovery completed June 11, 2003; there were no direct witnesses.

Plan view map of monument location with bearing and distance ties to a minimum of four(4) described witness or reference monuments of concrete, natural stone, iron, live bearing trees or equivalent material. If applicable, also show a minimum of two(2) bearing and distance ties to any other monument found and not accepted; including the bearing and distance from the accepted monument.

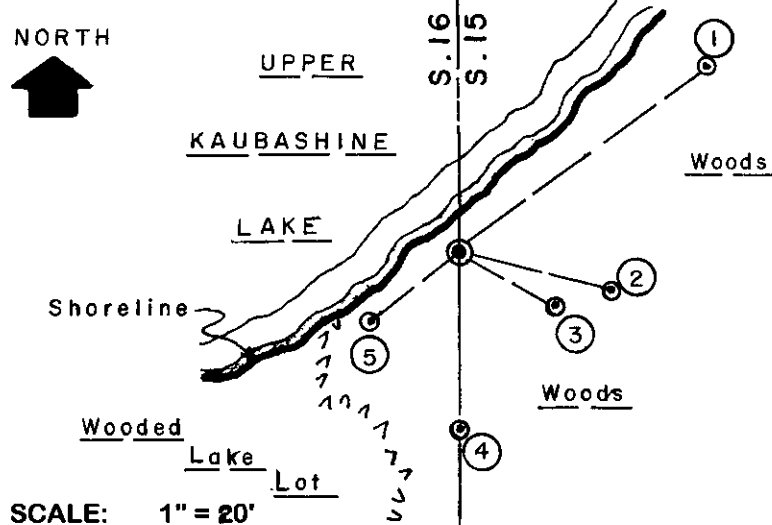

WITNESS MONUMENT TIES:

- ① New 7" Mr BT N53°E 32.00' to PK nail/washer in lower left face.
- ② New 6" Fir BT S75°E 16.66'.
- ③ New 6.5" Hemlock BT S61°E 11.53'.
- ④ New 7.5" Fir BT South 19.04'.
- ⑤ NE trunk of old 10" Bw BT with lower blaze open S50°W 11.55'.

I flagged all BTs, the MC monument and 'T' marker post with blaze orange tape.

Unless otherwise indicated, all bearing tree ties are to a .25" dia. by 2.5" long PK nail with a 1.25" dia. steel washer driven into unblazed right face and a .25" dia. by 2.5" long PK nail with a 2" dia. steel washer stamped BT is also driven into unblazed face of bearing tree at DBH; the basis for measured bearings is by compass to nearest degree and all tie distances are measured horizontal by steel tape corrected to nearest 1/100th feet at standard temperature of 68° F.

RLS SEAL:

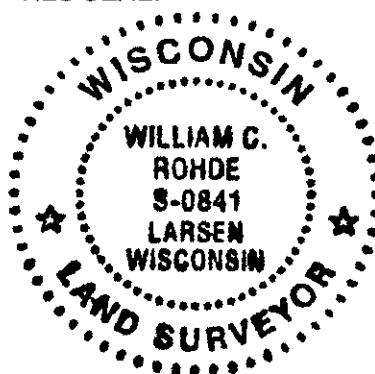

LAND SURVEYOR CERTIFICATE:

I, William C. Rohde, hereby certify that I am duly licensed as a Professional Land Surveyor in the State of Wisconsin; that this USPLS monument location was determined by me and/or under my direct supervision and control; and that this U.S. Public Land Survey Monument Location Record is true and correct to the best of my knowledge and belief.

Signed *William C. Rohde*
William C. Rohde RLS 841

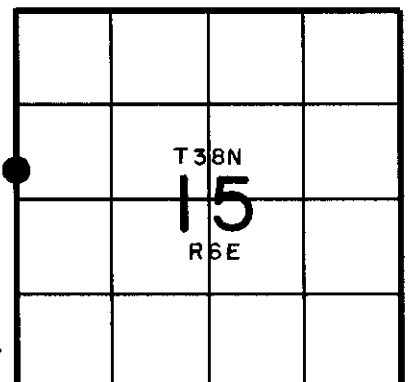

SECTION LOCATION MAP
INDEX NO. K/L 13