

U.S. PUBLIC LAND SURVEY MONUMENT RECORD

Note: This form is intended and designed to fulfill all requirements of Wisconsin Administrative Code, Chapter A-E 5.02, U.S. Public Land Survey Monument Record (3) (a) (b) (c) (d) (e) (f) (g) (h) (i). An additional sheet may be added if necessary to conform with said requirements.

(a) Corner location: Township 38 North

Range 6 East/West

Town/City/Village Hazelhurst

County Oneida

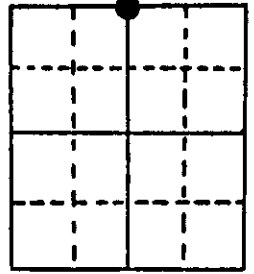

Section 30

(b) (f) (g) (h) Description of monument found at this corner and if it was accepted, state all evidence (material, testimonial, occupational, plats, records, other monuments) used as a basis for accepting. If not accepted or if nothing was found, state evidence used as basis for establishing location. If reestablished through lost corner proportionate methods, indicate all monuments, distances and directions used to establish.

Found and accepted 1-1/2" iron pipe with fence lines to North and East. Located and checked bearing tree of record - Recorded as 24" White Pine, N87°E 105.4 feet (from plat of Interlocher Woods). Replaced pipe with Oneida County 2" x 30" aluminum monument with 3" diameter aluminum tablet stamped to identify corner.

Original survey was performed by Alexander Anderson in September, 1863.

Set Wood Post:

Aspen	9"	N44°W	12 lks.
Aspen	9"	S59°W	8 lks.

(c) (d) (e) Plan view of corner with ties to at least 4 witness monuments. If in disagreement with previously established corner, show the distances between the two corners and also indicate the ties to the disputed corner. Bearing trees not scribed - Distances to nail in tree.

REGISTER OF DEEDS OFFICE
ONEIDA COUNTY, WIS.

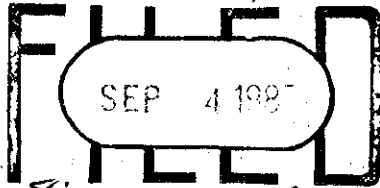

At 8:00 O'Clock 9 M
DORIS VERAGE KUEHN
REGISTER OF DEEDS

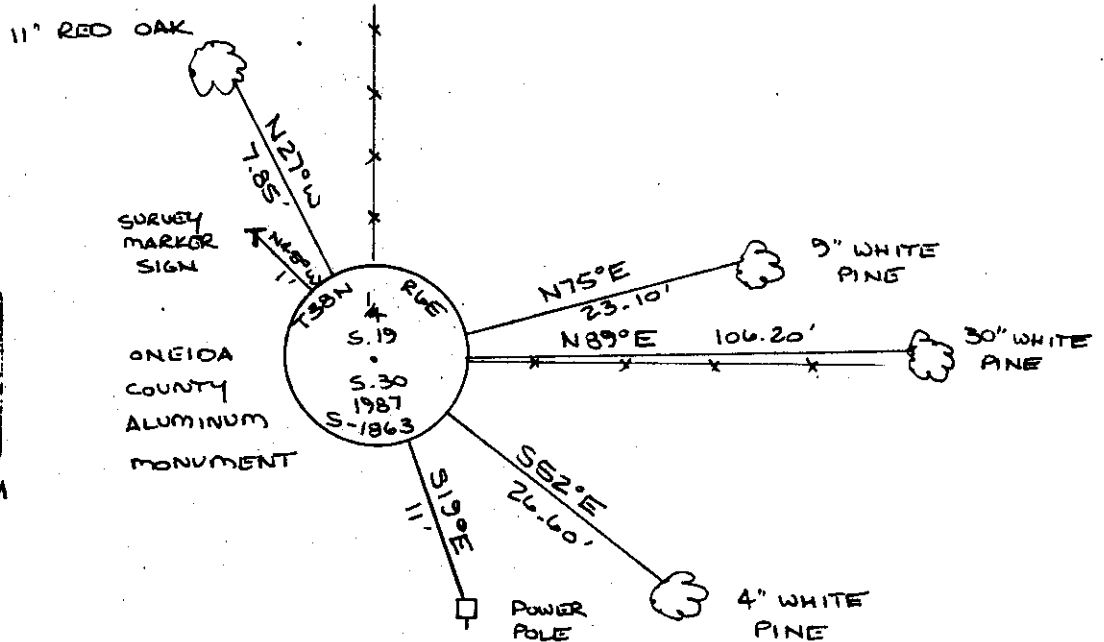

(i) I, Dennis E. Roberts
(type or print name) certify that the corner location on this record was determined by me or under my direction and control and that this U.S. Public Land Survey Monument Record is correct and complete to the best of my knowledge and belief.

Dennis E. Roberts 8-28-87
Signature Date

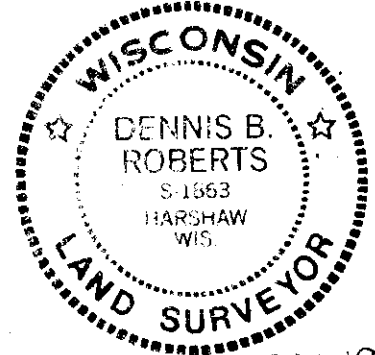

Index No. P-3

3806190020