

U.S. PUBLIC LAND SURVEY MONUMENT RECORD

Note: This form is intended and designed to fulfill all requirements of Wisconsin Administrative Code, Chapter A-E 5.02, U.S. Public Land Survey Monument Record (3) (a) (b) (c) (d) (e) (f) (g) (h) (i). An additional sheet may be added if necessary to conform with said requirements.

(a) Corner location: Township 38 North
 Range 7 East/West
 Town/City/Village Lake Tomahawk
 County Oneida

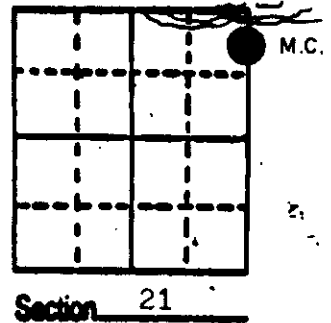
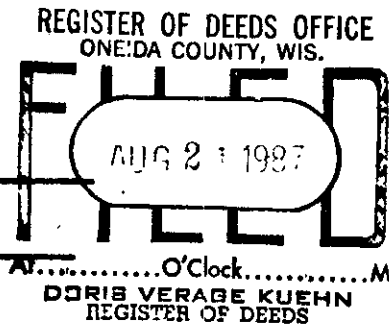

(b) (f) (g) (h) Description of monument found at this corner and if it was accepted, state all evidence (material, testimonial, occupational, plats, records, other monuments) used as a basis for accepting. If not accepted or if nothing was found, state evidence used as basis for establishing location. If reestablished through lost corner proportionate methods, indicate all monuments, distances and directions used to establish.

- 1863 Alexander Anderson established original corner... North between 21 & 22... 67.27 set M.C. W Pine 10 S 41 E 11; W. Pine 12 S 27 W 22.
- 1891 B.F. Dorr measures from S.W. corner North 68.00 to lake and found nothing.
- 1928 The General land office executed a retracement survey of lands in S 16 T 38 N, R 7 E and in doing so ran a line from the M.C. on the North side of Lot 5 bet 15 & 16 South 22.20 set Temp. stake on South shore Lot 5. Thence over lake 52.30 to stake on South shore of lake (nothing found and no B.T.s made) thence 81.76 to original corner between 21 & 22
- 1938 V. Maine Oneida County Surveyor set the M.C. on South side of South Two Lakes on line between the orig cor. between 21 & 22 and the N.E. corner of Sec. 21 which he established in the Lake by unknown methods. He also set the 1/8 corner and subdivided section 21 setting many interior corners.
- 1962 J.C. Kirby recovered Maines M.C.; iron pipe E.T.s oak 6" N 70 W 15.6' Birch 6" S 15° W 15.7 and also recovered Maines 1/8

(c) (d) (e) Plan view of corner with ties to at least 4 witness monuments. If in disagreement with previously established corner, show the distances between the two corners and also indicate the ties to the disputed corner.

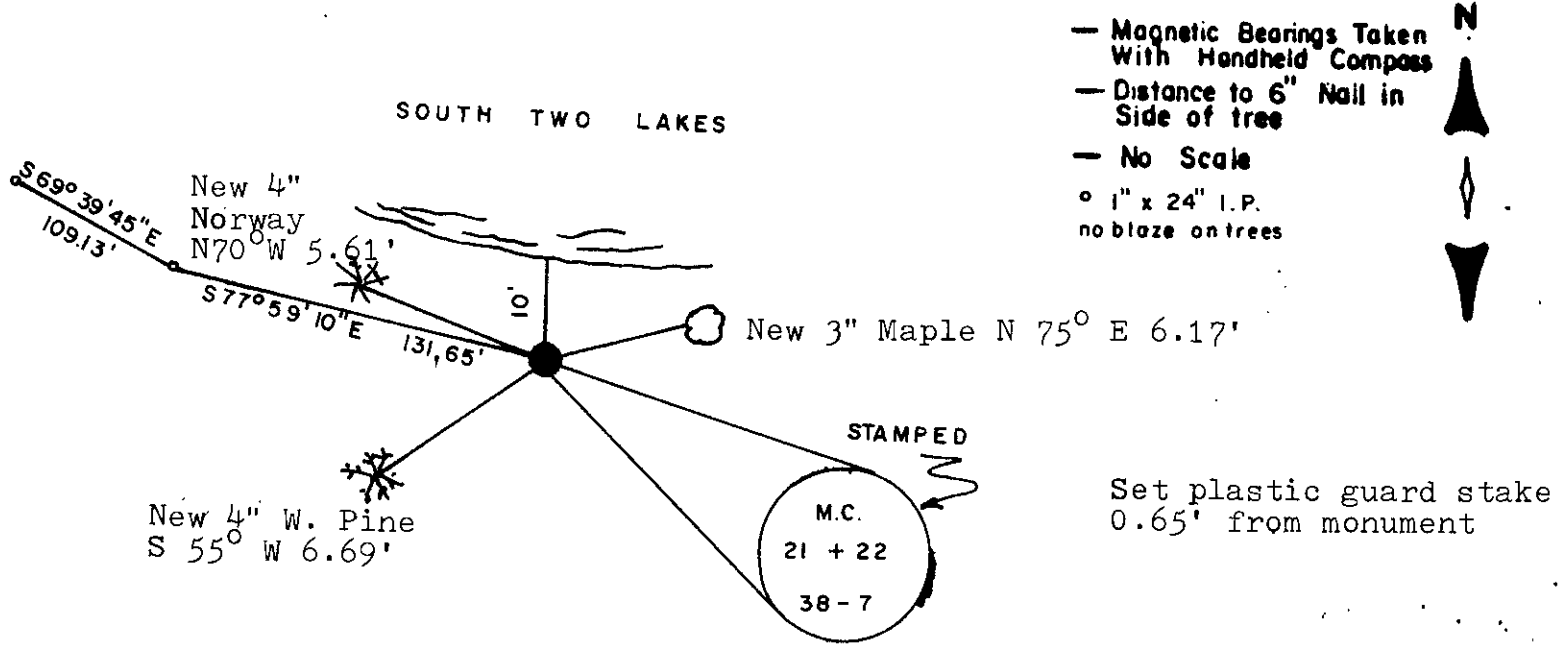

(i) I, Michael J. Romportl
 (type or print name) certify that the corner location on this record was determined by me or under my direction and control and that this U.S. Public Land Survey Monument Record is correct and complete to the best of my knowledge and belief.

Michael J. Romportl 7-16-87
 Signature Date

GENISOT & ASSOCIATES INC.
 1512 EAGLE ST., RHINELANDER, WIS.

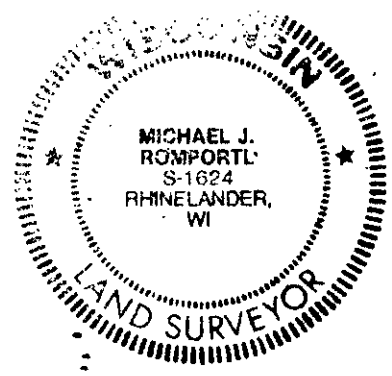

Index No. N-O-13

3807213700

- 1960's Northwoods recovered Maines M.C.
-1972 L.J. Schmidt recovered Maines M.C. and used it to lay out lots to the East in Sec. 22
-19 Northwoods used East section line established by Maine to survey lots in the SE-NE
-1987 I found a 2" i.p. marking Maines M.C. and the Oak B.T. now a stump with scribing visible, N 70 W 15.6'. I find that the $\frac{1}{4}$ corner bet 21 & 22, the $\frac{1}{8}$ corner and the M.C. line up very closely and check with Maines distance. I am of the opinion that the M.C. established by Maine may have been set by disputable methods however there have been several surveys done using that corner for 50 years and I cannot justify moving the corner. The original corner has never been found so I accept Maines corner position. I replaced the 2" i.p. with an Oneida County aluminum capped monument and witnessed it as shown.