

U.S. PUBLIC LAND SURVEY MONUMENT RECORD

Note: This form is intended and designed to fulfill all requirements of Wisconsin Administrative Code, Chapter A-E 7.08 U.S. Public Land Survey Monument Record (3)(a-i).

(a) CORNER LOCATION
 1/4 Cor. of Secs. 5 & 6
 Township 38 North
 Range 8 East of the 4th P.M.
 Town of Newbold
 County of Oneida

WISCRS - Oneida County
 N: 227,755.25 USft
 E: 233,896.85 USft
 Datum: NAD 83(2011) ep. 2010.00
 GNSS Method: RTN - Direct
 GNSS Control: WISCORS VRS

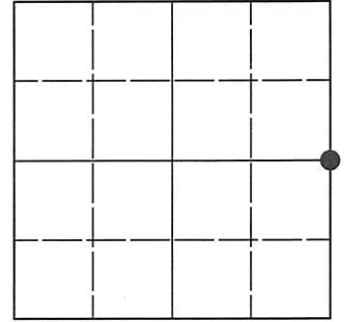

Sec. 6, T. 38 N., R. 8 E.

(b)(f)(g)(h) Description of monument found at this corner and if it was accepted, state all evidence (material, testimonial, occupational, plats, records, other monuments) used as a basis for accepting. If not accepted or if nothing was found, state evidence used as basis for establishing location. If re-established through lost corner proportionate methods, indicate all monuments, distances and directions used to establish. Indicate type of monument and sign post found or set.

July, 1863: GLO survey by Alexander Anderson, U.S. Deputy Surveyor. South corrected between Secs. 5 and 6, at 37.50 chs. set a wood post witnessed by: maple 9 S87.5°W, 7 lks.; maple 7 N76°E, 15 lks.

March, 1965: On OCS Map No. C-2040, James Griffin identifies corner as "iron pipe" set by proportion.

April, 1974: On OCS Map No. B-799, John Fisher subdivides the section and Gov't. Lot 3.

July 25, 2023: To my surprise, I found no evidence of an iron monument at this corner. As a result of reviewing the records of Northwoods Surveyors, I was able to compute the location of this corner using the previous GNSS measurements on 3808060020 and 3808060000. Near this location, I found the point of a wood post buried in the bog. To further substantiate this find, I searched for and found the first traverse nail South (S11°51'E, 118.86') of this corner. The relationship of this nail, the wood post point and 3808060000 agrees well leading me to accept the wood post point as the corner. At the corner point, I set a 1.0" diam., 30" long aluminum pipe with a 2.5" diam. Oneida Co. aluminum cap flush with the bog surface. I found or established accessories as indicated below. I set a white vinyl sign post bearing Southeast, 0.6 ft.

The coordinate value shown is the weighted mean of two or more GNSS observations at markedly different times satisfying the accuracy requirements defined and qualified in the 2022 Oneida County Fee Schedule for USPLS Corners.

(c)(d)(e) Plan view of corner with ties to at least 4 witness monuments. If in disagreement with previously established corner, show the distances between the two corners and also indicate the ties to the disputed.

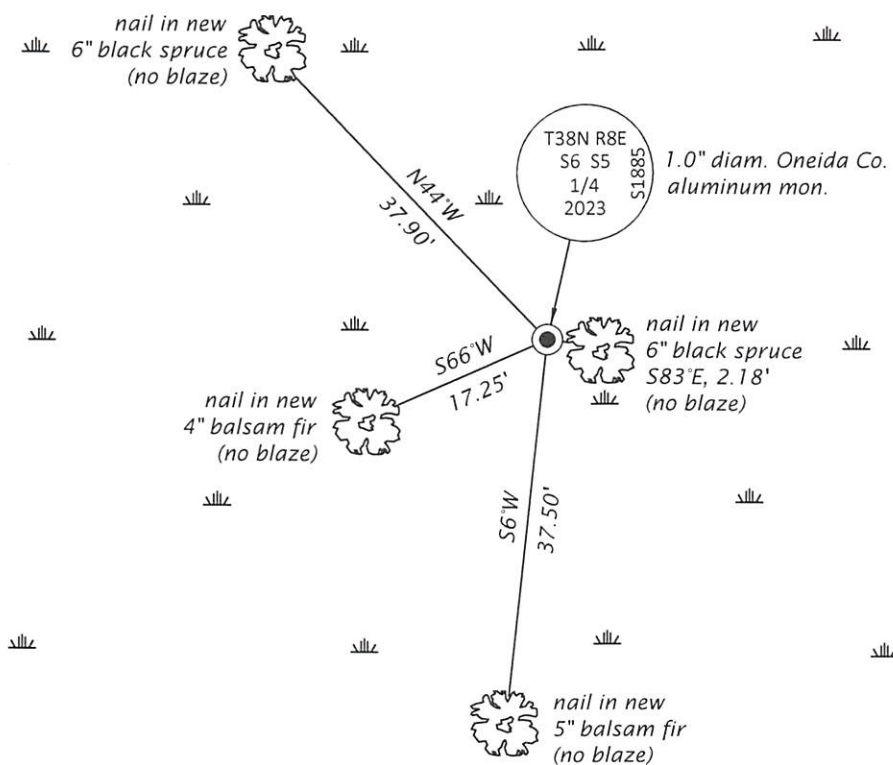

REGISTER OF DEEDS OFFICE
 ONEIDA COUNTY
 FILED

AUG 07 2023

KYLE J. FRANSON
 REGISTER OF DEEDS

(i) I, Jeffrey W. Austin, Professional Land Surveyor No. S-1885, hereby certify that the corner location on this record was determined by me or under my direction and control and that this U.S. Public Land Survey Monument Record is correct and complete to the best of my knowledge and belief.

[Handwritten Signature]
 Signature

AUG. 1, 2023
 Date