

# U.S. PUBLIC LAND SURVEY MONUMENT LOCATION RECORD

Recorders Data

CORNER: North 1/4 SECTION: 5 TOWNSHIP 37 NORTH RANGE 8 EAST/WEST

FOR M.C. CORNER INDICATE: NAME OF WATERWAY N/A SECTION LINE N/A

(CITY)(VILLAGE)(TOWN) OF: Newbold COUNTY OF: Oneida

Description of monument found or placed and all other evidence used as a basis for monument location; including all monuments and related measurements required if the corner location is reestablished by lost corner proportionate methods. Also indicate name of original surveyor, survey date, corner monument set and established bearing trees, witness or reference monuments with ties from available records.

No corner or BT evidence found at this corner location, so I reestablished the corner by proportional measurement as indicated upon the reverse side of this record.

In 1860, Millard set a wood post as the original quarter corner and marked OBTs, a 12" Pw N80°E 14 lks and a 12" Aspen S50°W 16 lks, all of which are obliterated within existing roadway area.

In 1958, A.L. Genisot/Genisot Engineering Company of Rhinelander, Wis. surveyed tracts in adjoining Govt Lot 5 of Section 32, Township 38 North, Range 8 East, per Plat of Survey filed as B-3107 in Oneida County survey records, which I used as the basis for setting this corner by retracement survey.

On an unknown date subsequent to the 1958 Genisot survey, CCC notes of record indicate that a railroad spike was set at this corner according to notes by "Genisot Engineering Co.", and could not be found with magnetic locator in the roadway area; no BTs were noted by CCC.

In 1993, T. Loftus prepared Plat of Survey filed as L-1328 in Oneida Co. survey records in the SWSW of Section 32 adjoining, but I did not use for reestablishment purposes as the section line by such survey did not conform with the 1958 Genisot survey. This recovery completed September 15, 1998; no direct witnesses other than by vehicular traffic.

Plan view map of monument location with bearing and distance ties to a minimum of four(4) described witness or reference monuments of concrete, natural stone, iron, live bearing trees or equivalent material. If applicable, also show a minimum of two(2) bearing and distance ties to any other monument found and not accepted; including the bearing and distance from the accepted monument. Indicate the basis for bearings of reference ties if not referenced to magnetic north.

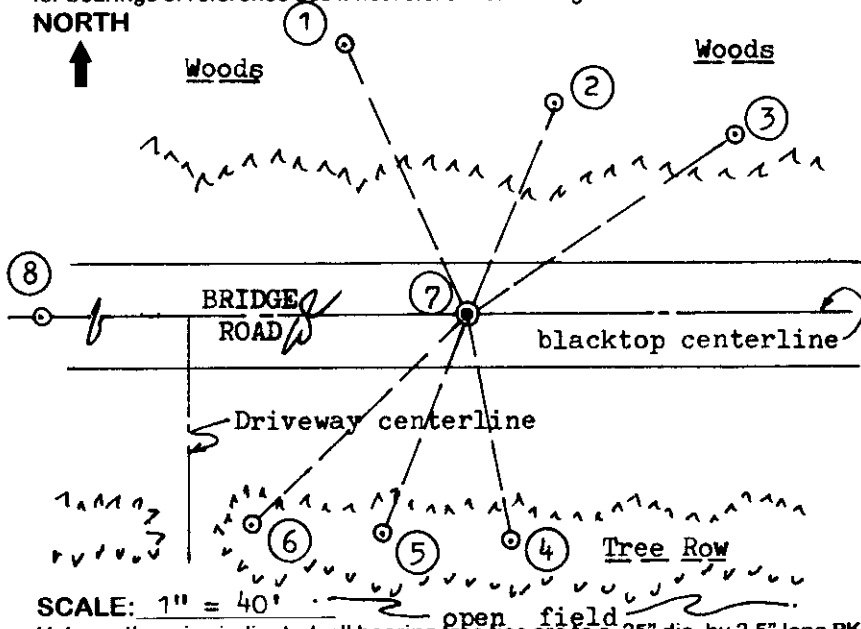

### WITNESS MONUMENT TIES:

- ① New BT 14" Pr N24°W 62.51'.
- ② New BT 9" Pr N22°E 47.20'.
- ③ New BT 12" Pr N56°E 66.45'.
- ④ New BT 7" Pr S10°E 47.86'.
- ⑤ New BT 8" Pr S21°W 48.91'.
- ⑥ New BT 10" Sb S46°W 63.24'.
- ⑦ 3/4" Dia. by 12" steel shaft set flush at corner in blacktop.
- ⑧ 1" dia. by 24" long iron pipe set flush in blacktop West 129.24' in place of old rusted 1" dia. by 18" long iron pipe monument found bent 6" below grade in older blacktop pavement by record survey, per Plat of Survey B-3107 Oneida Co. records.

SCALE: 1" = 40'  
 Unless otherwise indicated, all bearing tree ties are to a .25" dia. by 2.5" long PK nail with a 1.25" dia. steel washer driven into unblazed right face and a .25" dia. by 2.5" long PK nail with a 2" dia. steel washer stamped 'BT' is also driven into unblazed face of bearing tree at DBH; the basis for measured bearings is magnetic to nearest degree and all tie distances are horizontal measure to nearest 1/100th feet.

### LAND SURVEYOR CERTIFICATION:

I, William C. Rohde, hereby certify that I am a duly licensed Professional Land Surveyor in Wisconsin, that this USPLS monument location was determined by me or under my direction and control, and that this U.S. Public Land Survey Monument Location Record is true and correct to the best of my knowledge and belief.

*William C. Rohde* Date: 9-27-98  
 Signature

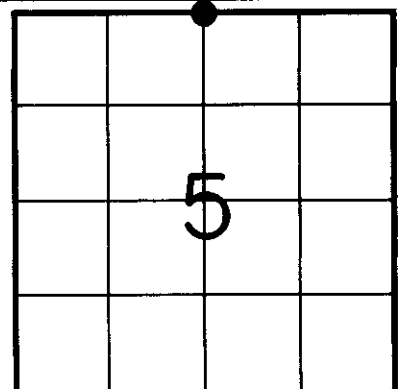

### SECTION LOCATION MAP

INDEX NO. A 17

3808320020

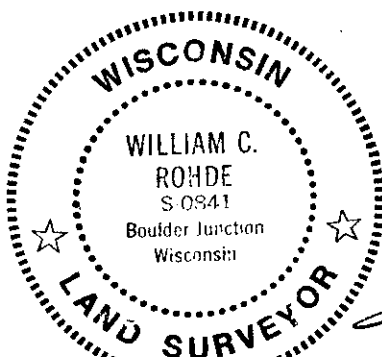

RLS SEAL

SHEET NO. 1 OF 1

This form is intended to fulfill requirements of Chapter A-E 7.08 (3)(a)(b)(c)(d)(e)(f)(g)(h)(i) U.S. Public Land Survey Monument Location Record, Wisconsin Administrative Code. Use reverse side for geodetic location data and/or continuation purposes.

INDEX NO.

A 17

SCALE: 1" = 300' feet

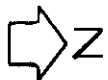

Found standard aluminum pipe monument with Oneida Co. cap gone at NW corner of Section 5.

No monumentation evidence found at N1/16NW forty corner location.

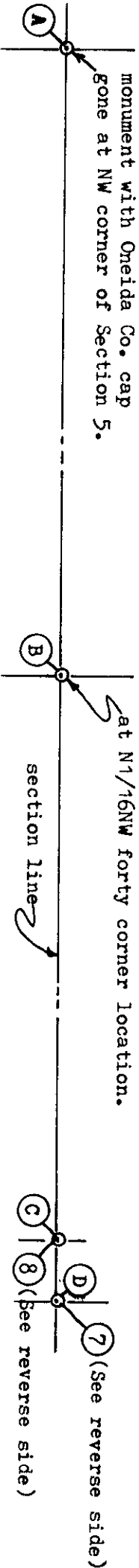

Record Distances: A - B 1317.3' per 1958 Genisot Survey. C - D 131.30' per 1958 Genisot Survey.

B - C 1188.0' per 1958 Genisot Survey.

A - C 2505.3' per 1958 Genisot Survey.

A - D 2634.6' per 1958 Genisot Survey.

New Distances-1998: A - C 2504.13' by Topcon ET-1 Total Station measure.

Therefore by Proportion: 2505.3'(1958)AC : 2504.13'(1998)AC

$$\frac{2505.3'(1958)AC}{2634.6'(1958)AD} = \frac{2504.13'(1998)AC}{AD(1998)}$$

$$AD(1998) = 2633.37'$$

Therefore CD or 8-7 (1998) = 129.24' used to reset 1/4 corner East on right line from A thru C.

REGISTER OF DEEDS OFFICE  
ONEIDA COUNTY, WIS.  
**FILED**  
OCT 12 1998  
At \_\_\_\_\_ O'Clock \_\_\_\_\_ M  
THOMAS H. LEIGHTON  
REGISTER OF DEEDS