

State of Wisconsin

County of Oneida } ss.

I Phillip T. Hansen, do hereby certify that on the 30th day of December, 1977, I found evidence of the N 1/16 corner of Section 25 & 30

38, North, Range 10 & 11 East, Fourth Principal Meridian,

as described hereon; and that from this evidence I established a new monument and accessories as described hereon to perpetuate the original location of this corner.

Resident witnesses:

Jim Clafflin

Herb Wagoner

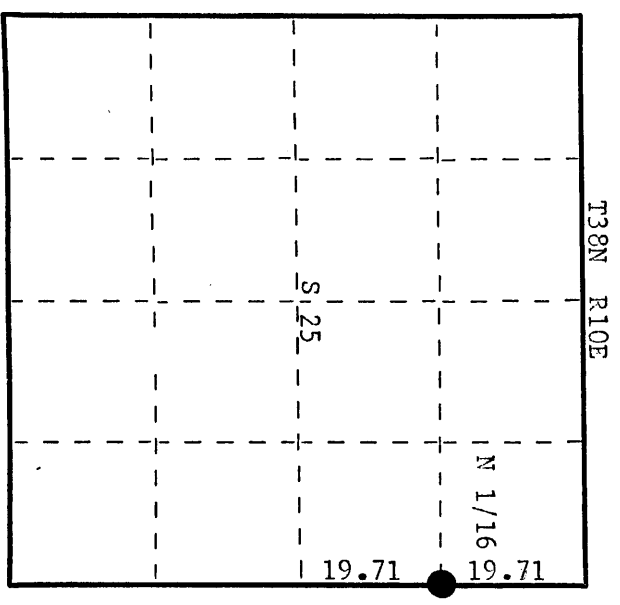
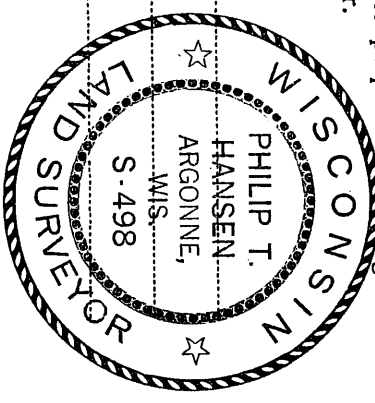

○ = Corner monument restored.

History of original corner establishment:  
Corner recovered by Goddard and crew, Ripco surveyors, in 1960.  
Ran random line from a recovered NE corner bearing 181° 37' at 19.77 chains, closed out 80 links east of a wood post for N 1/16 corner. Continued south and closed out 1.58 chains east of E 1/4 corner. No record of BPT's found or established.

Description of corner evidence found:

Recovered 5" cedar post, squared and scribed 1/16, origin unknown.  
Recovered pine stump, scribed but barely visible at N 46° W, 37.7 links.

Description of monument and accessories I established to perpetuate the original location of this corner.

Replaced cedar post with 1 1/2" iron pipe with 2" brass cap, stamped:  
Monument projects 28" above ground.  
Marked NPT's - Black Spruce 8" S85°W, 53.2 links, scribed 1/16 BT.  
Black Spruce 5" N7°E, 35.6 links, scribed 1/16 BT.

S498  
T38N  
R 25  
E 10 S 1/16  
1977  
R 30  
E 11

Dated at Rhineland, Wis., this 3rd day of January, 1978

Signature Phillip T. Hansen Title Registered Land Surveyor Registration No. S-498  
(County Surveyor, Registered Land Surveyor, or other duly authorized official)

Office of Register of Deeds, County of Oneida  
Instrument was filed in this office for record on the 18th day of January, 1978  
at 1:00 o'clock P. M.

Dorai Verage Kuehn  
(Register of Deeds)

By \_\_\_\_\_ Deputy

3810253000