

Stock No. 26273

U.S. PUBLIC LAND SURVEY MONUMENT RECORD

Index No. E 24-25

State of Wisconsin } ss.  
County of Oneida

I, John H. Fisher, do hereby certify that on the 24 day of October 19 84, I found evidence of the Neander corner of Sections 1 & 12 Township 38 North, Range 11 East, Fourth Principal Meridian, as described hereon; and that from this evidence I established a new monument and accessories as described hereon to perpetuate the original location of this corner.

Resident witnesses:

None

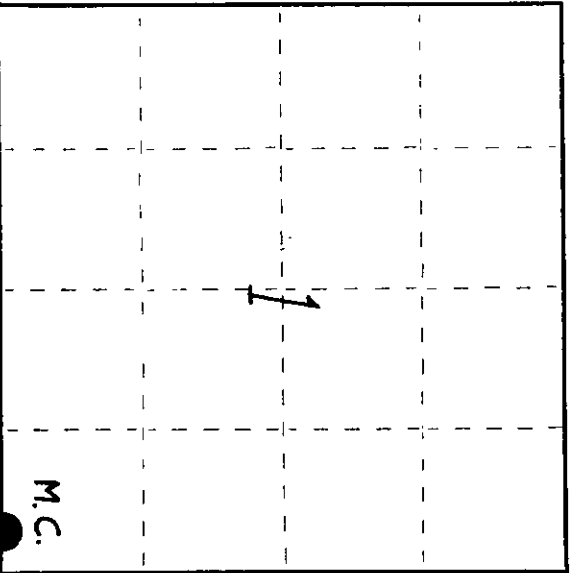

O = Corner monument restored.

History of original corner establishment: Original survey in 1899 by Alfred Willard. Dependent survey in 1941 by Hugh B. Crawford. At 38.92 chains set a concrete monument 24 inches long, 6 inches diameter. 20 inches in the ground with iron post 23 inches long. 1 inch diameter embedded in center with brass tablet stamped:  
From which the following bear.

T 38 N  
S 1 18"  
5.12 / MC. White Pine 18" N23°E 30 lks  
R 11 E 16" Norway Pine S70°W 33-1/2 lks  
1941

Description of corner evidence found:  
B.L.M. Monument as described and in place and the following bearing tree.

Red Pine 26" S70°W 22.0 feet

Description of monument and accessories I established to perpetuate the original location of this corner.  
Corner in good condition. Blazed and scribed the following new bearing trees:  
Set nails in:

White Pine 5" N38°E 12.3 feet  
Red Pine 5" N10°E 7.1 feet  
White Pine 10" S29°W 42.9 feet  
Set steel sign post S66°E 1.0 feet

Dated at Minocqua, Wis., this 21st day of March, 1985

Signature: John H. Fisher Title Registered Land Surveyor Registration No. S-536  
(County Surveyor, Registered Land Surveyor, or other duly authorized official)

Office of Register of Deeds, County of Oneida  
Instrument was filed in this office for record on the 33rd day of October 1985 at 3:30 o'clock P.M.  
Doris V. Kasper (Register of Deeds)

By: Deputy

3811010003

(e) Describe any material discrepancy between the location of the corner as restored or reestablished and the location of that corner as previously restored or reestablished by distance and direction. Show the discrepancy on the plan view drawing under (d), above. Show the distances between the corner as previously restored or reestablished and (1) the corner as restored or reestablished, and (2) to at least 2 of the witness monuments shown on the drawing in (d), above.

See drawing below

(f) Was the corner restored through acceptance of (1) an obliterated evidence location, or, (2) a found perpetuated location?

Found perpetuated location

(g&h) Was the corner reestablished through lost corner proportionate methods? If so, show the method, including the directions and distances to other public land survey corners used as evidence or used for proportioning in determining the corner location?

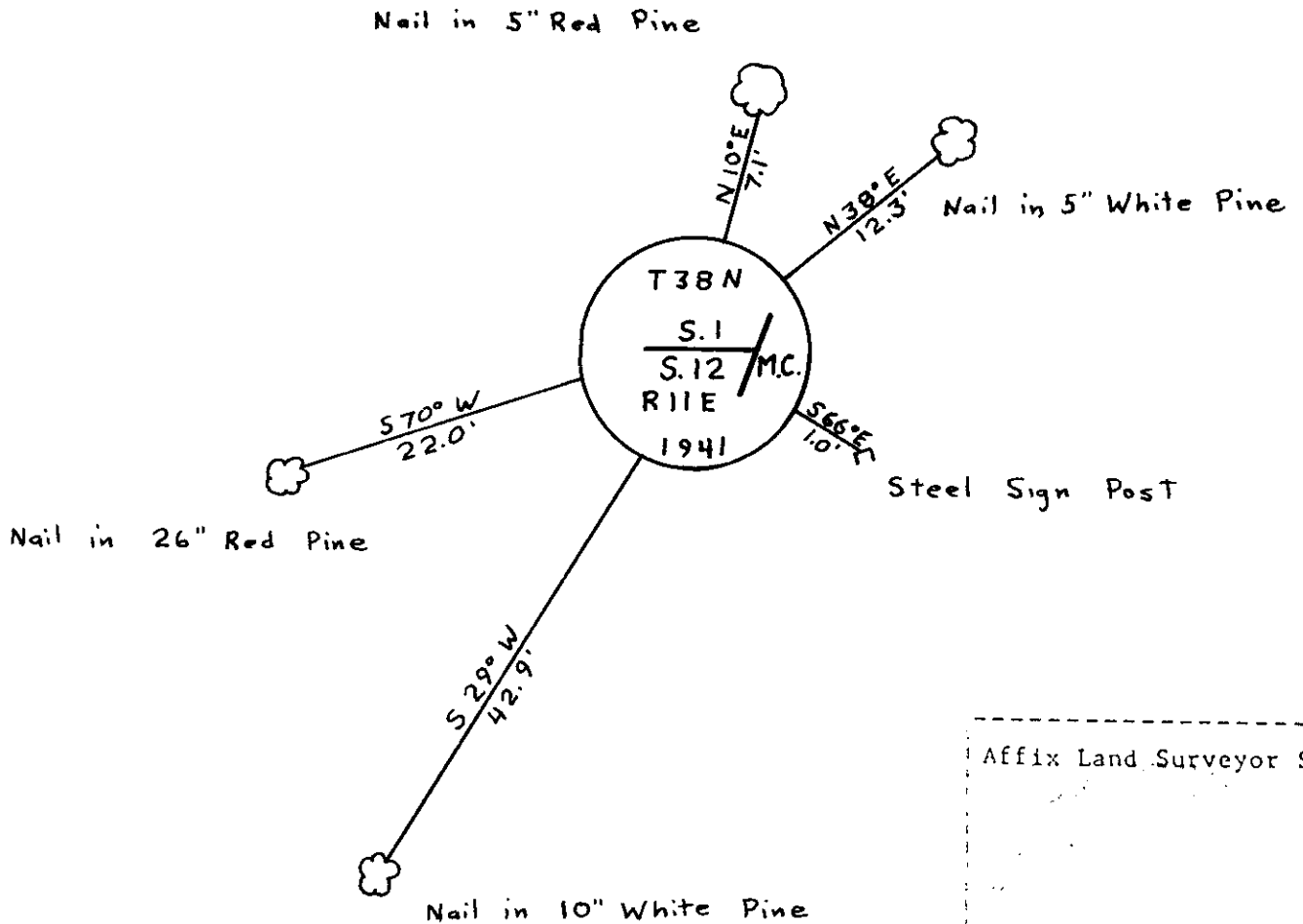

Affix Land Surveyor Seal

(i) I, John H. Fisher  
 (type or print name) certify that the corner location shown on this record was determined by me or under my direction and control and that this U.S. Public Land Survey Monument Record is correct and complete to the best of my knowledge and belief.

John H. Fisher  
 Signature

3/21/85  
 Date