

U.S. PUBLIC LAND SURVEY MONUMENT RECORD

Note: This form is intended and designed to fulfill all requirements of Wisconsin Administrative Code, Chapter A-E 5.02, U.S. Public Land Survey Monument Record (3) (a) (b) (c) (d) (e) (f) (g) (h) (i). An additional sheet may be added if necessary to conform with said requirements.

(a) Corner location: Township 38 North

NW COR.

Range 11 East

Town/City/Village of THREE LAKES

County of ONEIDA

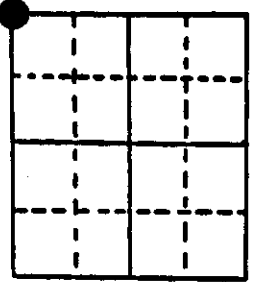

Section 35

(b) (f) (g) (h) Description of monument found at this corner and if it was accepted, state all evidence (material, testimonial, occupational, plats, records, other monuments) used as a basis for accepting. If not accepted or if nothing was found, state evidence used as basis for establishing location. If reestablished through lost corner proportionate methods, indicate all monuments, distances and directions used to establish.

- 1859 William E. Daugherty established original corner @ 80 chains north of SW corner. B.T.s; Hemlock 10 N 66 E 9, Hemlock 10 S 83 W 15.
- 1918 D.H. Vaughn states that he will locate corner by chaining south from lake 1.06 chains, then run west 6.42 chains as called for in U.S. notes and try until he finds the point where these two measurements will agree with shore. Determined point where corner must be and drove a small iron rod. No evidence of original could be found.
- 1941 Hugh B. Crawford, a surveyor with the General Land Office, executed a resurvey of Section 35 and at this position he found a 1/4" pin set in line with fence to the south and at north edge of field. He states it has been in use for several years and it's relation to the shores of Crooked Lake East, West, & North check closely with recorded distances. In place of pin he set a 6" x 24" capped concrete monument. B.T.s; W. Birch 6 N 56 1/2 E 27 1/2 lks., Poplar 10 S 43 E 8 lks., W Birch 5 N 33 3/4 W 22 lks.
- At this corner I found the G.L.O. mon. in good condition and witnessed it below

(c) (d) (e) Plan view of corner with ties to at least 4 witness monuments. If in disagreement with previously established corner, show the distances between the two corners and also indicate the ties to the disputed corner.

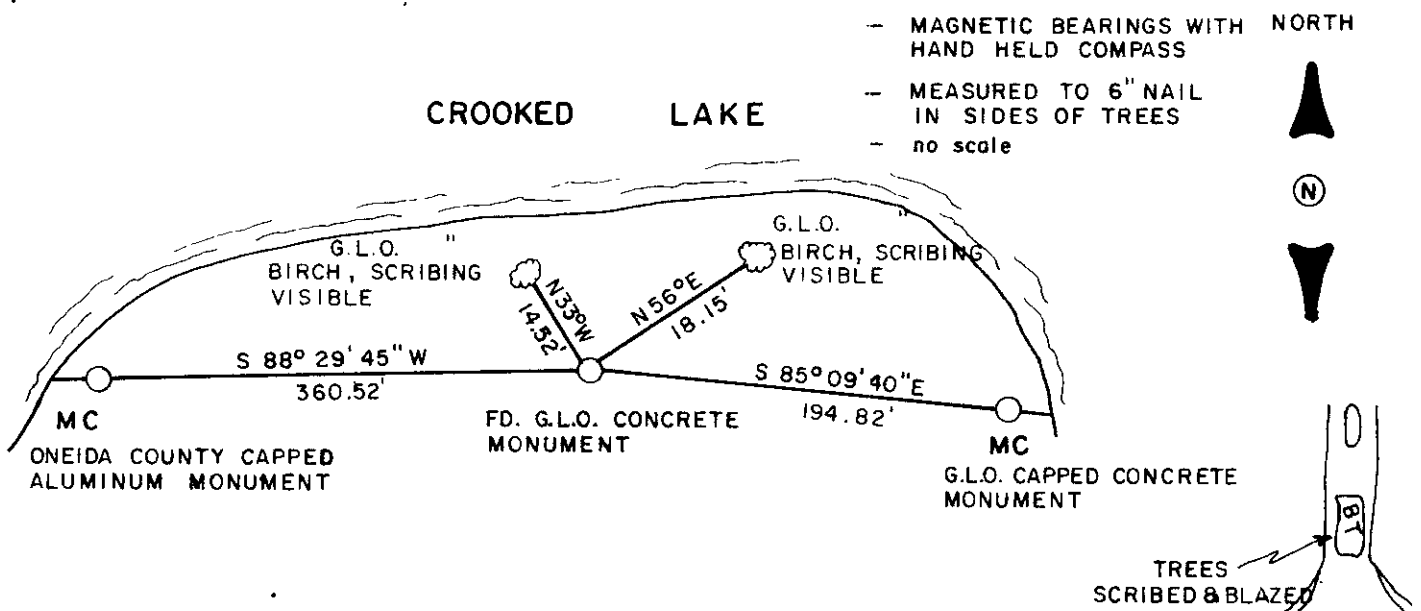

(i) I, MICHAEL J. ROMPORTL R.L.S. 1624

(type or print name) certify that the corner location on this record was determined by me or under my direction and control and that this U.S. Public Land Survey Monument Record is correct and complete to the best of my knowledge and belief.

Michael J. Romportl
Signature

MAY 31, 1985
Date

GENISOT & ASSOCIATES, INC. - 1512 EAGLE ST., RHINELANDER, WIS.

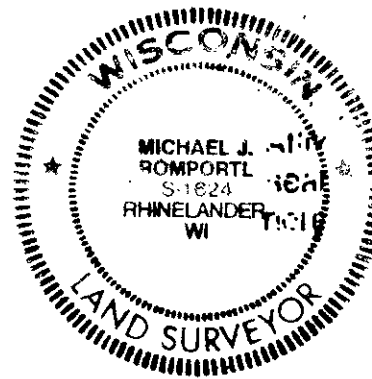

3811270060

Index No. V-17