

U.S. PUBLIC LAND SURVEY MONUMENT RECORD

Note: This form is intended and designed to fulfill all requirements of Wisconsin Administrative Code, Chapter A-E 5.02, U.S. Public Land Survey Monument Record (3) (a) (b) (c) (d) (e) (f) (g) (h) (i). An additional sheet may be added if necessary to conform with said requirements.

(a) Corner location: Township 39 North
 Range 7 East ~~11~~

Town ~~Woodruff~~ of Woodruff

County Oneida

2" iron pipe with W.C.D. brass cap

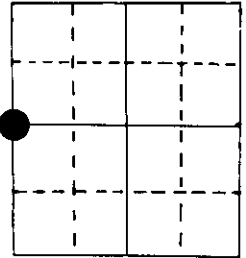

W 1/4 Section 3

(b) (f) (g) (h) Description of monument found at this corner and if it was accepted, state all evidence (material, testimonial, occupational, plats, records, other monuments) used as a basis for accepting. If not accepted or if nothing was found, state evidence used as basis for establishing location. If reestablished through lost corner proportionate methods, indicate all monuments, distances and directions used to establish.

Original Alex Anderson Sept 1863. OBT's Asp 7" S 87°W 18 lks, BW 8" East 10 lks

Berndt in 4/4/60 set proportioned 1/4 cor. BT's OR 9" S 74°E 0.295 ch, B W 8" S 28°W 0.035 ch
 PW 14" S 62°W 0.570 ch

I reset 1/4 cor. on 5/8/84. Berndt's cor was in error because N 1/4 10 was found after computing and was not corrected.

(c) (d) (e) Plan view of corner with ties to at least 4 witness monuments. If in disagreement with previously established corner, show the distances between the two corners and also indicate the ties to the disputed corner.

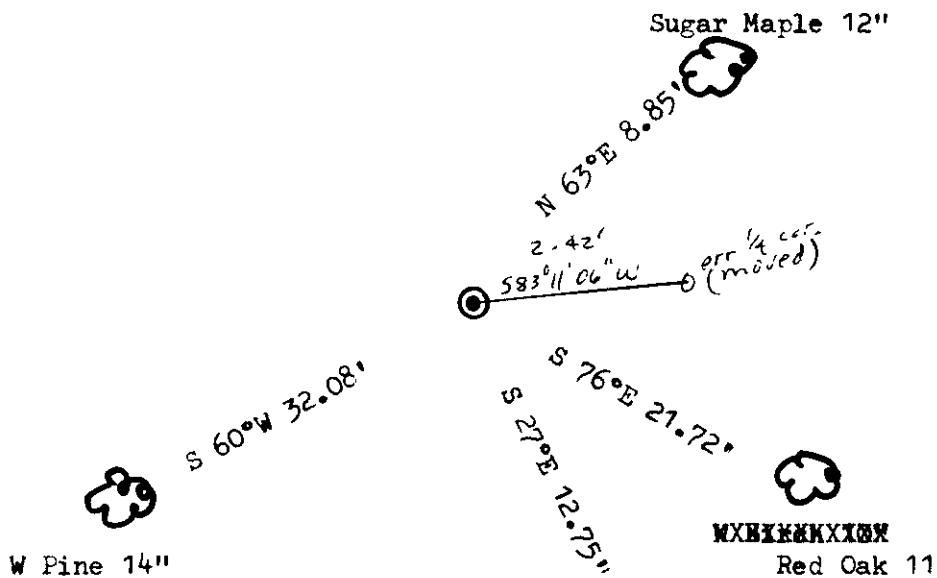
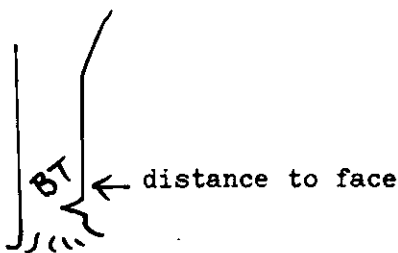

(i) I, Marvin E. Seymour
 (type or print name) certify that the corner location on this record was determined by me or under my direction and control and that this U.S. Public Land Survey Monument Record is correct and complete to the best of my knowledge and belief.

Marvin E. Seymour June 5, 1984
 Signature Date

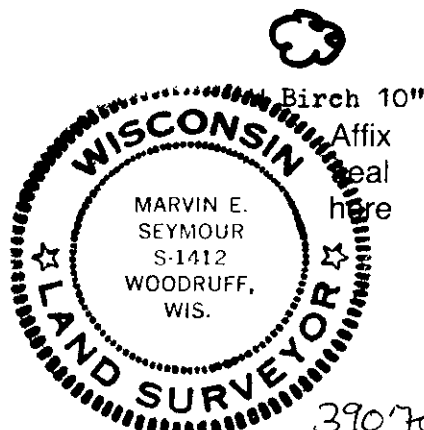

C-13