

U.S. PUBLIC LAND SURVEY MONUMENT RECORD

Note: This form is intended and designed to fulfill all requirements of Wisconsin Administrative Code, Chapter A-E 7.08 U.S. Public Land Survey Monument Record (3) (a) (b) (c) (d) (e) (f) (g) (h) (i). An additional sheet may be added if necessary to conform with said requirements.

(a) Corner location: Township 39 North Corner: North 1/4 Corner

Section 32 Range 8 East Original Surveyor: A. Anderson

Town/City/Village Newbold

Original B.T.'s: 10" Pw S12°E 40 lks
6" Pw N32°E 28 lks

County Oneida

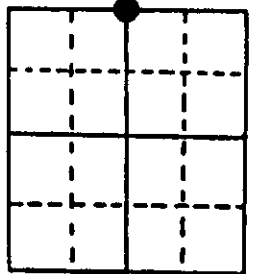

Original Survey Date: July 1863 ● Location

(b) (f) (g) (h) Description of monument found at this corner and if it was accepted, state all evidence (material, testimonial, occupational, plats, records, other monuments) used as a basis for accepting. If not accepted or if nothing was found, state evidence used as basis for establishing location. If reestablished through lost corner proportionate methods, indicate all monuments, distances and directions used to establish. Indicate type of monument found or set and sign post.

Found old 2" dia. iron pipe monument with uncapped top 25" above grade at this corner. I carefully removed the old iron pipe and replaced it with a new standard 2" dia. iron pipe monument, 48" long with stamped brass cap 25" above grade. I also set a standard white poly 'T' corner marker post 1' East of the corner monument. The corner is approximately 215' +/- South of the centerline of black top pavement for County Trunk Highway 'D'. All original GLO corner evidence is now obliterated or of unreliable condition. In 1938, Wisconsin Valley Improvement Corporation set a 2" iron pipe monument at this corner by section resurvey and marked new BTs, an 8" Oak N42°W 0.530 chains and a 6" Oak S21°W 0.273 chains, which were both found and used for new ties below. In 1976, Frederic Copp/WCD also found the 2" iron pipe at this corner and noted a BT 8" Oak S86°E 25.0' which he believed had been marked by Northwoods Surveyors of Minocqua, Wis. in about 1968, which I also found and used for new ties below. I left the old 2" dia. by 48" long iron pipe monument flat on grade next to new monument set. This recovery completed September 25, 1997; no witnesses.

(c) (d) (e) Plan view of corner with ties to at least 4 witness monuments. If in disagreement with previously established corner, show the distances between the two corners and also indicate the ties to the disputed corner.

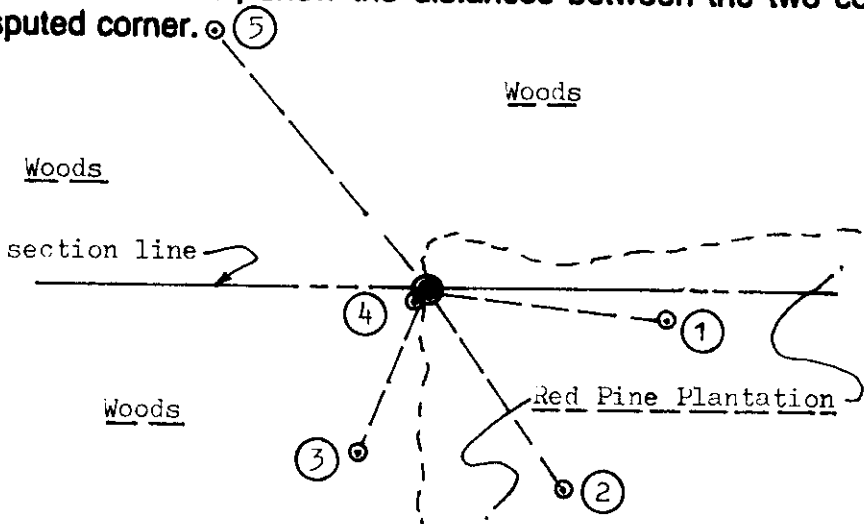

Witness Monument Ties:

- ① Record BT 10" Or with lower face blaze shut but plain at S83°E 25.01'/NW trunk of four.
- ② New BT 10" Pr S34°E 25.13'.
- ③ Record BT 18" Or with no marks visible, S25°W 18.24' to a PK nail & washer in left face.
- ④ New BT 8" Or S40°W 1.46' with a standard aluminum WCD location poster found on upper NE face.
- ⑤ Record BT 14" Or with lower face scar plain N40°W 35.53'.

Scale: 1" = 20'

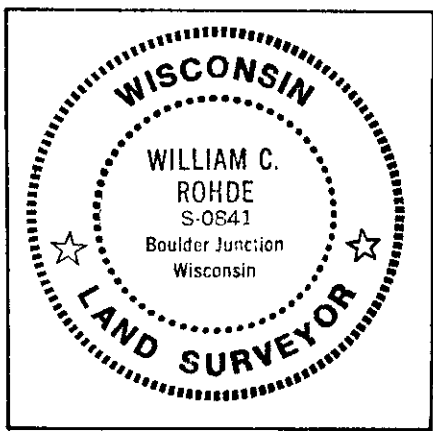

Index No. V 7

Unless otherwise indicated, all BT witness monument ties are to a 1/4" dia. by 2.5" long PK nail with 1.25" dia. steel washer set in unblazed right face bark; and a PK nail with 2" dia. steel washer stamped BT also set in unblazed front face bark of each BT at DBH. All previous corner recovery notes from Wisconsin DNR and/or Oneida County survey records.

(i) I, William C. Rohde, RLS 841
(type or print name) certify that the corner location on this record was determined by me or under my direction and control and that this U.S. Public Land Survey Monument Record is correct and complete to the best of my knowledge and belief.

William C. Rohde 9-30-97
Signature Date

3908290020