

**U.S. PUBLIC LAND SURVEY MONUMENT RECORD**

Note: This form is intended and designed to fulfill all requirements of Wisconsin Administrative Code, Chapter A-E 7.08 U.S. Public Land Survey Monument Record (3)(a-i).

(a) CORNER LOCATION  
1/4 Cor. of Secs. 3 & 34  
Township 38 & 39 North  
Range 9 East of the 4th P.M.  
Town of Sugar Camp  
County of Oneida

WISCRS - Oneida County  
N: 230,558.56 USft  
E: 279,049.27 USft  
Datum: NAD83(2011)  
GNSS Method: RTN - Direct  
GNSS Control: WISCORS VRS

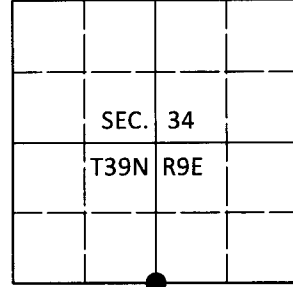

(b) HISTORY OF ORIGINAL CORNER ESTABLISHMENT

Original Surveyor: Hiram C. Fellows

Original Accessories:

Date of Survey    Commenced: July, 1859  
                          Completed: July, 1859

tamarack 10" North, 11 lks.  
tamarack 10" S56°W, 20 lks.

(b)(f)(g)(h) Description of monument found at this corner and if it was accepted, state all evidence (material, testimonial, occupational, plats, records, other monuments) used as a basis for accepting. If not accepted or if nothing was found, state evidence used as basis for establishing location. If re-established through lost corner proportionate methods, indicate all monuments, distances and directions used to establish. Indicate type of monument and sign post found or set.

Oct. 7, 2014: On OCS Map No. C-2834, Gregory S. Maines, PLS identifies corner as Oneida Co. aluminum monument, found.

July 8, 2019: I found and accepted the record monument, a 2.4" diam. aluminum pipe with an unmarked 3.3" diam. Oneida Co. aluminum cap 2" beneath the water surface. A high 1.8" diam. iron pipe is North and adjacent to the monument. As the corner is located in a knee-deep marsh, I was unable to establish accessories a reasonable distance from the corner. I found two white vinyl sign posts adjacent to the monument.

The coordinate value shown has been verified by at least one of the following methods: 1) comparison to a previously GPS determined published value; 2) the value is the average of two or more GPS observations at a markedly different time; 3) one or more distances were measured back to the GPS observed corner from temporary GPS observed offset locations.

(c)(d)(e) Plan view of corner with ties to at least 4 witness monuments. If in disagreement with previously established corner, show the distances between the two corners and also indicate the ties to the disputed.

REGISTER OF DEEDS OFFICE  
ONEIDA COUNTY  
FILED

AUG 28 2019

KYLE J. FRANSON  
REGISTER OF DEEDS

(i) I, Jeffrey W. Austin, Professional Land Surveyor No. S-1885, hereby certify that the corner location on this record was determined by me or under my direction and control and that this U.S. Public Land Survey Monument Record is correct and complete to the best of my knowledge and belief.

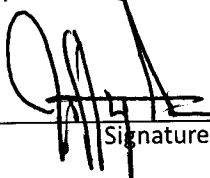

  
Signature

AUG. 2, 2019  
Date