

COPY from Vilas Cty

U. S. PUBLIC LAND SURVEY MONUMENT RECORD

Note: This form is intended and designed to fulfill all requirements of Wisconsin Administrative Code, Chapter A-6 7.08 U.S. Public Land Survey Monument Record (3)(a)(b)(c)(d)(e)(f)(g)(h)(i). An additional sheet may be added if necessary to conform with said requirements.

(a) CORNER LOCATION: State Plane Coordinates
 Southeast corner of Sec. 16 X N/A
 Township 39 North Y N/A
 Range 10 East Datum Base None
 Town/City Lincoln County of Vilas

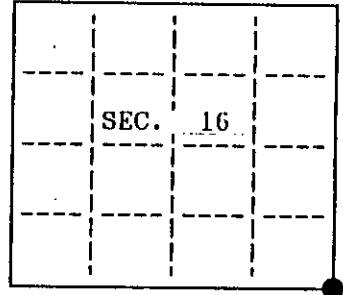

(b) HISTORY OF ORIGINAL CORNER ESTABLISHMENT
 Original Surveyor: William E. Daugherty
 Date of Survey: Commenced Sept. 30, 1863
 Completed Oct. 7, 1863

Original B.T.'S
 10" Hemlock S 72° E 13 lks.
 10" Aspen N 22° W 13 lks.

(b)(f)(g)(h) Description of monument found at this corner and if it was accepted, state all evidence (material, testimonial, occupational, plats, records, other monuments) used as a basis for accepting. If not accepted or if nothing was found, state evidence used as basis for establishing location. If reestablished through lost corner proportionate methods, indicate all monuments, distances and directions used to establish. Indicate type of monument and sign post found or set.

March 22, 1994: I, Thomas A. Boettcher found the Ripco 1-1/2" iron pipe with a 4" x 4" brass plate top extending 1.5' above the ground. an 8" x 8" concrete monument is next to the Ripco monument and bears Northwest 0.4'. Found one bearing tree and made three new bearing trees as listed below. I set a plastic sign post 1.0' Northeast of the corner.

(c)(d)(e) Plan view of corner with ties to at least 4 witness monuments. If in disagreement with previously established corner, show the distances between the two corners and also indicate the ties to the disputed.

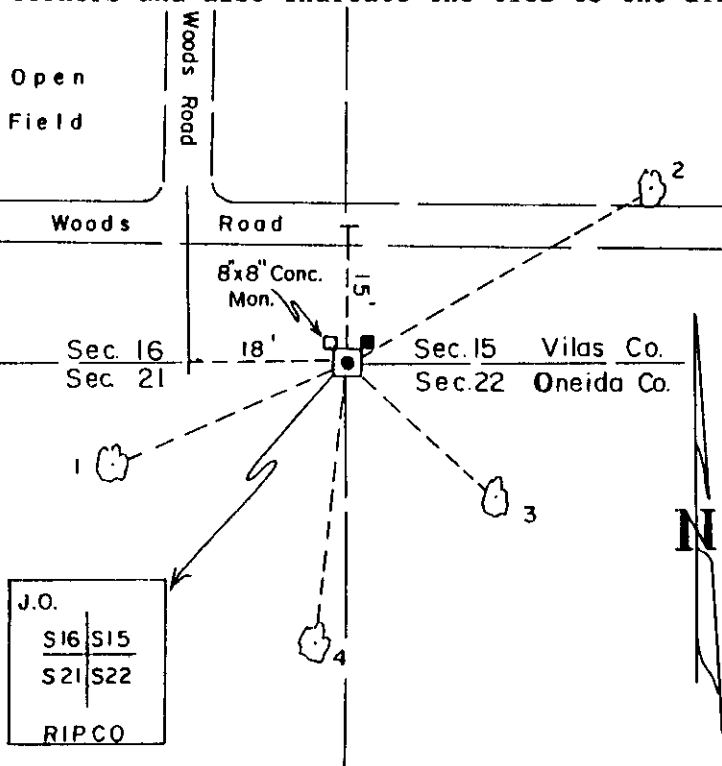

Bearing Tree found measured to a nail in the side:
 1) 9" Maple S 67° W 26.33'

Bearing Trees made measured to a nail in the side:
 2) 12" W. Pine N 60° E 36.37'
 3) 8" Hemlock S 46° E 20.85'
 4) 6" Hemlock S 7° W 29.38'

SCALE: 1" = 20'

- Ripco Iron pipe with brass plate top found
- Bearing Tree Measured to a Nail in the side
- Plastic witness sign post set

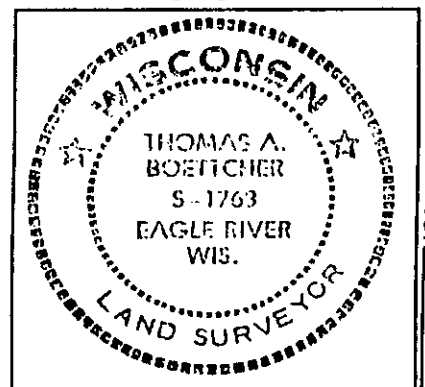

INDEX NO. N-13

(i) I, Thomas A. Boettcher hereby certify that the corner location on this record was determined by me or under my direction and control and that this U.S. Public Land Survey Monument Record is correct and complete to the best of my knowledge and belief.

Thomas A. Boettcher Signature 3-31-94 Date

3910160000