

U.S. PUBLIC LAND SURVEY MONUMENT RECORD

Note: This form is intended and designed to fulfill all requirements of Wisconsin Administrative Code, Chapter A-E 7.08 U.S. Public Land Survey Monument Record (3) (a) (b) (c) (d) (e) (f) (g) (h) (i). An additional sheet may be added if necessary to conform with said requirements.

(a) Corner location: Township 39 North
Range 11 East/West
Town/City/Village THREE LAKES
County ONEIDA

REGISTER OF DEEDS OFFICE
ONEIDA COUNTY, WIS.
FILED
JAN 18 1999
At O'Clock
THOMAS H. LEIGHTO
REGISTER OF DEEDS

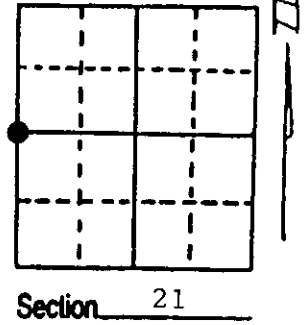

(b) (f) (g) (h) Description of monument found at this corner and if it was accepted, state all evidence (material, testimonial, occupational, plats, records, other monuments) used as a basis for accepting. If not accepted or if nothing was found, state evidence used as basis for establishing location. If reestablished through lost corner proportionate methods, indicate all monuments, distances and directions used to establish. Indicate type of monument found or set and sign post.

1859- DAUGHERTY SET WOOD POST.
ORIGINAL B.T.'s 12" HEMLOCK N 34° W 11 lks.
 10" BIRCH S 11° E 9 lks.

1974- BANDOW ACCEPTS IRON PIPE AT CORNER POSITION AND MAKES NEW B.T.'s HE ALSO NOTES TO A FOUND B.T STUMP 36" S 67° W 34.10'.
NEW B.T.s 16" MAPLE N 69° E 25.80'.
 16" MAPLE N 5° E 32.20'.

FOUND BANDOWS' IRON PIPE AT POSITION. FOUND REMAINS OF STUMP AT POSITION CALLED FOR BY BANDOW. FOUND MAPLE B.T. REPLACED IRON PIPE WITH 2½" X 36" ONEIDA COUNTY ALUMINUM CAPPED MONUMENT STAMPED TO IDENTIFY CORNER. SET PLASTIC PADDLE 2' NE OF CORNER. MADE NEW B.T.s.

(c) (d) (e) Plan view of corner with ties to at least 4 witness monuments. If in disagreement with previously established corner, show the distances between the two corners and also indicate the ties to the disputed corner.

NOTE: ALL MEASUREMENTS ARE TO ALUMINUM NAIL IN SIDE OF TREE.

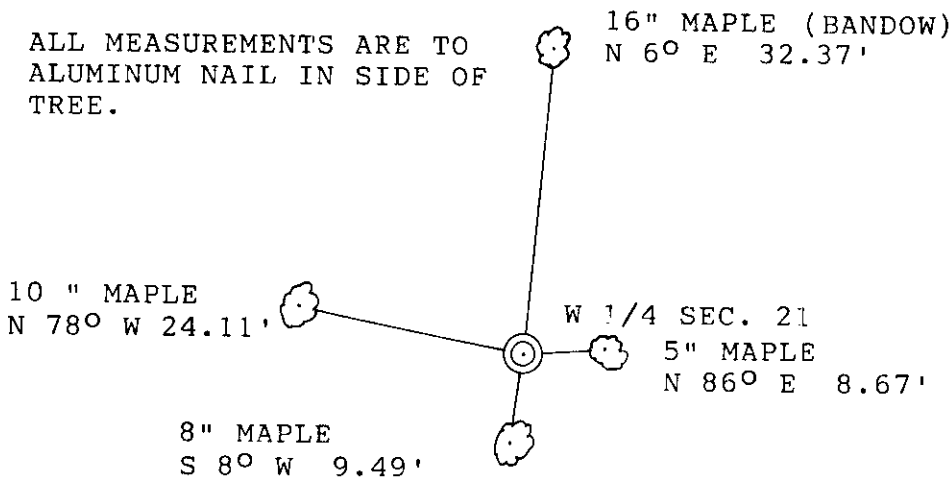

(i) I, KIP W. SODER S-1731
(type or print name) certify that the corner location on this record was determined by me or under my direction and control and that this U.S. Public Land Survey Monument Record is correct and complete to the best of my knowledge and belief.

Kip W. Soder Jan. 11, 1999
Signature Date



3911202000
Stamp

Index No. P-9