

Stock No. 26273

U.S. PUBLIC LAND SURVEY MONUMENT RECORD

Index No. P 13

State of Wisconsin

County of Oneida

ss.

I, John H. Fisher, do hereby certify that on the 26 day of April 1984, I found evidence of the one quarter corner of Section 21 & 22 Township 39 North, Range 11 East, Fourth Principal Meridian, as described hereon; and that from this evidence I established a new monument and accessories as described hereon to perpetuate the original location of this corner.

Resident witnesses:

None

History of original corner establishment. Original survey in k859 be William E. Daugherty. Dependent Resurvey in 1941 by Hugh B. Crawford at 39.19 chains set an iron post 3 feet long, 2 inches in diameter, 27 inches in ground with brass tablet stamped. From which the following bear:

Poplar	5"	N73-3/4°W	27-1/2 lks.
Poplar	4"	S72-1/2°E	38 lks.
	1941		

Description of corner evidence found:

B.I.M. Monument as described and in place; and the following bearing tree.

White Birch	6"	S29°W	21.8 feet
Wood sign post		NE	1 foot

Description of monument and accessories I established to perpetuate the original location of this corner.

Corner in good condition;

Blazed and scribed the following new bearing trees

Set nail in:

Red Maple	8"	S23°E	48.8 feet
White Birch	7"	N66°W	17.9 feet
Red Maple	7"	N 2°W	27.9 feet

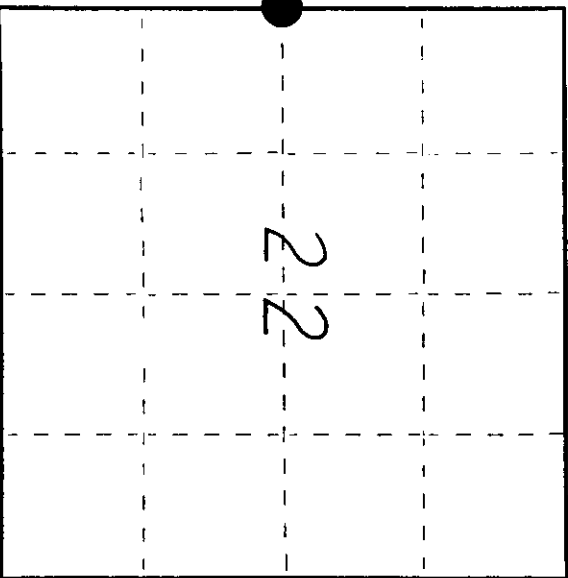

O = Corner monument restored.

Dated at Minocqua, Wis., this 11th day of February, 1985

Signature: John H. Fisher Title: Registered Land Surveyor Registration No. S-836 (County Surveyor, Registered Land Surveyor, or other duly authorized official)

Office of Register of Deeds, County of Oneida. I hereby certify that the within instrument was filed in this office for record on the 14th day of February, 1985 at 4:15 o'clock P.M.

Done George Fuchs (Register of Deeds)

By: Deputy

3911212000

(e) Describe any material discrepancy between the location of the corner as restored or reestablished and the location of that corner as previously restored or reestablished by distance and direction. Show the discrepancy on the plan view drawing under (d), above. Show the distances between the corner as previously restored or reestablished and (1) the corner as restored or reestablished, and (2) to at least 2 of the witness monuments shown on the drawing in (d), above.

See drawing below

(f) Was the corner restored through acceptance of (1) an obliterated evidence location, or, (2) a found perpetuated location?

Found perpetuated location

(g&h) Was the corner reestablished through lost corner proportionate methods? If so, show the method, including the directions and distances to other public land survey corners used as evidence or used for proportioning in determining the corner location?

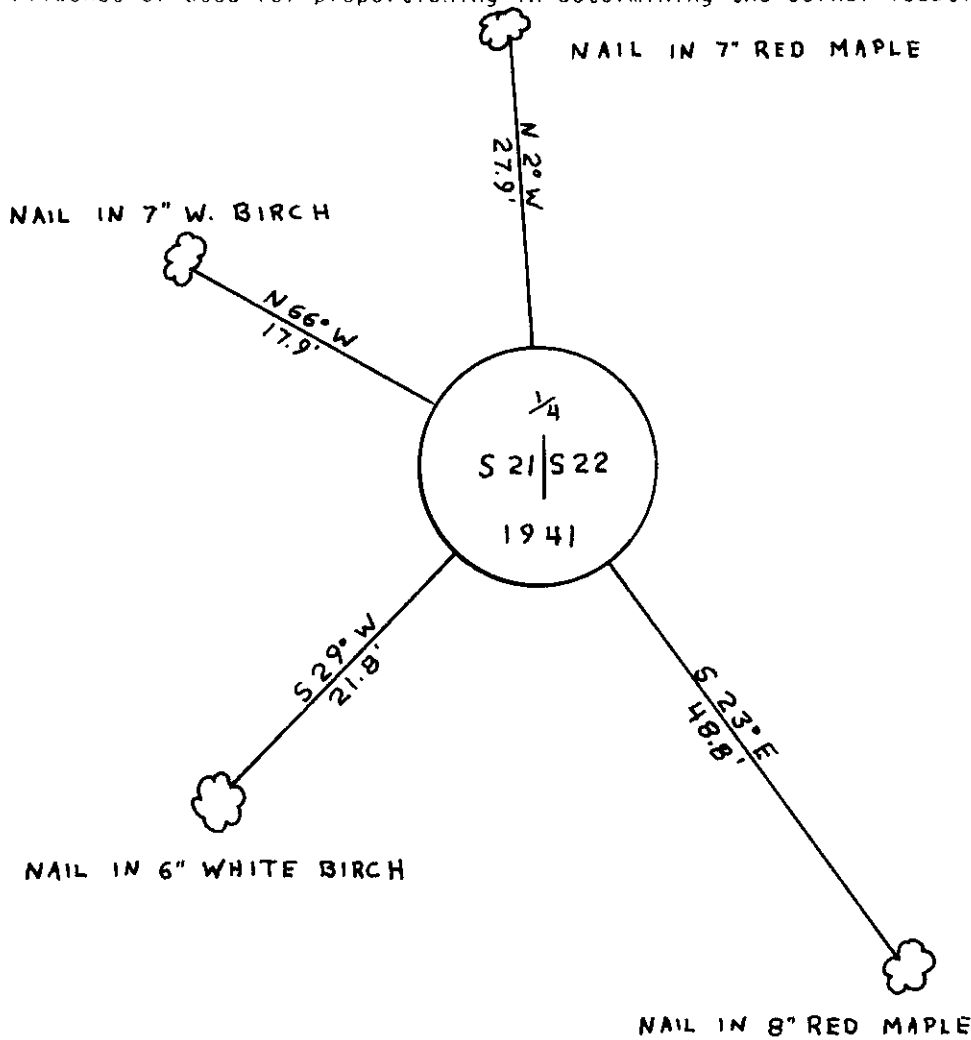

Affix Land Surveyor Seal

(1) I, John H. Fisher
 (Type or print name; certify that the corner location shown on this record was determined by me or under my direction and control and that this U.S. Public Land Survey Monument Record is correct and complete to the best of my knowledge and belief.)

John H. Fisher Signature 7/11/85 Date