

PART OF THE NW 1/4 OF THE NE 1/4, SEC. 23, T. 38 N., R. 9 E, TOWN OF SUGARCAMP, ONEIDA COUNTY, WI.

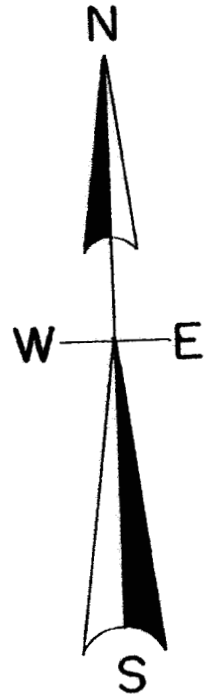

North is referenced to the East line of the NW - NE 1/4 being a recorded bearing of S 4° 06' 05" E.

SEC. COR.
14 13
23 24

KING ROAD

MAP #	A3439 ✓
DATE	10-5-2018
BY	SC
DESCRIBE	
ONEIDA CO. SURVEYOR'S OFFICE	

SU 307

SU 306-1

SU 306-2

SU 306

PARCEL -A-
2,209 SQ.FT.

S 85° 39' 11" W 47.00'
N 85° 39' 11" E 182.35' (N 85° 39' 11" E 132.35')

S 84° 14' 03" W 1332.75'
N 85° 39' 11" E 182.36' (N 85° 39' 11" E 132.35')

S 45° 55' E 104.91'
N 4° 06' 05" W 94.00'

(364.70')
270.70'

(S 4° 06' 05" E)

LEGEND

- SUBDIVISIONAL MONUMENT OF RECORD
SEE U.S.P.L.S. SHEETS
- FOUND RAILROAD SPIKE
- FOUND 1" IRON PIPE
- SET 1" IRON PIPE

(0.00') BEARING & DISTANCE OF RECORD

SCALE

1" = 50'

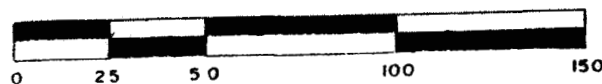

NOTE- Parcel -A- was created to take in the driveway encroachment area. Parcel -A- is to be attached to Parcel SU 306-1 and not to be sold as a separate entity.

I, Todd Loftus, Professional Land Surveyor, hereby certify, that I have surveyed the property shown hereon. That this map represents an accurate survey of said property to the best of my knowledge & belief. That I have performed this survey by order of Bonnie Sortek and that I have complied with the applicable requirements of the Wisconsin Administrative Code A.E.7.

DATE July 19, 2018

SIGNED Todd Loftus

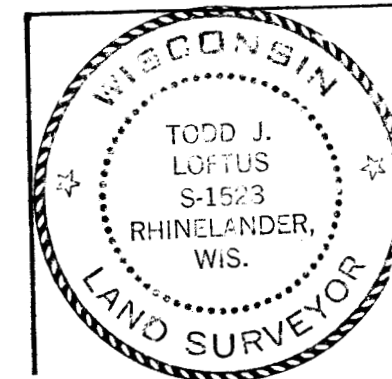

Survey for Bonnie L. Sortek
4085 King Road
Rhineland, WI. 54501

LOFTUS SURVEYING
860 BALSAM STREET
RHINELANDER, WI. 54501
TEL/FAX 715-369-1142
hodag28@hotmail.com

2001B7