

# PLAT OF SURVEY

## PARCEL -A-

LOCATED IN PART OF THE NE 1/4 OF THE NW 1/4, SEC. 30,  
T. 37 N., R. 10 E., TOWN OF STELLA,  
ONEIDA COUNTY, WI.

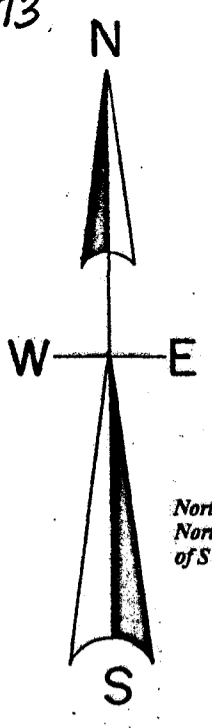

North is referenced to the East line of the Northwest 1/4 being an assumed bearing of S 0° 31' 12" W.

MOENS LAKE DR.

CENTER LINE SPRING DRIVE

**PARCEL -A-**  
2.3928 ACRES  
104,233 SQ.FT.

CENTER LINE CANADIAN NATIONAL RAILROAD

CENTER LINE MOENS LAKE DR.

### LEGEND

- SUBDIVISIONAL MONUMENT OF RECORD
- SET 1" IRON PIPE

### SCALE

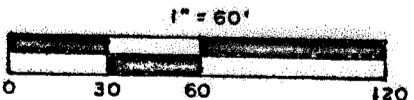

MAP # A3473 ✓  
 DATE FILED 2-25-2019  
 BY SC  
 DESCRIPTION FILED.....  
 ONEIDA CO. SURVEYOR'S OFFICE

I, Todd Loftus, Professional Land Surveyor, hereby certify, that I have surveyed the property shown hereon. That this map represents an accurate survey of said property to the best of my knowledge & belief. That I have performed this survey by order of Jill Rassbach and that I have complied with the applicable requirements of the Wisconsin Administrative Code A.E.7.

DATE Dec. 31, 2018

SIGNED Todd Loftus

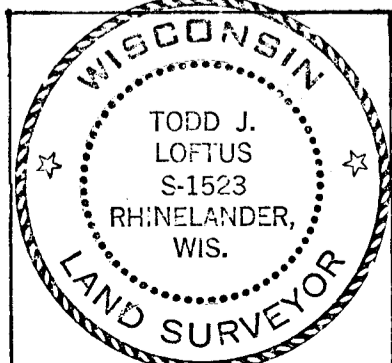

survey for Jill Rassbach  
3602 Moens Lake Dr.  
Rhinelander, WI. 54501

LOFTUS SURVEYING  
860 BALSAM STREET  
RHINELANDER, WI. 54501  
TEL/FAX 715-369-1142  
hodag28@hotmail.com

2021B7 A3473