

Part of
 Government Lot 2
 SECTION 27, TOWNSHIP 39 NORTH, RANGE 6 EAST
 Town of Minocqua, Oneida County, Wisconsin

CURVE DATA

CURVE	RADIUS	ARC LENGTH	CHORD LENGTH	CHORD BEARING
C1	76.86'	73.97'	71.15'	S 22°55'30" E
C2	76.86'	59.56'	58.08'	S 72°41'48" E
C1+C2	76.86'	133.53'	117.36'	S 45°07'33" E
C3	457.14'	97.14'	96.95'	S 88°47'47" E
C4	457.14'	9.73'	9.73'	S 82°05'58" E
C3+C4	457.14'	106.87'	106.62'	S 88°11'12" E
C5	76.86'	24.89'	24.78'	S 72°11'21" E

Quarter Corner
 Oneida County Aluminum Monument
 Found in place

Section Corner
 Oneida County Aluminum Monument
 Found in place

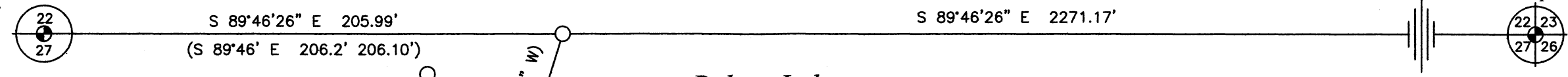

- NOTES**
- 1) IRON PIPE DIAMETERS GIVEN ARE OUTSIDE DIAMETERS.
 - 2) IT IS NOT THE INTENT OF THIS SURVEY MAP TO SHOW ALL EASEMENTS.
 - 3) THE ORDINARY HIGH WATER MARK (OHWM) SHOWN HEREON IS FOR REFERENCE ONLY AND IS APPROXIMATE. ANY LAND BELOW THE OHWM OF A LAKE OR NAVIGABLE STREAM IS SUBJECT TO THE PUBLIC TRUST IN NAVIGABLE WATERS THAT IS ESTABLISHED UNDER ARTICLE IX, SECTION 1 OF THE STATE CONSTITUTION.
 - 4) BOLGER LAKE ROAD IS SHOWN PER MAP NUMBER C3023 FILED IN THE ONEIDA COUNTY LAND INFORMATION OFFICE.
 - 5) THE DESCRIPTION FOR THIS PARCEL WAS PROVIDED ON A SEPARATE SHEET.

SHORT LINE DATA

L1	- N 62°55'50" W	24.67'
L2	- N 85°04'41" E	44.38'
	(S 89°01'29" W	44.47')

- LEGEND**
- - 1.050" Iron Pipe Found
 - ⊙ - 1.660" Iron Pipe Found
 - ⊗ - 1.900" Iron Pipe Found
 - ⊕ - Survey Marker Nail Found
 - ⊙ - 1.900" Iron Pipe Set
 - - 0.750" Iron Bar Set
 - ▲ - Calculated Point (not monumented)
 - ⊖ - Well
 - ⊕ - Septic Tank
 - ⊖ - Sewer Vent
 - ⊗ - Utility Pole
 - (...) - Recorded as values

RECEIVED & FILED # **A4222**
 Oneida County Surveyor's Office
 Date **6-27-2024**
 By **CH**
 OCS Area #.....

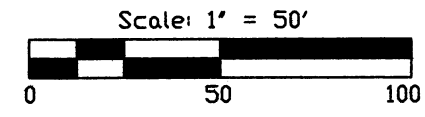

ASSUMED NORTH
 Based on the north line of the section
 which bears South 89° 46' 26" East

SURVEYOR'S CERTIFICATE
 I, Benton A. McMullen, Wisconsin Professional Land Surveyor # S-2555, do hereby certify that I have surveyed and mapped the property shown hereon, and that I have complied with the applicable requirement of the Wisconsin Administrative Code Chapter A-E 7, and that this map represents a true and accurate survey of said property to the best of my knowledge and belief.

Area
 22,617 Square Feet
 0.52 Acres
 More or less

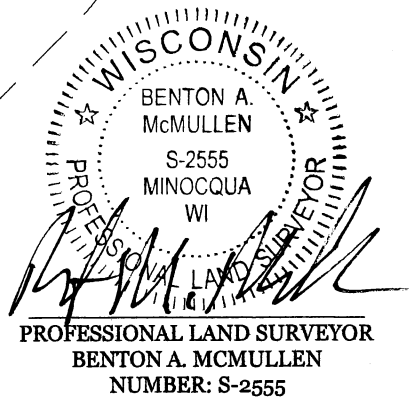

FIELD SURVEY WORK COMPLETED ON
 THE 1st DAY OF November, 2022

MCMULLEN & ASSOCIATES, INCORPORATED
 "Your true north surveyors and soil testers"
 PO BOX 51, MINOCQUA, WISCONSIN 54548
 TELEPHONE (715) 356-3011

This survey was performed under the order of: Cindy Cyra

REVISED: December 27, 2023 - Job No. 224001
 Set iron bars along the west line. Wire fence encroachment was removed.

"CYRA SURVEY"		
DRAFTED BY: Benton A. McMullen	DATE: December 8, 2022	
SCALE: 1" = 50'	JOB NO: 222039	SHEET 1 OF 1 SHEETS