

Oneida County
Grid North

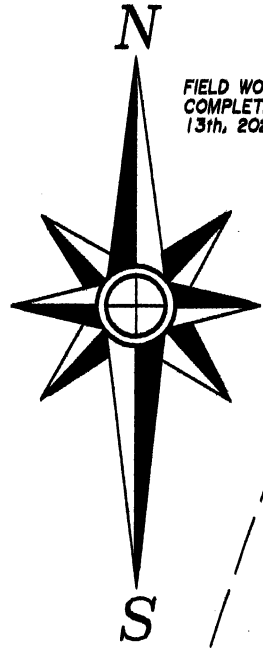

FIELD WORK WAS
COMPLETED ON MAY
13th, 2024.

W Frontier Circle

-81-

(N 89°46'08"E 321.83')
(S 89°36'08"E 322.21')

-82-

36,403 Sq.Ft.
0.84 Acres

S 89°37'12"E 369.65'
(N 89°46'08"E 369.79')

-83-

42,734 Sq.Ft.
0.98 Acres

S 89°37'56"E 405.34'
(N 89°46'08"E 405.43')

-84-

39,896 Sq.Ft.
0.92 Acres

N 87°09'52"W 424.53'
(N 87°46'04"W 424.60')

-51-

-52-

Lots 82, 83 and 84 of the Plat of Buffalo Acres

And Located in the
NE1/4-NE1/4, Section 13
T 39 N, R 7 E
Town of Woodruff
Oneida County, Wisconsin

Scale: 1" = 50'



-Surveyor's Certificate-

"I HEREBY CERTIFY, THAT I HAVE SURVEYED AND MAPPED
THE LANDS SHOWN HEREON AND THAT, TO THE BEST OF
MY KNOWLEDGE AND BELIEF, THIS SURVEY AND MAP IS A
TRUE AND CORRECT REPRESENTATION THEREOF, AND THAT
I HAVE COMPLIED WITH THE APPLICABLE REQUIREMENTS
OF CHAPTER A-E 7 OF THE WISCONSIN ADMINISTRATIVE
CODE'S MINIMUM STANDARDS FOR PROPERTY SURVEYS."

DATED THIS 14th DAY OF MAY, 2024.

Thomas A. Boettcher
THOMAS A. BOETTCHER, P.L.S. #1763

-Legend-

- ⊕ 2" IRON PIPE FOUND IN PLACE
- 1" IRON PIPE FOUND IN PLACE
- () BEARING & DISTANCE OF RECORD

RECEIVED & FILED # **A4229**
Oneida County Surveyor's Office
Date: **7-3-2024**
By: **CH**
OCS Area #

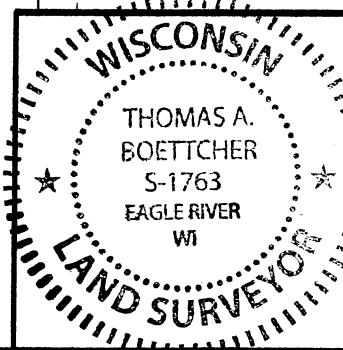

Survey For
Wirth Builders, LLC
P.O. Box 363
St. Germain, WI 54558

SCALE: 1" = 50' DATE: 5/14/2024 DWN. BY: TAB

Drawing No. **E5019** Eagle Landmark Surveying Inc.
5035 Hwy. 70 West, Eagle River, WI 54521
P&F (715)479-9610 survey@eaglelandmark.com