

Arbor Vitae, WI 54568
Phone 715.356.9485

Eagle River, WI 54521
Phone 715.479.2570

www.mainesandassociates.com

PREPARED FOR:

Jean Eiden

Part of the
SW 1/4 - NW 1/4 & NE 1/4 - NW 1/4
Section 29, T 38 N, R 11 E
 Town of Three Lakes
 Oneida County, Wisconsin

MAP #: 2024041
 DRAWN BY: CJH
 DATE: 02/27/2024

SHEET 1 OF 1

MAP # **B8510**
 DATE FILED: **5-28-2024**
 BY: **CH**
 DESCRIPTION FILED:
 ONEIDA CO. SURVEYOR'S OFFICE

U.S. Highway "45"

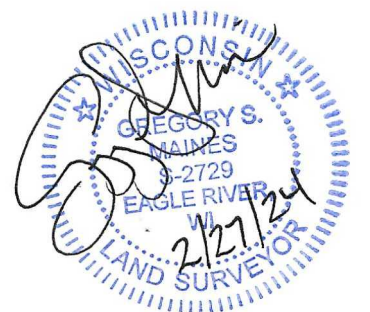

Surveyors Certificate

I hereby certify that I have surveyed the property lines shown hereon; that this map represents an accurate survey of said property lines to the best of my knowledge and belief; and that I have complied with the applicable requirements of the Wisconsin Administrative Code Section A-E 7.

Notes:

- This survey was done without the benefit of a title commitment, there may or may not be easements of record that benefit or burden the subject property.
- Fieldwork was completed on February 26, 2024.

Oneida County Grid Bearings:
 Referenced to the west line of the
 SW 1/4 - NW 1/4 of Section 29
 as bearing N04°43'28"W

⊗ 1" dia. iron pipe found
 () Bearing or distance of record

Scale 1" = 150'

Oneida County aluminum monument found (U.S.P.L.S. Record prepared)

Swamp Mist Rd.