

MAP # **B8528**  
 DATE FILED: **9-20-2024**  
 BY: **CH**  
 DESCRIPTION FILED:  
**ONEIDA CO. SURVEYOR'S OFFICE**

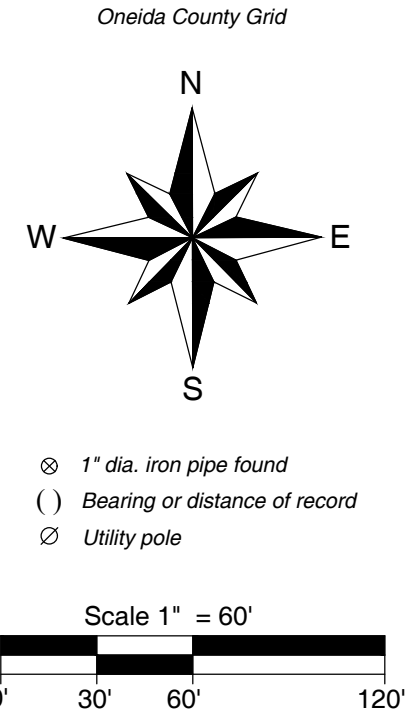

**Surveyors Certificate**  
 I hereby certify that I have surveyed the property shown hereon; that this map represents an accurate survey of said property to the best of my knowledge and belief; and that I have complied with the applicable requirements of the Wisconsin Administrative Code Section A-E 7.

- Notes:**
1. This survey was done without the benefit of a title commitment, there may or may not be easements of record that benefit or burden the subject property.
  2. Fieldwork was completed on May 1, 2024.

**Record Legal Description**  
 A parcel of land in the NE 1/4 of the NE 1/4, Section 19, Township 39 North, Range 9 East, Town of Sugar Camp, Oneida County, Wisconsin, more particularly described as follows:  
 Commencing at the northwest corner of Lot 1 of the recorded Plat of Boardwalk Park, marked by an iron rod on the easterly right of way line of Prairie Road; thence N. 0° 27' 46\"/>

Arbor Vitae, WI 54568  
 Phone 715.356.9485  
 Eagle River, WI 54521  
 Phone 715.479.2570  
 www.mainesandassociates.com

**MAINES & ASSOCIATES**  
 Land Surveyors

PREPARED FOR:  
 Kevin T. & Sangin  
 Anderson

Part of the  
 NE 1/4 of the NE 1/4 of  
 Section 19, T 39 N, R 9 E  
 Town of Sugar Camp  
 Oneida County, Wisconsin

MAP #: 2024133  
 DRAWN BY: CJH  
 DATE: 08/19/2024  
 SHEET 1 OF 1