

Line Table		
Line #	Length	Direction
L1	125.00'	N71° 43' 00"W
L2	115.00'	S86° 31' 09"W
L3	75.00'	S73° 09' 45"W

Curve Table					
Curve #	Length	Radius	Chord Bearing	Chord Length	Delta
C1	225.53'	290.00'	N83°03'24"E	219.88'	044°33'29"
C2	46.02'	975.00'	S73°18'43"E	46.02'	002°42'16"
C3	269.86'	725.00'	S82°37'23"E	268.31'	021°19'37"
C4	126.01'	2275.00'	N88°18'01"E	126.00'	003°10'25"

Vol. 64, Pg. 118

Vol. 285, Pg. 101

Position per Oneida County published coordinate.

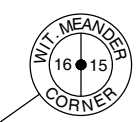

Arbor Vitae, WI 54568
 Phone 715.356.9485
 Eagle River, WI 54521
 Phone 715.479.2570
 www.mainesandassociates.com

MAP # **B8533**
 DATE FILED: **10-28-2024**
 BY: **CH**
 DESCRIPTION FILED:
 ONEIDA CO. SURVEYOR'S OFFICE

Oneida County Grid Bearings:
 Referenced to the east line of Doc.
 No. 613147 as bearing S00°37'59"W

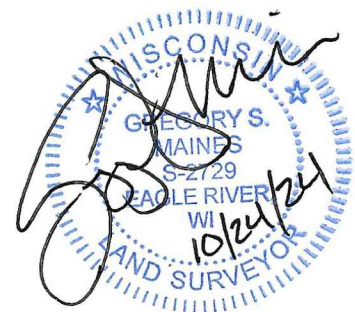
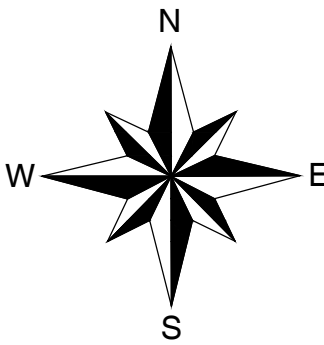

- △ Computed position
- 1" dia. iron pipe set
- ⊙ 1" dia. iron pipe found
- 1-1/2" dia. iron pipe found
- () Bearing or distance of record
- ⊗ Septic
- ⊕ Utility pole
- ⊞ Electrical pedestal

Scale 1" = 60'
 0' 30' 60' 120'

I hereby certify that I have surveyed the property shown herein; that this map represents an accurate survey of said property to the best of my knowledge and belief; and that I have complied with the applicable requirements of the Wisconsin Administrative Code Section A-E 7.

Notes:

- This survey was done without the benefit of a title commitment, there may or may not be easements of record that benefit or burden the subject property.
- Fieldwork was completed on July 23, 2024.

Record Legal Description:

All that part of Government Lot 1 in Section 16, Township 39 North, Range 5 East, lying south of Squirrel Lake Road and West of a line described as follows:
 Beginning on the South line of the Squirrel Lake Road a distance of 468 feet Westerly along the Road from the East line of Government Lot 1; thence South to an oak post and iron pipe located 25 feet South of the center line of said road and witnessed by a Norway Pine 12 Inches In diameter, bearing South 5° E, and 18.5 feet distant; thence South parallel with the East line of Government Lot 1 a distance of 495.8 feet to a post and iron pipe, witnessed by a Norway Pine 14 Inches in diameter bearing North 46° West 18.5 feet distant; Thence continuing south to the lake shore of Franklin Lake. It being the intention to convey a parcel of land lying and being between the South side of the Squirrel Lake Road and the North shore of Franklin Lake.
 Except that part conveyed for road in Vol. 285 of Deeds on page 101. Being in Oneida County, Wisconsin.

Doc. No. 613147

Parcel ID: M1-1784-2
 2.14 acres ±
 Privy

Doc. No. 654090

PREPARED FOR:
 Michael C. Vogl, Andrew J. Vogl, Sara E. Jonas and Ann K. Vogl as joint equal tenants in 1/2 interest;
 Also
 Lucy E. Heinen, Ruth F. Wierschem, Mary Ann Vogl, Therese M. Vogl and Daniel M. Vogl as joint equal tenants in 1/2 interest.

Part of
 Government Lot 1
 Section 16, T 39 N, R 5 E
 Town of Minocqua
 Oneida County, Wisconsin

MAP #: 2024242
 DRAWN BY: LWV
 DATE: 10/24/2024
 SHEET 1 OF 1