

Part of
**GOV'T. LOT 4
SECTION 22, T39N, R6E**
Minocqua Township
Oneida County, Wisconsin
SURVEYOR'S CERTIFICATE

I, James D. Rein, Registered Land Surveyor No. S-1234, hereby certify that I have surveyed the property shown hereon; that this map represents an accurate survey of said property to the best of my knowledge and belief; that I have performed this survey by order of John H. Fisher; and that I have complied with the requirements of Wisconsin Administrative Code A-E 7.

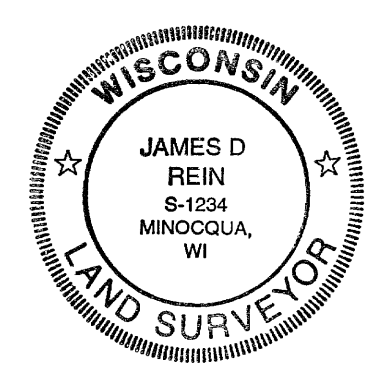

**WILDERNESS
SURVEYING, INC.**
[Signature]
Registered Land Surveyor S-1234
Dated this 17th day of June, 1996

TITLE CERTIFICATE
I hereby certify that I have surveyed the hereon described property and that the above map is a true representation thereof and shows the size and location of the property, its exterior boundaries, the location of all visible structures and dimensions of all principal buildings thereon, boundary fences, apparent easements, roadways and visible encroachments, if any.
This survey is made for the use of the present owners of the property, and also those who purchase, mortgage, or guarantee the title thereto within one (1) year from date hereof.

Bearing base assumed, referenced by the east line of Gov't. Lot 4 bearing N4°16'12"E

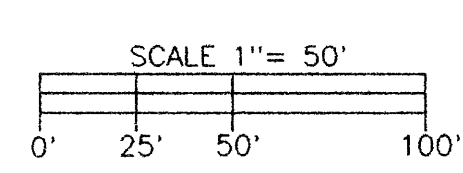

- LEGEND**
- ⊗ = 2" dia iron pipe found in place
 - ⊙ = 1 1/4" dia iron rod found in place
 - ⊙ = 1" dia iron rod found in place
 - ⊙ = 3/4" dia iron rod found in place
 - = Iron pipe set, 3/4" dia x 24" long
 - Δ = Corner postion not monumented by this survey
 - Other corner monuments are as noted

FISHER PARCEL

A parcel of land in Government Lot 4, Section 22, Township 39 North, Range 6 East, Minocqua Township, Oneida County, Wisconsin being the "FISHER" parcel shown on Map No. 96-78 by Wilderness Surveying, Inc., dated June 17th, 1996, more particularly described as follows:

Commencing at the quarter corner common to Sections 22 and 23, marked by a brass capped iron pipe, thence North 04 degrees 16 minutes 12 seconds East for a distance of 388.54 feet along the line common to Section 22 and 23 to intersect the north-easterly right of way line of Northern Road, thence along said northeasterly right of way line North 45 degrees 41 minutes 17 seconds West for a distance of 104.66 feet to the place of beginning, being the southwesterly corner of the RAINBOW BAY CONDOMINIUM PLAT, marked by an iron rod.

Thence continuing along said northeasterly right of way line North 45 degrees 41 minutes 17 seconds West for a distance of 252.77 feet to an iron rod, thence continuing along said northeasterly right of way line, along a curve to the left, having a radius of 385.13 feet and an arc length of 60.21 feet, being subtended by a chord of North 50 degrees 18 minutes 53 seconds West for a distance of 60.15 feet to an iron rod, thence continuing along said northeasterly right of way line North 54 degrees 36 minutes 36 seconds West for a distance of 174.07 feet to an iron rod, thence continuing along said northeasterly right of way line, along a curve to the right, having a radius of 174.84 feet and an arc length of 50.53 feet, being subtended by a chord of North 34 degrees 22 minutes 44 seconds West for a distance of 50.35 feet to an iron rod, thence continuing along said northeasterly right of way line North 25 degrees 54 minutes 44 seconds West for a distance of 123.44 feet to an iron pipe at the southwesterly corner of that parcel of land described in Volume 554 of Records, on pages 543 and 544, thence along the south line of that parcel of land described in Volume 554 of Records, on pages 543 and 544, North 50 degrees 24 minutes 37 seconds East for a distance of 118.83 feet to an iron rod, thence continuing along the south line of said parcel of land described in Volume 554 of Records, on pages 543 and 544, North 66 degrees 27 minutes 45 seconds East for a distance of 218.23 feet to an iron pipe near the southwesterly shore of Minocqua Lake, thence meandering along the lake South 58 degrees 18 minutes 58 seconds East for a distance of 159.93 feet to an iron rod on the westerly line of the RAINBOW BAY CONDOMINIUM PLAT, thence along the westerly line of the RAINBOW BAY CONDOMINIUM PLAT, South 44 degrees 59 minutes 12 seconds West for a distance of 45.70 feet to an iron rod, thence continuing along the westerly line of the RAINBOW BAY CONDOMINIUM PLAT, South 04 degrees 17 minutes 51 seconds West for a distance of 609.72 feet to the place of beginning.

The above lateral lot lines extend to the shore of Minocqua Lake, and include all lands lying between the meander line and ordinary high water mark of said lake.

Together with and subject to covenants, easements, and restrictions of record.

Said property contains 5.26 acres more or less.

Brass capped 2" dia iron pipe found in place. See USPLS Mon. Rec.

RAINBOW BAY
CONDOMINIUM PLAT
VOLUME 1 CONDOMINIUMS, PAGE 12