

LOCATED IN GOV'T LOT 5, SECTION 25, T 37 N, R 8 E,
TOWN OF PINE LAKE, ONEIDA COUNTY, WISCONSIN

MAP # C2063
DATE FILED.....
BY *js* JUN 1 11 2004
DESCRIPTION FILED.....
ONEIDA CO. SURVEYOR'S OFFICE

N

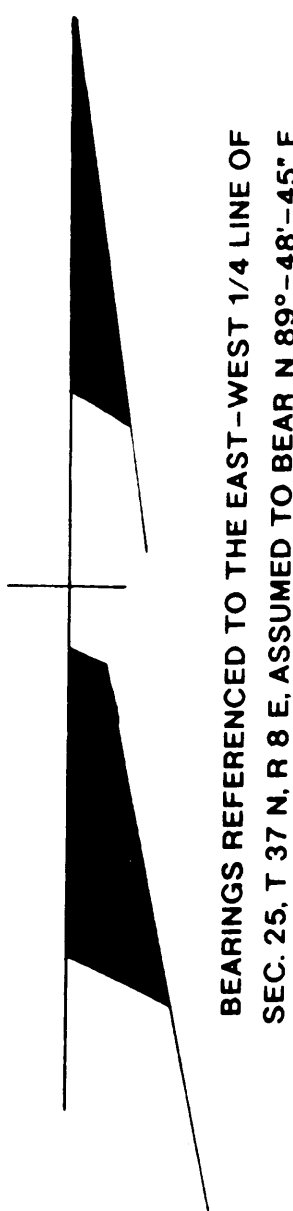

BEARINGS REFERENCED TO THE EAST-WEST 1/4 LINE OF
SEC. 25, T 37 N, R 8 E. ASSUMED TO BEAR N 89°-48'-45° E

ONEIDA COUNTY CERTIFIED SURVEY MAP NO. 403

PARCEL 1
1.02 ACRES
44,581 SQ. FT.

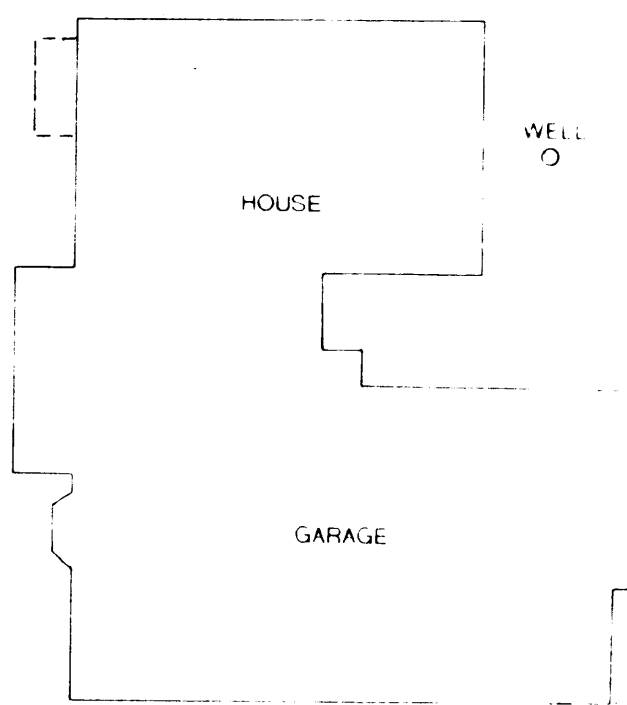

VOL. 422 PAGE 100

LEGEND

- SET 1" X 24" IRON PIPE
(AS PART OF GENISOT SURVEY #9027)
- FOUND 1" IRON PIPE
- ⊙ FOUND 1 1/4" IRON PIPE
- FOUND ONEIDA COUNTY MONUMENT
- () RECORDED AS
- ▲ SET RAILROAD SPIKE
(AS PART OF GENISOT SURVEY #9027)
- FOUND 2" IRON PIPE

NOTE - PIPE DIMENSIONS ARE I.D.

I WILLIAM E. BANDOW, HEREBY CERTIFY THAT I HAVE SURVEYED THE ABOVE PARCEL OF LAND UNDER
THE DIRECTION OF JACK SORESENSEN AND THAT THE ABOVE MAP IS A TRUE AND CORRECT
REPRESENTATION OF THE LANDS SURVEYED TO THE BEST OF MY KNOWLEDGE AND BELIEF
THAT I HAVE PROVIDED A DESCRIPTION OF THE PARCEL ON A SEPARATE SHEET
THAT I HAVE COMPLIED WITH THE PROVISIONS OF AE 7 OF THE WISCONSIN ADMINISTRATIVE CODE

William E. Bandow 5-6-04
WILLIAM E. BANDOW DATE



SURVEY FOR
JACK SORESENSEN

SCALE 1"=20' DATE 05/05/04 OWN. BY R.B.
DWG. NO. 10679 GENISOT AND ASSOCIATES, INC.
RHINELANDER, WIS.