

PART OF THE
SOUTHEAST 1/4 OF THE SOUTHEAST 1/4
SECTION 15
AND PART OF THE
SOUTHWEST 1/4 OF THE SOUTHWEST 1/4
AND PART OF THE
NORTHWEST 1/4 OF THE SOUTHWEST 1/4
AND PART OF THE
SOUTHWEST 1/4 OF THE NORTHWEST 1/4
SECTION 14
TOWNSHIP 38 NORTH, RANGE 6 EAST
TOWN OF HAZELHURST
ONEIDA COUNTY, WISCONSIN

SCALE: 1" = 100'

ASSUMED NORTH BASED ON
THE WISCONSIN DEPARTMENT OF
NATURAL RESOURCES TRAIL
WHICH BEARS
N 11°17'47" E

SURVEYOR'S CERTIFICATE

I, Benton A. McMullen, Wisconsin Registered Land Surveyor
S-2555, do hereby certify that I have surveyed and mapped
the property shown hereon, and that I have complied with the
applicable requirements of the Wisconsin Administrative Code
Chapter A-E 7, and that this map represents a true and accurate
survey of said property to the best of my knowledge and belief.

This survey was performed under the order of:
Ralph Blanchard

This survey is made for the use of the present owners of
the property, and also those who purchase, mortgage, or
guarantee the title thereto within one year from date hereof.

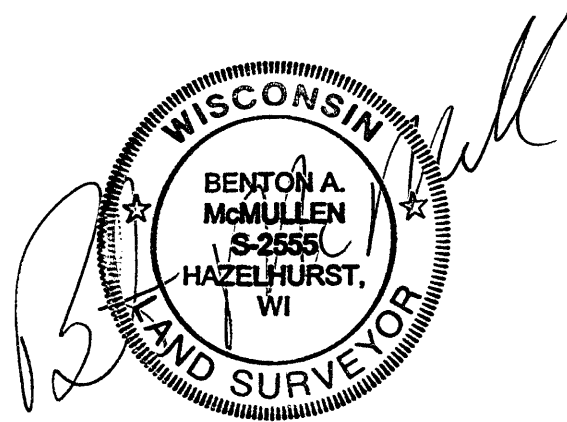

Registered Land Surveyor # S-2555
Benton A. McMullen

PARCEL - B -

Area Parcel - B -:
9.92 Acres
432135 Sq. Feet Acres
more or less

NOTE: MCMULLEN & ASSOC., INC. DID NOT FLAG / MARK LOT LINES PER THIS SURVEY.

NOTE: EXISTING STRUCTURES WHERE NOT LOCATED / SHOWN PER THIS SURVEY.

NOTE: LEGAL DESCRIPTIONS PROVIDED ON SEPARATE SHEETS.

CURVE TABLE

Curve	Delta Angle	Radius	Chord	Chord Bearing
C1	45°14'59"	1432.69'	1102.30'	S 11°19'25" E
C2	4°26'12"	1382.69'	107.04'	S 17°49'39" E
C3	26°54'37"	1382.69'	643.46'	S 2°09'14" E
C4	75°04'59"	1910.08'	2327.76'	S 26°14'43" E
C5	75°05'00"	1910.08'	2327.76'	S 26°14'43" E
C6	20°14'38"	1960.08'	688.95'	S 1°10'27" W
C7	13°33'32"	2964.90'	700.00'	N 15°46'36" E
C8	13°33'32"	2964.90'	700.00'	N 15°46'36" E
C9	1°41'07"	2764.90'	81.32'	N 9°50'23" E
C10	6°58'35"	2764.90'	336.44'	N 14°10'13" E
C11	2°52'50"	2764.90'	138.99'	N 19°05'55" E
C12	2°01'01"	2764.90'	97.33'	N 21°32'51" E
C13	31°20'49"	1382.69'	747.08'	S 4°22'20" E

Total Area:
23.26 Acres
1013334 Sq. Feet
more or less

PARCEL - A -

Area Parcel - A -:
13.34 Acres
581199 Sq. Feet
more or less

PARCIAL SECTION SUBDIVISION
SECTION 14
TOWNSHIP 38 NORTH, RANGE 6 EAST
TOWN OF HAZELHURST
ONEIDA COUNTY, WISCONSIN

SCALE 1" = 500'

EASEMENT PER VOLUME 483 PAGE 405.

MCMULLEN & ASSOCIATES,
INCORPORATED.
LAND SURVEYING AND SOIL TESTING
9832 BOLGER LAKE ROAD
MINOCQUA, WISCONSIN 54548
TELEPHONE # (715) 356-3011 FAX # (715) 356-1501

DRAFTED BY: Dwight A. Miesbauer DATE: November 30th, 2006
SCALE: 1" = 100' JOB # 206103