

08317

08317

Brass capped 2.4" dia. iron pipe previously found in place.

N 1/16 Corner Aluminum capped iron pipe previously set, 1" dia. x 48" long.

Oneida County capped Aluminum monument previously set, 2.4" dia. x 24" long.

CURVE DATA TABLE				
Curve	Radius	Length	Chord	Chord Bear.
C1	1238.38'	38.38'	38.38'	N 78°36'15"E
C2	1371.46'	162.71'	162.61'	N 76°05'37"E
C3	1171.38'	51.75'	51.74'	N 78°13'36"E
C4	1438.46'	148.96'	148.90'	N 76°31'32"E

Parcel "D" (Map No. 08-37)

A parcel of land in the Southwest Quarter of the Northwest Quarter of Section 23, Township 38 North, Range 4 East, Township of Minocqua, Oneida County, Wisconsin, being parcel "D" shown on Map No. 08-37 by Wilderness Surveying, Inc., dated April 17, 2008 and more particularly described as follows:

Beginning at the quarter corner common to Sections 22 and 23, marked by a capped aluminum monument; thence South 89 degrees 41 minutes 36 seconds East for a distance of 624.85 feet to an iron pipe near the westerly bank of Swamsauger Creek; thence continuing South 89 degrees 41 minutes 36 seconds East for a distance of 74.78 feet to a the thread of Swamsauger Creek; thence meandering along the thread of Swamsauger Creek, North 69 degrees 13 minutes 04 seconds East for a distance of 50.15 feet; North 06 degrees 21 minutes 26 seconds East for a distance of 77.72 feet; and North 77 degrees 43 minutes 36 seconds East for a distance of 43.94 feet; thence North 00 degrees 40 minutes 30 seconds East for a distance of 37.49 feet to an iron pipe near the northwesterly bank of Swamsauger Creek; thence continuing North 00 degrees 40 minutes 30 seconds East for a distance of 552.15 feet to an iron pipe; thence along a curve to the left, having a radius of 1171.38 feet and an arc length of 412.52 feet, being subtended by a chord of South 66 degrees 52 minutes 40 seconds West for a distance of 410.40 feet; thence along a curve to the right, having a radius of 2212.96 feet and an arc length of 475.99 feet, being subtended by a chord of South 62 degrees 56 minutes 42 seconds West for a distance of 475.07 feet to an iron pipe on the west line of the Southwest Quarter of the Northwest Quarter; thence South 00 degrees 49 minutes 26 seconds West for a distance of 312.98 feet along said west line of the Southwest Quarter of the Northwest Quarter to the place of beginning.

Together with and subject to covenants, easements, and restrictions of record.

Said property contains 9.26 acres, more or less.

Parcel "F" (Map No. 08-37)

A parcel of land in the Southwest Quarter of the Northwest Quarter of Section 23, Township 38 North, Range 4 East, Township of Minocqua, Oneida County, Wisconsin, being parcel "F" shown on Map No. 08-37 by Wilderness Surveying, Inc., dated April 17, 2008 and more particularly described as follows:

Commencing at the quarter corner common to Sections 22 and 23, marked by a capped aluminum monument; thence North 00 degrees 49 minutes 26 seconds East for a distance of 624.85 feet along the west line of the Southwest Quarter of the Northwest Quarter to the place of beginning, marked by an iron pipe.

Thence continuing along said west line of the Southwest Quarter of the Northwest Quarter, North 00 degrees 49 minutes 26 seconds East for a distance of 731.11 feet to an iron pipe; thence along a curve to the left, having a radius of 2012.96 feet and an arc length of 352.65 feet, being subtended by a chord of North 61 degrees 48 minutes 07 seconds East for a distance of 352.20 feet; thence along a curve to the right, having a radius of 1371.38 feet and an arc length of 382.02 feet, being subtended by a chord of North 64 degrees 45 minutes 49 seconds East for a distance of 380.79 feet to the westerly right of way line of Green Road; thence South 40 degrees 34 minutes 17 seconds East for a distance of 73.31 feet along said westerly right of way line of Green Road to an intersection with the northerly right of way line of Manhardt Road; thence along said northerly right of way line of Manhardt Road, along a curve to the left, having a radius of 1304.38 feet and an arc length of 332.38 feet, being subtended by a chord of South 65 degrees 24 minutes 03 seconds West for a distance of 390.90 feet; thence continuing along said right of way line, along a curve to the right, having a radius of 2079.96 feet and an arc length of 394.13 feet, being subtended by a chord of South 62 degrees 12 minutes 42 seconds West for a distance of 393.54 feet to the place of beginning.

Together with and subject to covenants, easements, and restrictions of record.

Said property contains 1.17 acres.

Parcel "H" (Map No. 08-37)

A parcel of land in the Southwest Quarter of the Northwest Quarter of Section 23, Township 38 North, Range 4 East, Township of Minocqua, Oneida County, Wisconsin, being parcel "H" shown on Map No. 08-37 by Wilderness Surveying, Inc., dated April 17, 2008 and more particularly described as follows:

Commencing at the quarter corner common to Sections 22 and 23, marked by a capped aluminum monument; thence North 00 degrees 49 minutes 26 seconds East for a distance of 1327.37 feet along the west line of the Southwest Quarter of the Northwest Quarter to the northwest corner of said Southwest Quarter of the Northwest Quarter, being the North Sixteenth Corner, marked by a capped iron pipe; thence South 89 degrees 33 minutes 21 seconds East for a distance of 367.02 feet along the north line of said Southwest Quarter of the Northwest Quarter to the place of beginning, marked by an iron pipe on the easterly right of way line of Green Road.

Thence continuing along said north line, South 89 degrees 33 minutes 21 seconds East for a distance of 556.96 feet to an iron pipe at the westerly bank of Swamsauger Creek; thence continuing along said north line, South 89 degrees 33 minutes 21 seconds East for a distance of 42.78 feet to the thread of Swamsauger Creek; thence meandering along the thread of Swamsauger Creek, South 14 degrees 59 minutes 29 seconds East for a distance of 52.34 feet; South 71 degrees 21 minutes 14 seconds East for a distance of 45.53 feet; North 48 degrees 36 minutes 47 seconds East for a distance of 41.08 feet; South 80 degrees 54 minutes 57 seconds East for a distance of 49.65 feet; South 00 degrees 08 minutes 52 seconds West for a distance of 100.46 feet; South 26 degrees 20 minutes 38 seconds East for a distance of 43.02 feet; South 27 degrees 44 minutes 39 seconds West for a distance of 35.03 feet; South 82 degrees 00 minutes 02 seconds West for a distance of 51.40 feet; South 09 degrees 53 minutes 32 seconds East for a distance of 35.48 feet; South 56 degrees 10 minutes 26 seconds East for a distance of 81.85 feet; South 15 degrees 41 minutes 37 seconds East for a distance of 29.04 feet; and South 42 degrees 30 minutes 32 seconds East for a distance of 32.20 feet; thence along a curve to the right, having a radius of 1238.46 feet and an arc length of 39.31 feet, being subtended by a chord of South 78 degrees 34 minutes 59 seconds West for a distance of 39.31 feet to a point on the westerly bank of said Swamsauger Creek; thence South 79 degrees 29 minutes 32 seconds West for a distance of 325.42 feet; thence along a curve to the left having a radius of 1371.38 feet and an arc length of 88.79 feet, being subtended by a chord of South 77 degrees 38 minutes 15 seconds West for a distance of 88.77 feet to the easterly right of way line of Green Road; thence North 40 degrees 34 minutes 17 seconds West for a distance of 239.38 feet along said right of way line; thence continuing along said right of way line, along a curve to the right, having a radius of 1968.94 feet and an arc length of 326.13 feet, being subtended by a chord of North 35 degrees 49 minutes 35 seconds West for a distance of 325.76 feet to the place of beginning.

Together with and subject to covenants, easements, and restrictions of record.

Said property contains 5.34 acres.

Parcel "E" (Map No. 08-37)

A parcel of land in the Southwest Quarter of the Northwest Quarter of Section 23, Township 38 North, Range 4 East, Township of Minocqua, Oneida County, Wisconsin, being parcel "E" shown on Map No. 08-37 by Wilderness Surveying, Inc., dated April 17, 2008 and more particularly described as follows:

Commencing at the quarter corner common to Sections 22 and 23, marked by a capped aluminum monument; thence North 00 degrees 49 minutes 26 seconds East for a distance of 312.98 feet along the west line of the Southwest Quarter of the Northwest Quarter to the place of beginning, marked by an iron pipe.

Thence continuing along said west line of the Southwest Quarter of the Northwest Quarter, North 00 degrees 49 minutes 26 seconds East for a distance of 72.30 feet to an iron pipe on the southerly right of way line of Manhardt Road; thence along said southerly right of way line, along a curve to the left, having a radius of 2145.96 feet and an arc length of 434.82 feet, being subtended by a chord of North 62 degrees 35 minutes 16 seconds East for a distance of 434.08 feet; thence continuing along said right of way line, along a curve to the right, having a radius of 1238.38 feet and an arc length of 452.44 feet, being subtended by a chord of North 67 degrees 14 minutes 59 seconds East for a distance of 449.93 feet to an iron pipe; thence South 00 degrees 40 minutes 30 seconds West for a distance of 68.86 feet to an iron pipe; thence along a curve to the left, having a radius of 1171.38 feet and an arc length of 412.52 feet, being subtended by a chord of South 66 degrees 52 minutes 20 seconds West for a distance of 410.40 feet; thence along a curve to the right, having a radius of 2212.96 feet and an arc length of 475.99 feet, being subtended by a chord of South 62 degrees 56 minutes 42 seconds West for a distance of 475.07 feet to the place of beginning.

Together with and subject to covenants, easements, and restrictions of record.

Said property contains 1.37 acres.

Parcel "G" (Map No. 08-37)

A parcel of land in the Southwest Quarter of the Northwest Quarter of Section 23, Township 38 North, Range 4 East, Township of Minocqua, Oneida County, Wisconsin, being parcel "G" shown on Map No. 08-37 by Wilderness Surveying, Inc., dated April 17, 2008 and more particularly described as follows:

Commencing at the quarter corner common to Sections 22 and 23, marked by a capped aluminum monument; thence North 00 degrees 49 minutes 26 seconds East for a distance of 529.59 feet along the west line of the Southwest Quarter of the Northwest Quarter to the place of beginning, marked by an iron pipe.

Thence continuing along said west line of the Southwest Quarter of the Northwest Quarter, North 00 degrees 49 minutes 26 seconds East for a distance of 797.38 feet to the northwest corner of said Southwest Quarter of the Northwest Quarter, being the North Sixteenth Corner, marked by a capped iron pipe; thence South 89 degrees 33 minutes 21 seconds East for a distance of 280.06 feet along the north line of the Southwest Quarter of the Northwest Quarter to an iron pipe on the westerly right of way line of Green Road; thence along said right of way line, along a curve to the left, having a radius of 2034.94 feet and an arc length of 377.31 feet, being subtended by a chord of South 35 degrees 15 minutes 35 seconds East for a distance of 376.77 feet; thence continuing along said right of way line, South 40 degrees 34 minutes 17 seconds East for a distance of 208.84 feet; thence along a curve to the left, having a radius of 1371.38 feet and an arc length of 382.02 feet, being subtended by a chord of South 64 degrees 45 minutes 49 seconds West for a distance of 380.79 feet; thence along a curve to the right, having a radius of 2012.96 feet and an arc length of 352.65 feet, being subtended by a chord of South 61 degrees 48 minutes 07 seconds West for a distance of 352.20 feet to the place of beginning.

Together with and subject to covenants, easements, and restrictions of record.

Said property contains 7.24 acres.

Parcel "I" (Map No. 08-37)

A parcel of land in the Southwest Quarter of the Northwest Quarter of Section 23, Township 38 North, Range 4 East, Township of Minocqua, Oneida County, Wisconsin, being parcel "I" shown on Map No. 08-37 by Wilderness Surveying, Inc., dated April 17, 2008 and more particularly described as follows:

Commencing at the quarter corner common to Sections 22 and 23, marked by a capped aluminum monument; thence North 00 degrees 49 minutes 26 seconds East for a distance of 1327.37 feet along the west line of the Southwest Quarter of the Northwest Quarter to the northwest corner of said Southwest Quarter of the Northwest Quarter, being the North Sixteenth Corner, marked by a capped iron pipe; thence South 89 degrees 33 minutes 21 seconds East for a distance of 367.02 feet along the north line of said Southwest Quarter of the Northwest Quarter to an iron pipe on the easterly right of way line of Green Road; thence along a curve to the left, having a radius of 1968.94 feet and an arc length of 326.13 feet, being subtended by a chord of South 35 degrees 49 minutes 35 seconds East for a distance of 325.76 feet along said right of way line; thence South 40 degrees 34 minutes 17 seconds East for a distance of 239.38 feet along said right of way line to the place of beginning.

Thence along a curve to the right, having a radius of 1371.38 feet and an arc length of 88.79 feet, being subtended by a chord of North 77 degrees 38 minutes 15 seconds East for a distance of 88.77 feet; thence North 79 degrees 29 minutes 32 seconds East for a distance of 325.42 feet to a point near the westerly bank of Swamsauger Creek; thence along a curve to the left having a radius of 1238.46 feet and an arc length of 39.31 feet, being subtended by a chord of North 78 degrees 34 minutes 59 seconds East for a distance of 39.30 feet to the thread of said Swamsauger Creek; thence meandering along the thread of said Swamsauger Creek, South 42 degrees 30 minutes 32 seconds East for a distance of 10.22 feet; South 02 degrees 52 minutes 22 seconds East for a distance of 38.98 feet; and South 25 degrees 44 minutes 38 seconds West for a distance of 24.91 feet intersecting the northerly right of way line of Manhardt Road; thence along a curve to the right, having a radius of 1305.46 feet and an arc length of 24.81 feet, being subtended by a chord of South 78 degrees 56 minutes 52 seconds West for a distance of 24.81 feet along said northerly right of way line; thence South 79 degrees 29 minutes 32 seconds West for a distance of 43.47 feet along said right of way line to a point near the westerly bank of said Swamsauger Creek; thence South 73 degrees 29 minutes 32 seconds West for a distance of 281.95 feet along said right of way line; thence continuing along said right of way line, along a curve to the left, having a radius of 1304.38 feet and an arc length of 51.04 feet, being subtended by a chord of South 78 degrees 22 minutes 16 seconds West for a distance of 51.04 feet to an intersection with the easterly right of way line of Green Road; thence North 40 degrees 34 minutes 17 seconds West for a distance of 75.25 feet along said easterly right of way line of Green Road to the place of beginning.

Together with and subject to covenants, easements, and restrictions of record.

Said property contains 0.66 acres, more or less.

SW 1/4 of the NW 1/4 Section 23, T38N, R4E

Part of the

Township of Minocqua
Oneida County, Wisconsin
SURVEYOR'S CERTIFICATE

I, James L. Rein, Registered Land Surveyor No. S-2335, hereby certify that I have surveyed the property shown hereon; that this map represents an accurate survey of said property to the best of my knowledge and belief; that I have performed this survey by order of Ron Hallstrom; and that I have complied with the requirements of Wisconsin

WILDERNESS
SURVEYING,
INC.

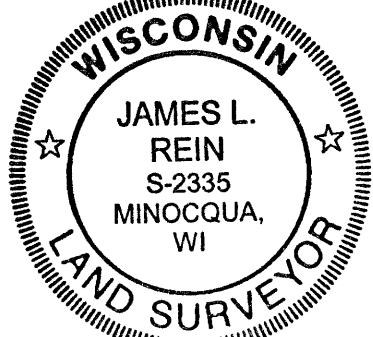

Registered Land Surveyor # S-2335
Dated this 17th day of April, 2008

WILDERNESS SURVEYING, INC.

Post Office Box 1111 - 8793 Earls Court

Minocqua, Wisconsin 54548-1111

Telephone (715) 356-5100 - www.wildernesssurveying.com

Map Number: 08-37

File Number: 5-23-384

Drafted by: Mike J. Schneider

Revisions:

Bearing Oneida County Grid
based on GPS survey data
and referenced to the west
line of the NW 1/4, bearing
N 00°49'26"E

Scale: 1" = 100'

MAP # 08317
DATE FILED DEC. 05, 2008
BY JAB
DESCRIPTION: SW 1/4 NW 1/4
ONEIDA CO. SURVEYOR'S OFFICE