

Part of the
NE 1/4 of the NE 1/4
and part of the
NW 1/4 of the NE 1/4
SECTION 7
T37N, R7E
Town of Cassian
Oneida County, Wisconsin

SURVEYOR'S CERTIFICATE
I, James L. Rein, Professional Land Surveyor No. S-2335, hereby certify that I have surveyed the property shown hereon; that this map represents an accurate survey of said property to the best of my knowledge and belief; that I have performed this survey by order of John Gehlbach, Attorney; and that I have complied with the requirements of Wisconsin Administrative Code A-E 7.

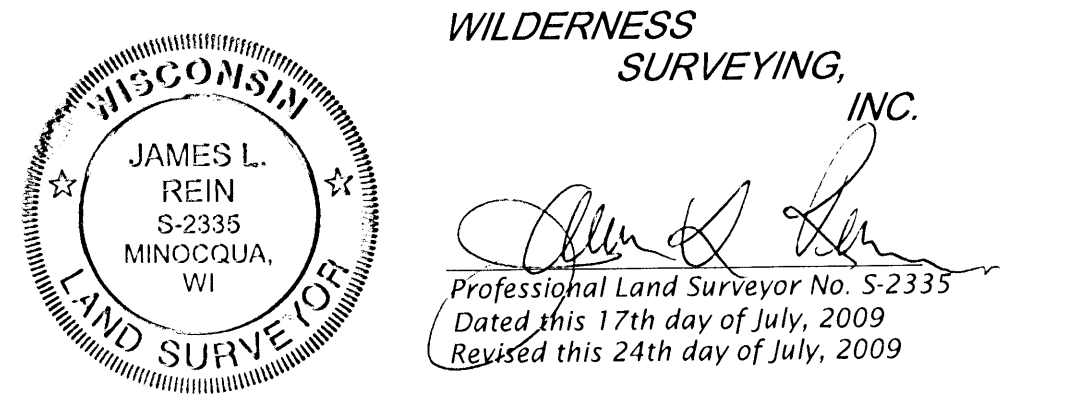

LEGEND

- = Set iron pipe; 1.0" dia. x 24" long.
- ◉ = 1.0" dia. iron pipe previously set by W.S.I.
- = 1.0" dia. iron pipe found in place.
- ⊙ = 1.25" dia. iron pipe found in place.
- Δ = Computed position not monumented.
- () = Bearing and distance of record.

Monument sizes are outside diameter dimension.
Other corner monuments are as noted.

Scale: 1" = 100'

0' 50' 100' 200'

PARCEL -B- (Map No. 09-57bc)
A parcel of land located in the Northeast Quarter of the Northeast Quarter, Section 7, Township 37 North, Range 7 East, Town of Cassian, Oneida County, Wisconsin, being "Parcel -B-" shown on Map No. 09-57bc by Wilderness Surveying, Inc., dated July 17, 2009, more particularly described as follows:
Beginning at the northeast corner of Section 7, marked by an Oneida County capped aluminum monument; thence South 00 degrees 26 minutes 13 seconds West for a distance of 1318.28 feet along the east line of the Northeast Quarter of the Northeast Quarter to the North Sixteenth Corner common to Section 7 and Section 8, marked by an iron pipe; thence North 88 degrees 10 minutes 21 seconds West for a distance of 750.64 feet along the south line of the Northeast Quarter of the Northeast Quarter to an iron pipe at an intersection with the easterly right of way line of Goodnow Road; thence North 14 degrees 55 minutes 59 seconds West for a distance of 385.89 feet along said easterly right of way line to an iron pipe; thence continuing along said easterly right of way line, along a curve to the left, having a radius of 600.00 feet and an arc length of 224.24 feet, being subtended by a chord of North 25 degrees 38 minutes 23 seconds West for a distance of 222.94 feet, to an iron pipe; thence continuing along said easterly right of way line, North 36 degrees 20 minutes 48 seconds West for a distance of 186.33 feet to an iron pipe; thence continuing along said easterly right of way line, along a curve to the right, having a radius of 867.00 feet and an arc length of 333.58 feet, being subtended by a chord of North 25 degrees 19 minutes 27 seconds West for a distance of 331.53 feet, to an iron pipe; thence continuing along said easterly right of way line, North 14 degrees 18 minutes 07 seconds West for a distance of 193.15 feet to an iron pipe at an intersection with the southerly right of way line of Sand Lake Road; thence along a curve to the left, having a radius of 475.72 feet and an arc length of 247.77 feet, being subtended by a chord of North 55 degrees 54 minutes 56 seconds East for a distance of 244.98 feet, along said southerly right of way line to an iron pipe; thence continuing along said southerly right of way line, along a curve to the left, having a radius of 302.03 feet and an arc length of 11.47 feet, being subtended by a chord of North 39 degrees 54 minutes 23 seconds East for a distance of 11.47 feet, to an iron pipe on the north line of Section 7; thence South 86 degrees 34 minutes 42 seconds East for a distance of 499.24 feet to a Meander Corner, marked by an iron pipe near the westerly shore of Simons Lake; thence continuing South 86 degrees 34 minutes 42 seconds East for a distance of 548.55 feet to the place of beginning.
Together with and subject to covenants, easements, and restrictions of record.
Said property contains 30.87 acres.

PARCEL -C- (Map No. 09-57bc)
A parcel of land located in the Northeast Quarter of the Northeast Quarter and in the Northwest Quarter of the Northeast Quarter, Section 7, Township 37 North, Range 7 East, Town of Cassian, Oneida County, Wisconsin, being "Parcel -C-" shown on Map No. 09-57bc by Wilderness Surveying, Inc., dated July 17, 2009, more particularly described as follows:
Commencing at the northeast corner of Section 7, marked by an Oneida County capped aluminum monument; thence South 00 degrees 26 minutes 13 seconds West for a distance of 1318.28 feet along the east line of the Northeast Quarter of the Northeast Quarter to the North Sixteenth Corner common to Section 7 and Section 8, marked by an iron pipe; thence North 88 degrees 10 minutes 21 seconds West for a distance of 819.57 feet along the south line of the Northeast Quarter of the Northeast Quarter to the place of beginning, marked by an iron pipe at an intersection with the westerly right of way line of Goodnow Road.
Thence continuing North 88 degrees 10 minutes 21 seconds West for a distance of 492.34 feet to the North-East Sixteenth Corner, marked by an aluminum capped iron pipe; thence North 00 degrees 21 minutes 22 seconds East for a distance of 942.39 feet along the west line of the Northeast Quarter of the Northeast Quarter to an iron pipe; thence North 88 degrees 09 minutes 59 seconds West for a distance of 54.58 feet to an iron pipe; thence North 00 degrees 39 minutes 33 seconds East for a distance of 229.76 feet to an iron pipe at an intersection with the southerly right of way line of Sand Lake Road; thence North 84 degrees 30 minutes 37 seconds East for a distance of 46.98 feet along said southerly right of way line to an iron pipe at an intersection with the westerly right of way line of Goodnow Road; thence South 14 degrees 18 minutes 07 seconds East for a distance of 26.12 feet along said westerly right of way line to an iron pipe on the west line of the Northeast Quarter of the Northeast Quarter; thence continuing South 14 degrees 18 minutes 07 seconds East for a distance of 168.89 feet to an iron pipe; thence continuing along said westerly right of way line, along a curve to the left, having a radius of 933.00 feet and an arc length of 358.98 feet, being subtended by a chord of South 25 degrees 19 minutes 27 seconds East for a distance of 336.76 feet, to an iron pipe; thence continuing along said westerly right of way line, South 36 degrees 20 minutes 48 seconds East for a distance of 186.33 feet to an iron pipe; thence continuing along said westerly right of way line, along a curve to the right, having a radius of 534.00 feet and an arc length of 199.58 feet, being subtended by a chord of South 25 degrees 38 minutes 23 seconds East for a distance of 198.42 feet, to an iron pipe; thence continuing along said westerly right of way line, South 14 degrees 35 minutes 59 seconds East for a distance of 366.01 feet to the place of beginning.
Together with and subject to covenants, easements, and restrictions of record.
Said property contains 7.02 acres.

WILDERNESS SURVEYING, INC.
Post Office Box 1111 - 8793 Earls Court
Minocqua, Wisconsin 54548-1111
Telephone: (715) 356-5100 - www.wildernesssurveying.com
Map Number: 09-57bc
File Number: S-377 & 6-377 & 8-377
Drafted by: J. Dick
Revisions: 7/24/09
Note for a small portion of Parcel -C-