

Description

Part of the Southwest 1/4 of the Southeast 1/4, Section 23, Township 39 North, Range 6 East, town of Minocqua, Oneida County, Wisconsin being previously described in Document No. 334999 recorded at the Oneida County Register of Deeds Office, shown on a survey map by Survey North, LLC of Wisconsin dated the 17th Day of June, 2011 having a Job No. of 111R5 and more particularly described as follows:

Commencing at the South 1/4 Corner of Section 23 marked by a 2.315" Iron pipe; thence North 3°44'03" East along the North - South 1/4 line of said Section (Grid North, based on said 1/4 line), a distance of 148.43 feet to a 1/2" Iron Rod on the Easterly right-of-way of Old 51 Road, said point being the POINT OF BEGINNING.

Thence leaving said right-of-way and continuing North 3°44'03" East along said 1/4 line, a distance of 1204.44 feet to a 1.660" Iron Pipe marking the Center - South 1/16 Corner of said Section; thence leaving said 1/4 line North 87°41'37" East along the Northerly line of the Southwest 1/4 of the Southeast 1/4, a distance of 550.99 feet to a 1.660" Iron Pipe on the Westerly right-of-way of U.S. Highway "51"; thence leaving said Northerly line South 17°01'00" West along said Westerly right-of-way, a distance of 1421.23 feet to a 1.050" Iron Pipe on the South line of said Section; thence leaving said right-of-way South 86°37'45" West along said Section line, a distance of 158.82 feet to a 1.050" Iron Pipe on the Easterly right-of-way of Old 51 Road; thence leaving said Section line North 20°42'06" West along said Easterly right-of-way, a distance of 154.24 feet to the POINT OF BEGINNING.

Said described tract containing 11.8 acres (514513 square feet), more or less.

Subject to any easements, restrictions, or rights of way of record or of use.

Together with Roadway Easement described in Document No. 344709 recorded at the Oneida County Register of Deeds Office.

MAP # 02716
DATE RECD 8/3/11
BY [Signature]
DESCRIPTION FILED
ONEIDA CO. SURVEYOR'S OFFICE

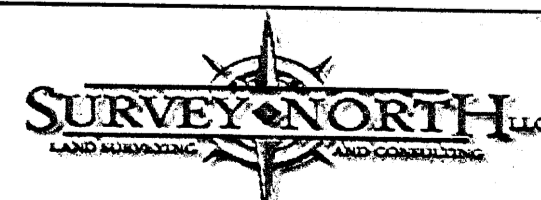

(715) 439-3226 www.survey-north-llc.com

Ascension Lutheran Church Topographical Survey

Part of the
Southwest 1/4 of the Southeast 1/4
Section 23, Township 39 North, Range 6 East
Town of Minocqua
Oneida County, Wisconsin

Drafted By: Dwight Miesbauer Sr. Scale: 1" = 50'
Dated the 17th Day of June, 2011 Job No. 111R5