



BEARINGS REFERENCED TO
THE ONEIDA COUNTY COORDINATE SYSTEM
AND THE WEST LINE OF THE NORTHWEST 1/4
SECTION 23 AS BEARING S00°12'03"E

I, JEFFREY L. DEMUTH, REGISTERED LAND SURVEYOR IN THE STATE OF WISCONSIN, HEREBY CERTIFY TO MY
CLIENT, MRS. SHARENE SMITH, AGENT TO THE OWNER, THE WISCONSIN DEPARTMENT OF NATURAL RESOURCES.
THAT I HAVE SURVEYED, MAPPED, AND DESCRIBED THE LANDS SHOWN HERE ON, AND THAT THIS MAP IS A TRUE
AND ACCURATE REPRESENTATION OF THE EXTERIOR BOUNDARIES OF LAND SURVEYED.

LANDS BEING:

PART OF THE NORTHEAST 1/4 OF THE NORTHEAST 1/4,
AND PART OF THE SOUTHEAST 1/4 OF THE NORTHEAST 1/4 OF SECTION 22,
AND PART OF THE SOUTHWEST 1/4 OF THE NORTHWEST 1/4 OF SECTION 23.
TOWN 36 NORTH, RANGE 6 EAST, TOWN OF NOKOMIS, ONEIDA COUNTY WISCONSIN AS DESCRIBED IN
DOCUMENT NUMBER 628240.

MORE PARTICULARLY DESCRIBED AS FOLLOWS:

COMMENCING AT SECTION CORNER COMMON TO SECTIONS 14, 15, 22 AND 23, T. 36 N., R. 6 E., AND THE POINT
OF BEGINNING OF THE PARCEL TO BE DESCRIBED.

THENCE S. 00°12'03" E., ALONG THE SECTION LINE COMMON TO SECTIONS 22 AND 23, T. 36 N., R. 6 E., 1327.71
FEET TO THE NORTH 1/16TH CORNER COMMON TO SAID SECTION 22 AND 23; THENCE LEAVING SAID SECTION LINE
AND ALONG THE 1/16TH LINE COMMON TO THE NW 1/4 - NW 1/4, SECTION 23 (DOCUMENT NUMBER 664302)
AND THE SW 1/4 - NW 1/4, SECTION 23 (DOCUMENT NUMBER 628240), S. 88°22'34" E., 1329.71 FEET TO THE
WEST RIGHT OF WAY LINE OF ROCKY ROAD; THENCE LEAVING SAID 1/16TH LINE AND ALONG SAID RIGHT OF WAY
LINE, S. 00°20'40" E., 32.80 FEET TO THE NORTH LINE OF THAT PARCEL DESCRIBED IN DOCUMENT NUMBER
547866; THENCE LEAVING SAID RIGHT OF WAY LINE AND ALONG SAID NORTH LINE, N. 88°07'47" W., 322.71 FEET
TO THE NORTHWEST CORNER OF SAID DOCUMENT NUMBER 547866; THENCE LEAVING SAID NORTH LINE AND
ALONG THE WEST LINE OF DOCUMENT NUMBERS; 547866, 638837, 519145, 437941, 698262, S. 00°25'09" E.,
1268.90 FEET TO THE SOUTHWEST CORNER OF DOCUMENT NUMBER 698262; THENCE LEAVING SAID WEST LINE
AND ALONG THE SOUTH LINE OF SAID DOCUMENT NUMBER 698262, S. 87°51'40" E., 321.12 FEET TO THE WEST
RIGHT OF WAY OF ROCKY ROAD; THENCE LEAVING SAID SOUTH LINE AND ALONG SAID RIGHT OF WAY LINE,
S. 00°20'40" E., 30.82 FEET TO THE 1/16TH LINE COMMON TO THE SW 1/4 - NW 1/4, SECTION 23 (DOCUMENT
NUMBER 628240), AND THE NW 1/4 - SW 1/4, SECTION 23 (DOCUMENT NUMBER 400212), THENCE ALONG SAID
1/16TH LINE, N. 88°06'43" W., 1333.26 FEET TO THE 1/4 CORNER COMMON TO SECTIONS 22 AND 23; THENCE
LEAVING SAID 1/16TH LINE AND ALONG THE 1/16TH LINE COMMON TO THE SE 1/4 - NE 1/4, SECTION 22
(DOCUMENT NUMBER 628240) AND THE NE 1/4 - SE 1/4, SECTION 22 (DOCUMENT NUMBER 324715),
S. 89°00'13" W., 517.90 FEET TO THE FORMER WEST RIGHT OF WAY LINE OF THE CHICAGO, MINNEAPOLIS, ST.
PAUL AND PACIFIC RAILROAD; THENCE LEAVING SAID 1/16TH LINE AND ALONG SAID FORMER RIGHT OF WAY LINE,
AND ALONG THE EAST LINE OF DOCUMENT NUMBERS; 590753, 671720, 603685, AND 613689, N. 07°11'52" E.,
2624.16 FEET TO THE POINT OF CURVATURE OF A CURVE TO THE RIGHT HAVING A RADIUS OF 5779.65 FEET AND
CHORD BEARING AND DISTANCE OF N. 07°29'15" E., 58.41 FEET; THENCE NORTHERLY ALONG THE ARC OF SAID
CURVE 58.42 FEET TO THE NORTH LINE OF THE NORTHEAST 1/4 OF SECTION 22; THENCE LEAVING SAID RIGHT OF
WAY LINE AND ALONG SAID NORTH LINE, N. 88°59'50" E., 172.13 FEET TO THE POINT OF BEGINNING.

CONTAINING ±52.32 ACRES INCLUDING LANDS OCCUPIED BY THE UNNAMED CREEK RUNNING NORTH-SOUTH
ACROSS THE PROPERTY.

SUBJECT TO ALL EASEMENTS, RESTRICTIONS, RESERVATIONS, AND RIGHTS OF WAY OF RECORD.
TO THE BEST OF MY KNOWLEDGE AND BELIEF.

SURVEYOR'S NOTE:

To resurvey the north and south lines of the Southwest 1/4 of the Northwest 1/4 of Section 23, Town 36 North,
Range 6 East. I used existing, record monuments as opposed to a mathematical subdivision of Section 23. My
reasoning is based on a number of factors, including; resident testimony, occupation, public improvements,
historic field notes, survey maps on file at the Oneida County Land Information office, deeds of record, and existing
monuments that have been established, and used by the area residents, and perpetuated by reference in deeds
and survey maps.

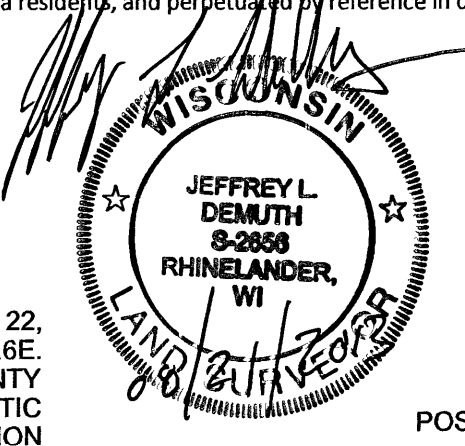

CENTER 1/4 CORNER SECTION 22,
T. 36N., R. 6E.
CALCULATED FROM COUNTY
COORDINATES. FOUND MAGNETIC
ATTRACTION

WEST 1/4 CORNER
SECTION 22, T. 36N., R. 6E.
USPLS RECORD 3606212000

- 1 1/2" DIAMETER IRON PIPE, FOUND
- ⊕ ONEIDA COUNTY MONUMENT, FOUND AND NOTED
- ▲ MATHEMATICAL POSITION
- 1" DIAMETER IRON PIPE, FOUND
- 1/2" X 2 1/2" FLAT IRON BAR, FOUND
- ⊙ 4" DIAMETER CAPPED ALUMINUM MONUMENT, FOUND
- GALVANIZED IRON PIN, FOUND
- POST FOUND
- 3/4" DIAMETER X 18" OR 24" LONG IRON ROD, YELLOW PLASTIC CAP, SET
- 1 3/4" DIAMETER X 30" LONG IRON PIPE, SET
- () RECORD MEASUREMENT

0 100' 200' 400'

SE-SE
S. 15, T. 36N., R. 6E.

LAND CONTRACT #506586

SW-SW
S. 14, T. 36N., R. 6E.

PIPE FOUND
N51°52'33"W, 6.24' OF
CALCULATED POSITION
DELTA = 00°34'45"
RADIUS = 5779.65'
CHORD = N07°29'15"E
58.41'
ARC = 58.42'

NE-NE
S. 22, T. 36N., R. 6E.

WD #613689
EX. #307780

PIPE FOUND
1.24' WEST
OF LINE

WD #603685
EXCEPTION

PIPE FOUND
1.24' EAST
OF LINE

30' EASEMENT
#412541
#628240

WD #671720
EX. #272801

SE-NE
S. 22, T. 36N., R. 6E.

QCD #590753
EX. #289252

PIPE FOUND
N19°45'44"W, 0.88'
FROM CALCULATED
POSITION (SEE MAP B3370)

WD #561923
MAP #B3370

NE-SE
S. 22, T. 36N., R. 6E.

WD #324715
MAP #2532

P.T. 4

SW CORNER SECTION 23,
SE CORNER SECTION 22,
T. 36N., R. 6E.
CALCULATED FROM COUNTY
COORDINATES
USPLS RECORD 3606220000

NW-SW
S. 23, T. 36N., R. 6E.
WD #400212

NW-NW
S. 23, T. 36N., R. 6E.
QCD #693226

THERE IS AN OLD DOWN FENCE ALONG THE NORTH LINE
OF THE SW-NW. THE FENCE IS ±3' NORTH OF MARKED LINE
FROM ROCKY ROAD, WEST TO THE "YARD". THE FENCE IS
RIGHT ON THE MARKED LINE, FROM THE "YARD", WEST
INTO THE SWAMP.

QCD #664302

WD #628240
343561 SQ. FT.
±7.89 ACRES

S89°00'02"W
345.16'

S88°22'34"E
1361.48'

S88°22'34"E
1361.48'

S88°22'34"E
1361.48'

S88°22'34"E
1361.48'

S88°22'34"E
1361.48'

S88°22'34"E
1361.48'

S88°22'34"E
1361.48'

S88°22'34"E
1361.48'

S88°22'34"E
1361.48'

S88°22'34"E
1361.48'

S88°22'34"E
1361.48'

S88°22'34"E
1361.48'

S88°22'34"E
1361.48'

S88°22'34"E
1361.48'

S88°22'34"E
1361.48'

S88°22'34"E
1361.48'

S88°22'34"E
1361.48'

S88°22'34"E
1361.48'

S88°22'34"E
1361.48'

S88°22'34"E
1361.48'

S88°22'34"E
1361.48'

S88°22'34"E
1361.48'

S88°22'34"E
1361.48'

S88°22'34"E
1361.48'

S88°22'34"E
1361.48'

S88°22'34"E
1361.48'

S88°22'34"E
1361.48'

RESURVEY-LANDS BEING
PART OF THE NE 1/4-NE 1/4 AND PART OF THE SE 1/4-NE 1/4, SECTION 22,
AND PART OF THE SW 1/4-NW 1/4 SECTION 23,
TOWN 36 NORTH, RANGE 6 EAST, TOWN OF NOKOMIS, ONEIDA COUNTY,
WISCONSIN, UNITED STATES OF AMERICA (DESCRIBED IN DOCUMENT NUMBER 628240)

NORTH 1/4 CORNER
SECTION 23, T. 36N., R. 6E.
USPLS RECORD 3606140020

NW-NE
S. 23, T. 36N., R. 6E.

NE-NW
S. 23, T. 36N., R. 6E.

NW 1/16TH CORNER
BY WILLIAM STUTH 1963
PIPE OF RECORD FOUND AND ACCEPTED
S17°43'44"E, 11.75'
OF MATHEMATICAL 1/16TH CORNER.

OCTOBER 18, 1904 D.H. VAUGHAN RAN LINE FROM
WEST 1/16TH CORNER ON NORTH LINE OF SECTION 23
TO WEST 1/16TH CORNER ON SOUTH LINE OF SECTION 23.
"THIS LINE FOR ROAD THIS 1/8TH LINE. WHEN SECTION IS
SURVEYED MAY NOT BE STRAIGHT, BUT THINK ROAD WILL
BE INSIDE THE LIMITS."

CN 1/16TH CORNER
BY WILLIAM STUTH 1963
PIPE OF RECORD FOUND AND ACCEPTED
S01°46'37"W, 12.17'
OF MATHEMATICAL 1/16TH CORNER.

SW-NE
S. 23, T. 36N., R. 6E.

SE-NW
S. 23, T. 36N., R. 6E.

MAP # C 2790
DATE FILED 9-24-13
BY JLD
DESCRIPTION FILED
ONEIDA CO. SURVEYOR'S OFFICE

EAST 1/4 CORNER
SECTION 23, T. 36N., R. 6E.
USPLS RECORD 3606232000

MONUMENT FOUND AND ACCEPTED
S01°45'23"W, 24.60'
OF MATHEMATICAL CENTER 1/4 CORNER.
(SEE MAP B3405 & 4370 WHICH SHOW
THE SAME TYPE OF MONUMENT AT THE
SW 1/16TH CORNER)

NW-SE
S. 23, T. 36N., R. 6E.

SOUTH 1/4 CORNER
SECTION 23, T. 36N., R. 6E.
USPLS RECORD 3606230020

P.O.B. = POINT OF BEGINNING
QCD = QUIT CLAIM DEED
WD = WARRANTY DEED
PRD = PERSONAL REPRESENTATIVE'S DEED
EX. = EXCEPTION TO DOCUMENT NUMBER 628240
USPLS = UNITED STATES PUBLIC LAND SURVEY
N = NORTH
E = EAST
W = WEST
S = SOUTH
C = CENTER
L = LINE (L-2)
OH = OVERHEAD UTILITY
S. = SECTION
T. = TOWN
R. = RANGE

PROJECT NO.: 8267028	SCALE: AS SHOWN	NO.	DATE	REVISION	BY
PROJECT DATE: 07/18/2013	DRAWN BY: JLD				
CHECKED BY: JEA					