

PLAT OF SURVEY
A parcel of land in Government Lot 5, Section 24, Township 39 North, Range 7 East, Town of Woodruff, Oneida County, Wisconsin, more particularly described as follows:
Commencing at the meander corner where the North line of Government Lot 5 hits the West shore of Gilmore Lake, marked by an iron pipe; thence Southerly 500 feet along the Lake shore to the PLACE OF BEGINNING, marked by an iron pipe; thence West parallel to the North line of Government Lot 5 to the West line; thence South along the West line to the Southwest corner of Section 24; thence East along the South line of Section 24, the North right of way of County Trunk Highway; thence Easterly along the highway right of way to an iron pipe next to a yellow right of way post; thence N23°36'W, (solar bearing) 207.6 feet to an iron pipe near the shore of Gilmore Lake; thence Westerly and Northerly 1200 feet along the Lake shore to the Place of Beginning.
Subject to the right of way for the County Trunk Highway through said property.

Surveyed for: Terry Pisarek
Survey address: 8010 Hwy "E"

MAP # C3050/
DATE 9/12/2022
BY KY
DESCRIPTION
ONEIDA CO. SURVEYOR'S OFFICE

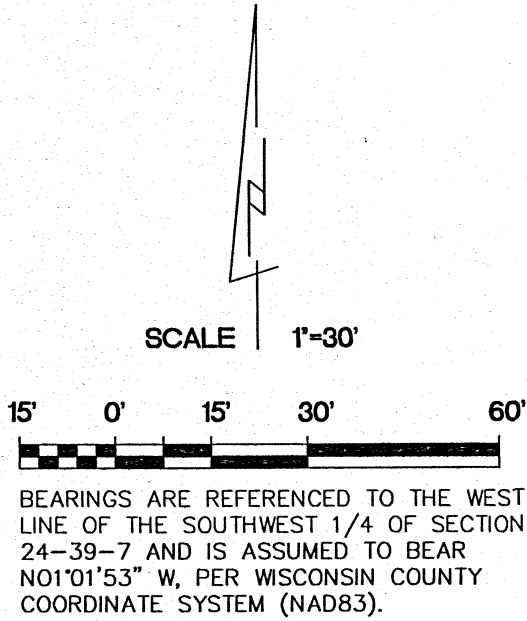

- FOUND COUNTY MONUMENT
 - FOUND 2 1/4" O.D. IRON PIPE
 - ✕ FOUND 3/4" IRON ROD
 - SET 1 1/4" O.D. IRON PIPE
 - () RECORDED AS DIMENSIONS
- 4.6± ACRES

MEASURED CURVE DATA

CURVE	RADIUS	LENGTH	CHORD	BEARING	DELTA
C1	608.52'	36.84'	36.83'	S76°58'37"W	03°28'07"
C2	608.52'	261.75'	259.74'	N88°57'58"W	24°38'43"
C2	608.52'	338.99'	334.62'	N60°41'04"W	31°55'04"

TERRANCE E. PISAREK, OWNER

MONUMENTATION WAS WAIVED BY OWNER IN ACCORDANCE WITH A-E7.01(2) OF THE WISCONSIN ADMINISTRATIVE CODE.

NOTE: LOCATION OF LAKE WAS TAKEN IN PART FROM THE ONEIDA COUNTY GIS MAPPING SITE.

I hereby certify that I have surveyed the above property and that the above map is a true representation thereof and shows the size and location of the property exterior boundaries, the location of all visible structures and dimensions of all principal buildings thereon, boundary lines, adjacent easements, roadways and encroachments if any.
This survey is made for the use of the present owners of the property, and also those who purchase, mortgage or guarantee the title thereto within one year from date hereof.

8/15/2022 TEP TEP 21139
DATE FIELD WORK BY DRAWN BY JOB NUMBER

Kettle Moraine Surveying Inc.
P.O. BOX 357
Eagle WI 53119
(262)594-3484

WISCONSIN
TERRANCE E. PISAREK
S-1850
EAGLE, WISCONSIN
LAND SURVEYOR

THIS IS NOT AN ORIGINAL SURVEY UNLESS THE SEAL IS FOLD.