

RECEIVED & FILED # **L1 01**  
 Oneida County Surveyor's Office  
 Date **0861 1 1 88A**  
 By **MTH**  
 GCS Area #

TOWNSHIP 37 NORTH, RANGE 8 EAST OF THE FOURTH PRINCIPAL MERIDIAN, WISCONSIN  
 SUBDIVISION OF LOT 11, SECTION 33

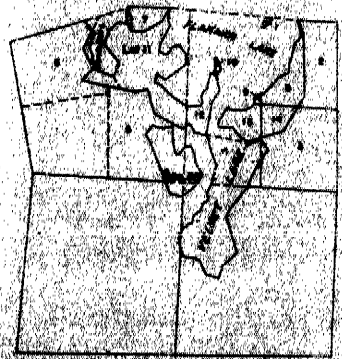
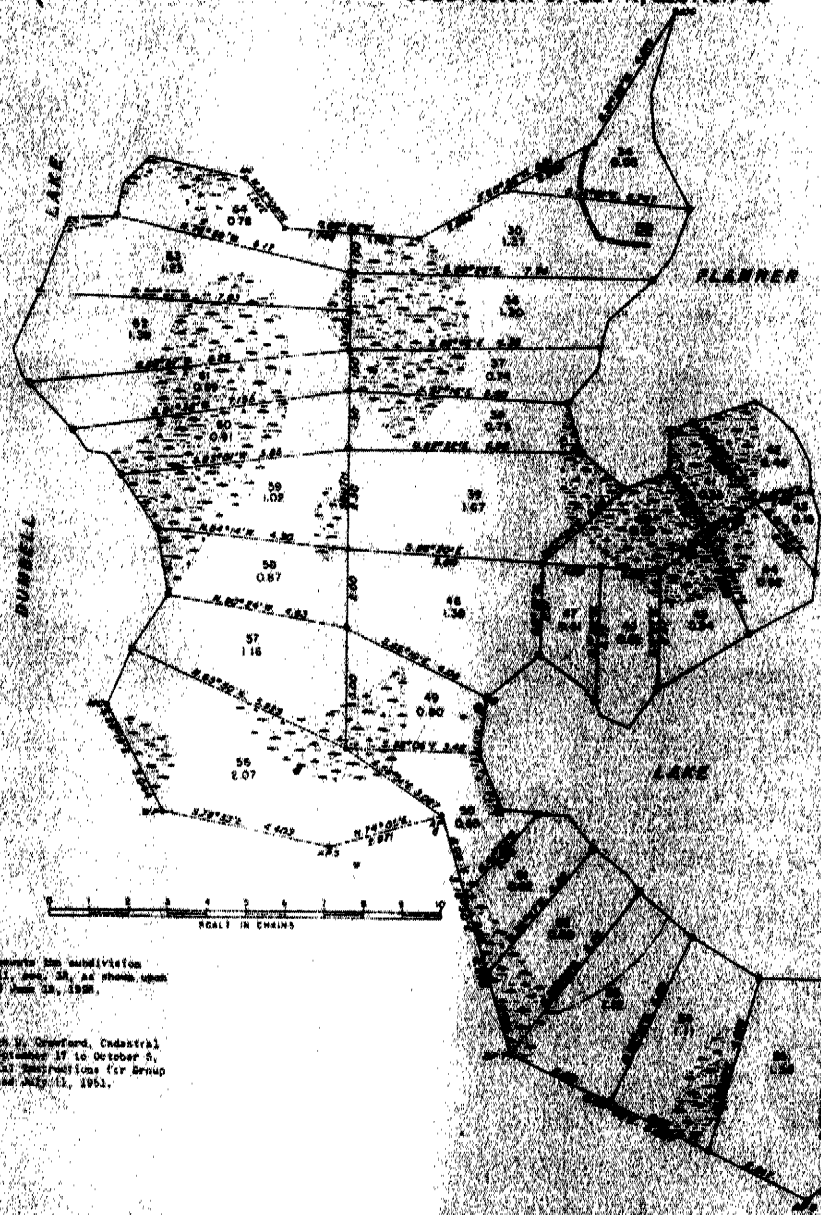
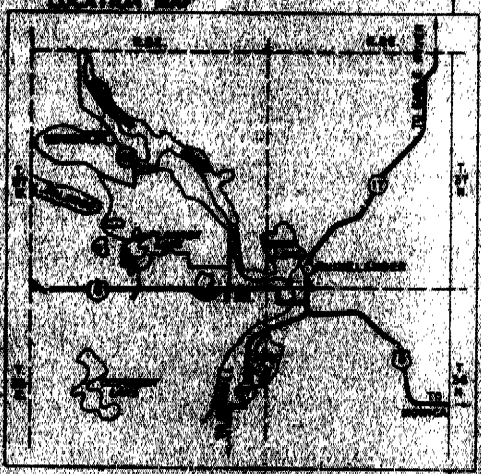

DIAGRAM OF SECTION 33

**LEGEND**  
 --- Original Survey  
 --- Subsequent Survey  
 --- Boundary Line of Lot 11, Section 33  
 --- Boundary Line of Section 33



LOCATION MAP

This plat represents the subdivision of original lot 11, sec. 33, as shown upon the plat accepted June 28, 1858.

Surveyed by John W. Oberland, Civil Engineer, from September 27 to October 3, 1950, under special instructions for Group 14 Wisconsin, dated July 13, 1951.

L1 01