

L1 285



PLANTING GROUND LAKE

Cad Post  
Tam on NW 15  
1/6 Lot  
10N35 1/2 E 42  
W 12 1/2 W 08 1/2

11-A (731 Acres)

N89 22 E  
11657 (7694)

11-J (929 Acres)  
Eiler

N89 3  
1028 (678)

N89 39 E-927 (6118)

Brinham  
11-K (1514 A)

N71 1/2 E  
385  
Due E  
2 15 1.3

### DATA PLAT

GOVT LOTS 5a 47-SE 31-T39N-R11E  
From Kona Re Survey Plat of 1938  
11 US 31 Re Survey, Pl 116/53  
Scale 1 = 500 ft = 77 ft  
E 21 r was Approx 1915-12  
[LM Brgs c treated to 11 11  
2° E Ave De l)  
I Branham  
July 1959

Dorr (IP) 11550 N 2 1/2  
Kondike Y 20 55 1/2 W 60

6 53 N 48° E - 12.06  
Re-ord Meander Line

N88 E  
2 80+

MAP # L1 285  
DATE FILED DEC 09 1993  
B7  
DISCLAIMER  
OIL AND GAS RIGHTS RESERVED

BRANHAM

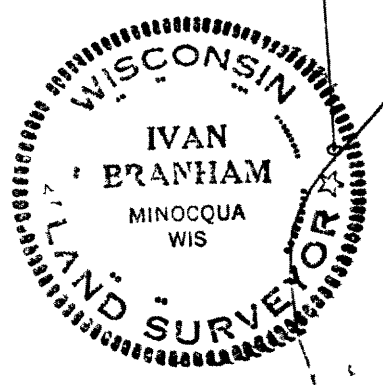

Brinham  
- 37 Rods  
(6105)

N 2 W - 16 48

ROAD

TOWN

TOWN LINE LAKE

BK # 3 pg 63

L1 285

L1 285