

MAP # **LI 299**
 DATE FILED **DEC 10 1993**
 BY *[Signature]*
 DESCI PILON
 ONEIDA CO SURVEYOR'S OFFICE

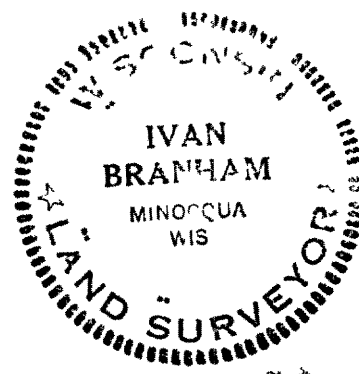

Sec 4
 1 P
 1/4 by Ma ne
 (buned N edged
 blacktop)

586° 40' W
 80.24 per Vaughan

County Road "K"

LI 299

1 we check 29.7 + 120.1
 39.7 (Vaughan)

BK# 5 pg 4
 22.53 road to fence cart
 (use to cart location)

SURVEY DATA

SEC 4, TOWN 36N, RANGE 8E

1 = 1000 = 660' - I. Branham

July - 19 95

LI 299