

PHASE  
-2-

MAP # **L1622**  
 DATE FILED **APR 19 1999**  
 BY *[Signature]*  
 DESCRIPTION FILED .....  
 ONEIDA CO. SURVEYOR'S OFFICE

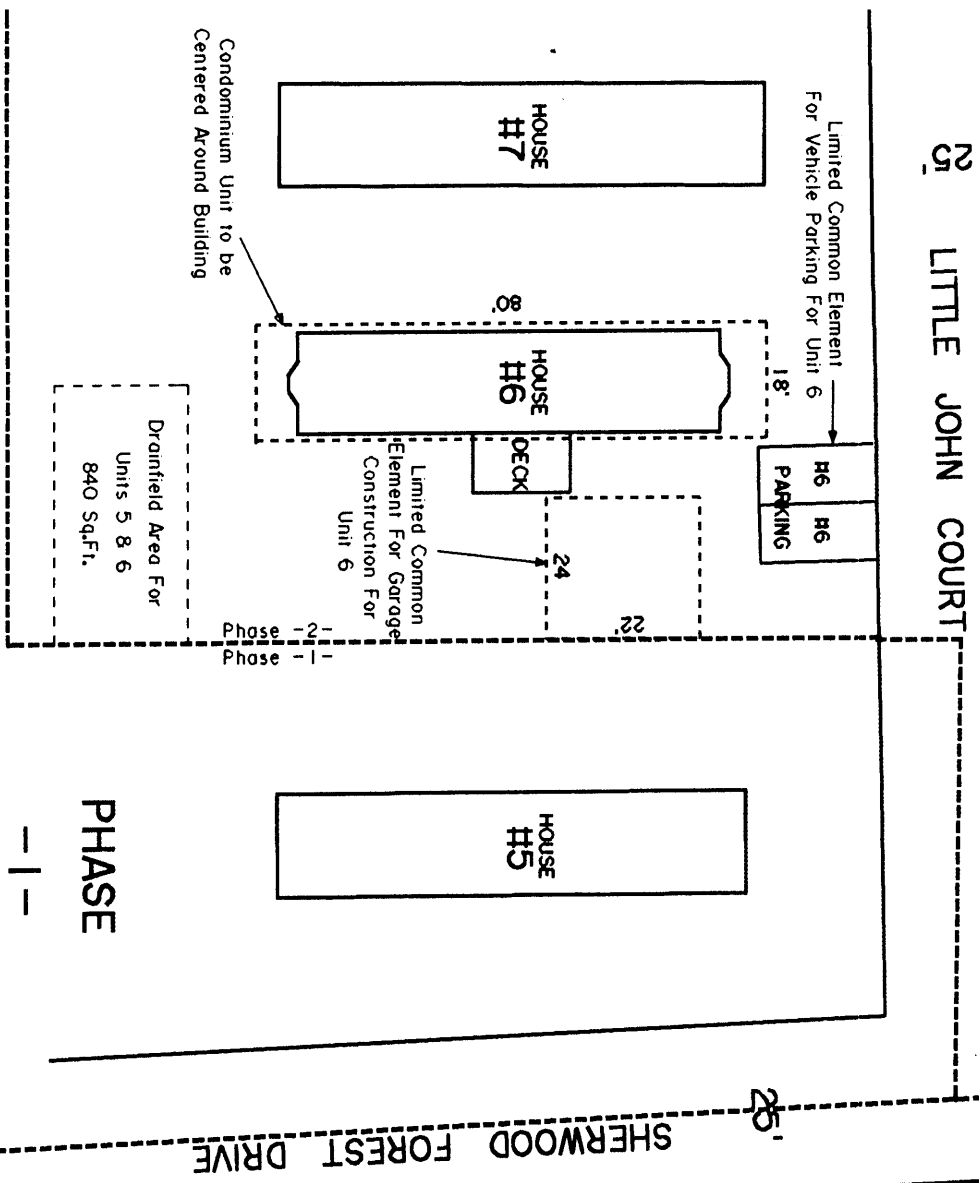

L1622

UNIT 6 OF PHASE 2  
 of the  
 AMENDED FINAL PLAT  
 of  
 SHERWOOD FOREST  
 A CONDOMINIUM  
 Located in Part of  
 Gov't. Lot 3  
 and Part of the  
 West 1/2 of the NE 1/4  
 Section 33, T39N, R7E  
 Woodruff Township, Oneida County, WI.

Note: According to Flood Insurance Rate Map H55083C0075 B with an effective date of August 5, 1991, Unit H6 is not in a Flood Plain.

**SURVEY WAIVER**

Pursuant to Chapter A-E 7 of the Wisconsin Administrative Code, Eagle Landmark Surveying, Inc. is required to meet certain Minimum Standards for Property Surveys as specified in Sections 7.01 through 7.07 of this code. Our client has agreed to exclude certain surveying work from these requirements as allowed in Chapter A-E 7.01 (2). The requirements of Chapter A-E 7 of the Wisconsin Administrative Code's Minimum Standards for Property Surveys which have been waived are listed below:

- DD Field measurements and angles as described in (A-E 7.06).
- DD Legal description prepared for this property (A-E 7.04).
- DD Monuments marking all property corners (A-E 7.03 & 7.07).

DATED THIS 16TH DAY OF DECEMBER, 1997.

*[Signature]*  
 JAMES L. WILL, RLS H1410.

Eagle Landmark Surveying, Inc.  
 5035 Highway 70 West  
 EAGLE RIVER, WI. 54821  
 WAIVER SURVEY FOR

AES-KENNETH DONNER  
 GREEN TREE FINANCIAL

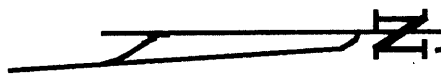
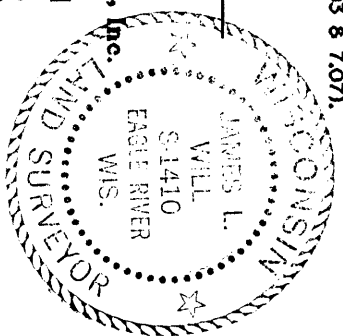

L1622

L1622