

MAP # **L 1 6 3 9**
 DATE FILED **JUL 0 9 1999**
 BY *JB*
 DESCRIPTION FILED
 ONEIDA CO. SURVEYOR'S OFFICE

**Part of
 GOV'T. LOT 6
 SECTION 26, T39N, R7E
 Woodruff Township
 Oneida County, Wisconsin**

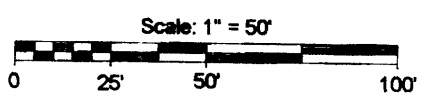

- LEGEND**
 ● - 2" Iron Pipe Found
 ○ - 1" Iron Pipe Found
 () - Recorded as value

HASBROOK
 WEST

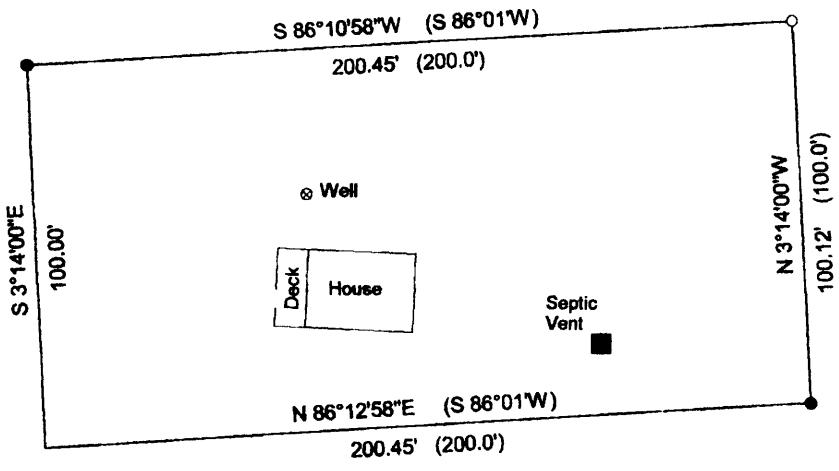

Assumed based on the east property line which bears N 3°14'00\"/>

HASBROOK DRIVE

SURVEYOR'S CERTIFICATE

I, David F. McMullen, Wisconsin Registered Land Surveyor # S-1340, do hereby certify that I have surveyed and mapped the property shown hereon, and that I have complied with the applicable requirements of the Wisconsin Administrative Code Section A-E 7, and that this map represents a true and accurate survey of said property to the best of my knowledge and belief.

This survey was performed under the order of:
 Joe Ziemianin

This survey is made for the use of the present owners of the property, and also those who purchase, mortgage, or guarantee the title thereto within one year from date hereof.

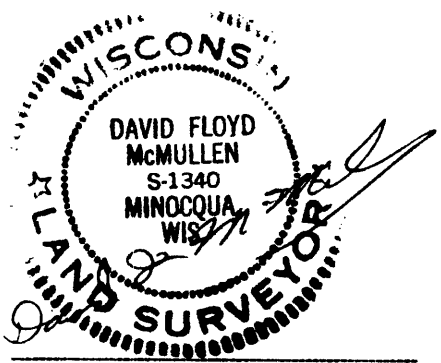

Registered Land Surveyor # S-1340

Date: 5/25/99

MCMULLEN & ASSOCIATES, INC.

Drafted By: Benton A. McMullen

L 1 6 3 9

L 1 6 3 9