

SURVEY LANDMARK PRESERVATION RECORD

It is the primary purpose of this record to preserve the location of any survey landmark subject to disturbance, removal or to be rendered inaccessible, as provided by Section 59.74(2), Perpetuation of Landmarks, Wisconsin Revised Statutes.

County: Oneida ~~City, Village,~~ Town: Nokomis Section: 29 Town: 36N Range: 6 East

Describe survey landmark found or reset and origin if known, such as being a 1/16 corner, called for in a deed or shown on a record land survey map or plat; also note location by Govt Lot, 1/4 1/4 section or other PLSS subdivisional tract.

Found an old 1/4" dia. by 1" PK nail in blacktop road mat at corner, which upon removal revealed a very strong metal reading with metal detector directly below, undoubtedly the 2" dia. iron pipe of record per Plat of Survey B-491, so I did not elect to dig for thru the blacktop pavement and I set a 1/2" dia. by 4.5" long tapered stainless steel pin with geared top flush into hole left by the old PK for new ties. Corner falls about 16" East of the centerline of 22' blacktop roadway to North & South. I painted a blaze orange cross on pavement at the corner.

I set a standard white poly 'T' marker post 41.7' West of corner.

I painted old BT blazes and flagged witness monuments and T post blaze orange.

There were no direct witnesses other than vehicular drive-bys.

Show approximate location of survey landmark on this Section diagram:

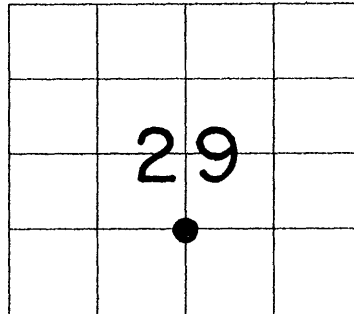

Plan view map of survey landmark location with bearing and distance ties to a minimum of four(4) described witness or reference monuments of concrete, natural stone, metal, live bearing trees or equivalent material and/or by described GPS method and precision. Date: 09/25/04

- ① 5/8" dia. by 24" long rebar set with yellow poly RM cap 1" up N87°W 41.28'.
- ② Old 14" Pr BT with lower blaze open and Survey Marker sign on upper face N47°W 48.07'.
- ③ Old record 2" dia. iron pipe found 2" below grade S87°E 31.38'; also a 1.5" galvanized iron pipe 7" up S87°E 26.38'.
- ④ Old 12" Pr BT with upper & lower blazes open S45°W 54.15'.

Scale: 1" = 40'

Unless otherwise indicated, all bearing tree ties are to a .25" dia. by 2.5" long PK nail with a 1.25" dia. steel washer driven into unblazed right face and a .25" dia. by 2.5" long PK nail with a 2" dia. steel washer stamped BT is also driven into unblazed face of bearing tree at DBH; the basis for measured bearings is by compass to nearest degree and all tie distances are measured horizontal by steel tape corrected to nearest 1/100th feet at standard temperature of 68° F.

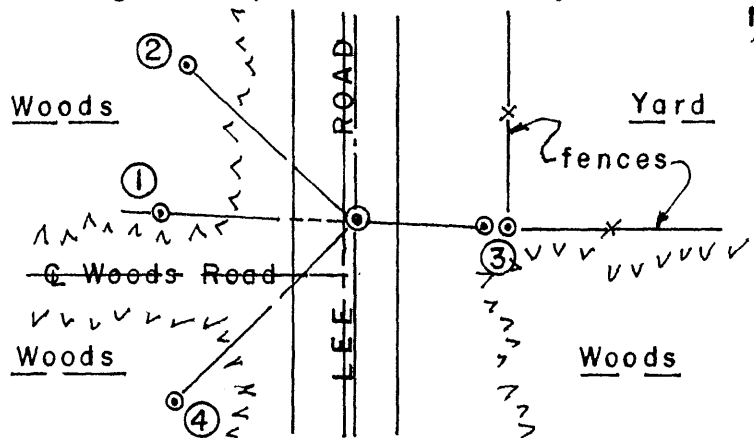

Seal:

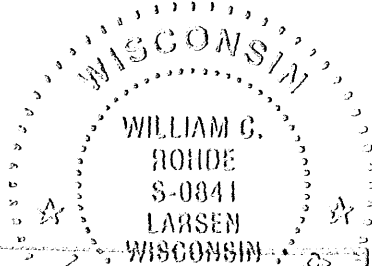

MAP # 12087
DATE FILED NOV 16 2004
BY MKK

Revised: 09/01/04
DESCRIPTION FILED
ONEIDA CO. SURVEYOR'S OFFICE

PROFESSIONAL LAND SURVEYOR CERTIFICATE:

This survey landmark is being referenced for the express purpose of location preservation and is not intended as an attestation of the legal significance and/or the positional accuracy thereof.

Therefore, this survey landmark location should be further evaluated and verified for any future land surveying or related usage purposes.

I, William C. Rohde, hereby certify that I am duly licensed as a Professional Land Surveyor in the State of Wisconsin; that the location of this survey landmark was referenced by me or under my direct supervision and/or control; and that the information shown is true and correct to the best of my knowledge and belief.

Signed: *William C. Rohde* Date: October 31, 2004

3606291020