

LAND CORNER PRESERVATION RECORD

It is the purpose of this record to preserve the location of a survey or land corner monument that may be disturbed, removed or inaccessible due to road construction or other activity.

County: Oneida	City, Village, Town: Minocqua	Section: 24	Town: 38N	Range: 5E
--------------------------	---	-----------------------	---------------------	---------------------

Describe what was found, its location and origin. If known, describe if the monument found is a 1/16 corner or other subdivisional corner; a monument called for in a deed; a monument shown on a survey map or plat etc and in what GL or 1/4 - 1/4 section or subdivision the monument is located.

Approximate location within Section 24, T38N, R5E

June 7, 2006: As shown below, I recovered monuments of the Plat of Lost Forest and also survey map OCS B-4457. These monument are located at the end of South Fork Road at the entrance to the Bear Lake boat landing. I perpetuated the locations as shown below with the basis of bearings... referenced to that used in OCS B-4457.

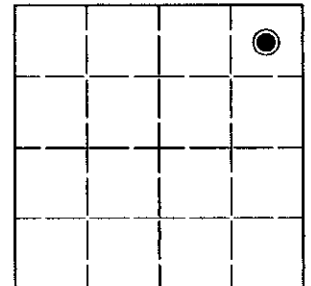

Plan view map of landmark monument location with bearing and distance ties to a minimum of four described witness or reference monuments of concrete, natural stone, metal, live bearing trees or equivalent material or indicate datum & coordinates if tied out using GPS. Indicate what was reset.

NORTH ↑

- = 3/4" diam. iron pipe fd.
- ⊕ = 1" diam. iron pipe fd.
- ⊗ = 2-1/4" diam. iron pipe fd.
- = 1" diam. iron pipe set

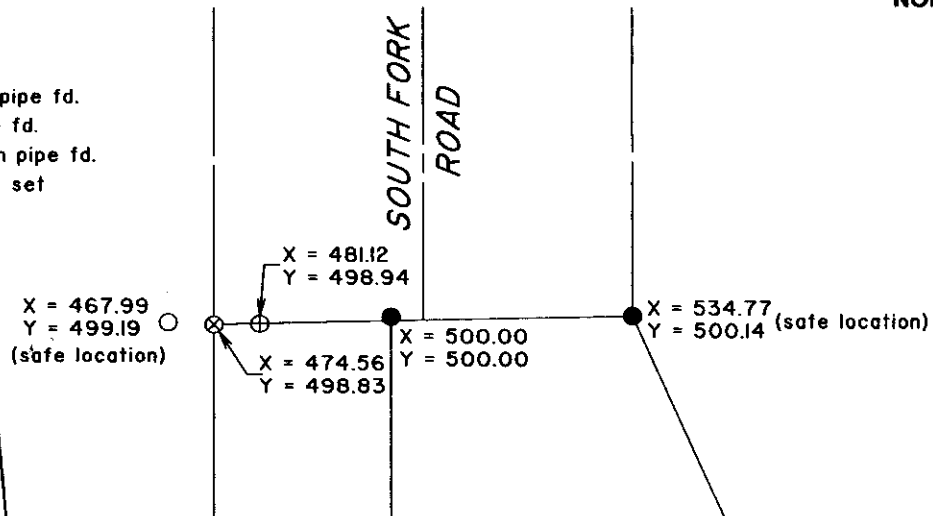

AP # L2288
 DATE FILED JUL 11 2006
 BY [Signature]
 DESCRIPTION FILED
 ONEIDA COUNTY SURVEYOR'S OFFICE

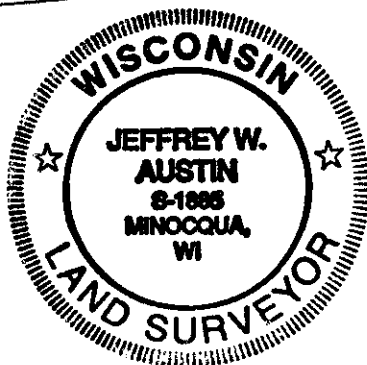

PROFESSIONAL LAND SURVEYOR CERTIFICATE:

This land corner was referenced out in advance of road construction or other activity as an act of preserving survey evidence or monuments. This corner has not been tested for its accuracy during the course of this preservation. It is recommended that those using the corner position evaluate and verify it prior to use in a survey or other use.

I hereby certify that I am a duly licensed Professional Land Surveyor in the State of Wisconsin; that the location of this Survey or Land Corner was referenced by me, or under my direct supervision and control and that the information shown on this record is true and correct to the best of my knowledge and belief.

Signature: [Handwritten Signature]
 Date: 20 JUNE 2006