

SURVEY LANDMARK PRESERVATION RECORD

It is the primary purpose of this record to preserve the location of any survey landmark subject to disturbance, removal or to be rendered inaccessible, as provided by Section 59.74(2), Perpetuation of Landmarks, Wisconsin Revised Statutes.

County: Oneida City, Village, Town: Little Rice Section: 13 Town: 36 N Range: 05 EAST

Describe survey landmark found or reset and origin if known, such as being a 1/16 corner, called for in a deed or shown on a record land survey map or plat; also note location by Govt Lot, 1/4 1/4 section or other PLSS subdivisional tract.

Found old rusted 1" dia. iron pipe 2" above grade with 2" dia. mushroomed cap stamped as the C1/16SW corner of Section 13 with a 6" dia. older wood marker post with notched in Survey Marker sign at top about 1' NNE in the center of dead end gravel roadway turn-around and 75'+/- West of Killarney Lake shore this date.

Corner monument found is the same as noted in legend on Oneida County Certified Survey Map No. 3270 dated January 12, 2006 by Lester J. Schmit/RLS 1192 and filed in Oneida County records as Document No. 627837.

This recovery completed October 04, 2006 as requested by Oneida County surveyor Michael Romportl; there were no direct witnesses.

I flagged corner monument and BTs.

Show approximate location of survey landmark on this Section diagram:

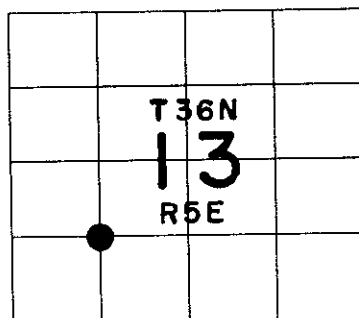

Plan view map of survey landmark location with bearing and distance ties to a minimum of four(4) described witness or reference monuments of concrete, natural stone, metal, live bearing trees or equivalent material and/or by described GPS method and precision.

Witness Ties:

- ① Uncapped 1" dia. iron pipe found S05E 33.04'
- ② New 10" Pr BT N07E 45.75'
- ③ New 10" Pj BT S85E 38.74'
- ④ New 8" Pj BT S35W 47.56'

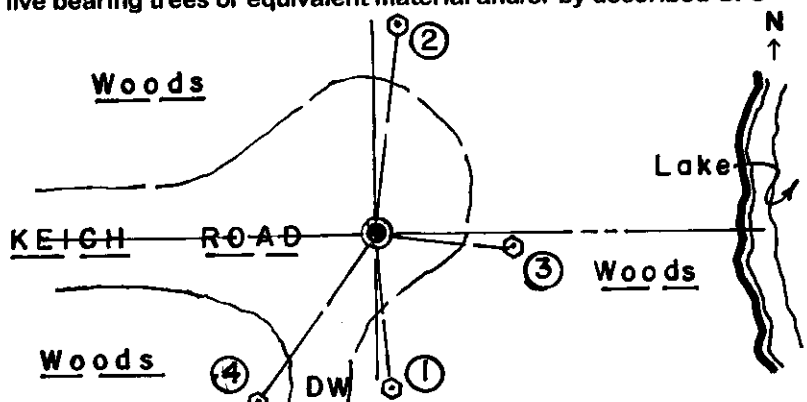

Scale: 1" = 40'

Unless otherwise indicated, all bearing tree ties are to a .25" dia. by 2.5" long PK nail with a 1.25" dia. steel washer driven into unblazed right face and a .25" dia. by 2.5" long PK nail with a 2" dia. steel washer stamped BT is also driven into unblazed face of bearing tree at DBH; the basis for measured bearings is by compass to nearest degree and all tie distances are measured horizontal by steel tape corrected to nearest 1/100th feet at standard temperature of 68° F.

Seal:



PROFESSIONAL LAND SURVEYOR CERTIFICATE:

This survey landmark is being referenced for the express purpose of location preservation and is not intended as an attestation of the legal significance and/or the positional accuracy thereof.

Therefore, this survey landmark location should be further evaluated and verified for any future land surveying or related usage purposes.

I, William C. Rohde, hereby certify that I am duly licensed as a Professional Land Surveyor in the State of Wisconsin; that the location of this survey landmark was referenced by me or under my direct supervision and/or control; and that the information shown is true and correct to the best of my knowledge and belief.

Signed: *William C. Rohde* Date: February 26, 2007