

L 2416

L 2416

MAP # **L 2416**  
 DATE FILED **NOV 16 2007**  
 BY **JOX**

# SURVEY LANDMARK PRESERVATION RECORD

It is the primary purpose of this record to preserve the location of any survey landmark subject to disturbance, removal or to be rendered inaccessible, as provided by Section 59.74(2), Perpetuation of Landmarks, Wisconsin Revised Statutes.

<b>County:</b> <b>ONEIDA</b>	<b>City, Village, Town:</b> <b>MONICO</b>	<b>Section:</b> <b>25</b>	<b>Town:</b> <b>36</b>	<b>Range:</b> <b>11</b>
---------------------------------	--	------------------------------	---------------------------	----------------------------

Describe what was found, its location and origin. If known, describe if the monument found is a 1/16 corner or other subdivisional corner; a monument called for in a deed; a monument shown on a survey map or plat ect. and in what Gov't Lot, 1/4-1/4 Section or other PLSS subdivisional tract.

Show approximate location of survey landmark on this Section diagram:

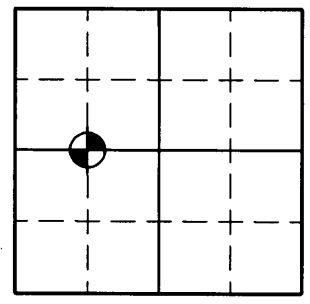

April 25, 2005 – Due to road construction Nicolet Surveyors, Inc. was hired by the Oneida County Land Information Office to preserve the location of this survey marker. We found a 1-1/2" iron pipe with brass cap – See U.S.P.L.S. Monument Record by Philip Hansen dated July 17, 1975. The corner lies approximately 144' North of the center line of old Highway "8" roadbed and is not in danger of being disturbed due to road construction.

November 7, 2007 – The Oneida County Land Information Office hired us to go and revisit the corner because the installation of a new power line may have disturbed this corner. We found a 1-1/2" iron pipe with brass cap. We set 4 new reference monuments as shown below.

Plan view map of survey landmark location with bearing and distance ties to a minimum of four(4) described witness or reference monuments of concrete, natural stone, metal, live bearing trees or equivalent material and/or described GPS method and precision.

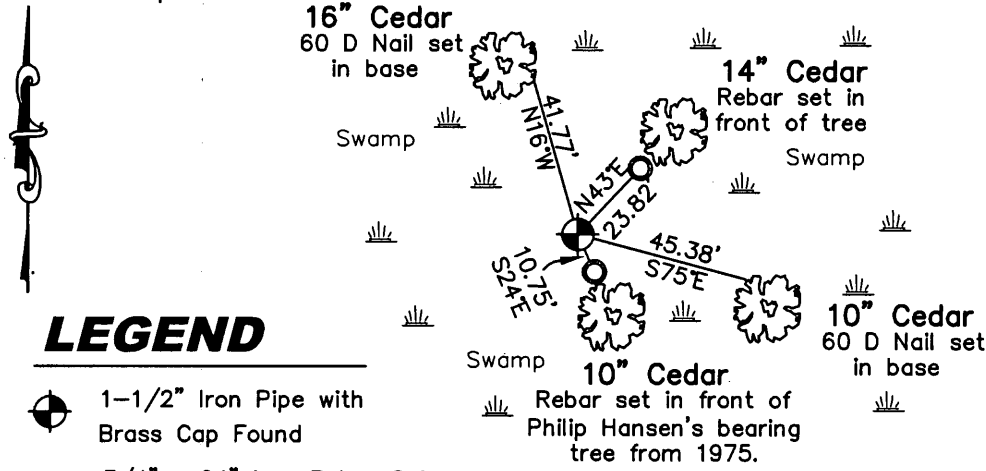

Scale: 1" = 50'

**NOTES:**

1. All bearing were taken with a hand compass and distances measured with a tape measure.
2. The Corner lies approximately 144' North of the old Highway "8" roadbed.

**LEGEND**

- 1-1/2" Iron Pipe with Brass Cap Found
- 3/4" x 24" Iron Rebar Set Weighing 1.50 lbs/lin. ft.

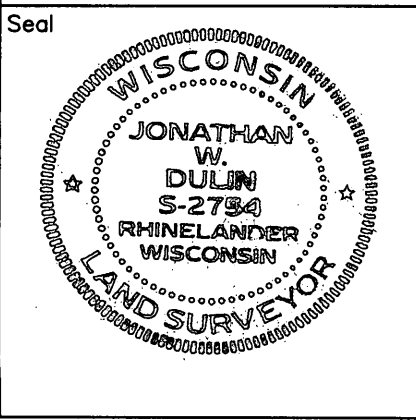

**PROFESSIONAL LAND SURVEYOR CERTIFICATE:**

This survey landmark is being referenced for the express purpose of location preservation and is not intended as an attestation of the legal significance and/or positional accuracy thereof.

Therefore, this survey landmark location should be further evaluated and verified for any future land surveying or related usage purposes

I, Jonathan W. Dulin, hereby certify that I am duly licensed as a Professional Land Surveyor in the State of Wisconsin; that the location of this survey landmark was referenced by me under my direct supervision and/or control; and that the information shown is true and correct to the best of my knowledge and belief.

Signed: *Jonathan W. Dulin* Date: 11/8/2007

3611252030

L 2416

L 2416