

RECEIVED & FILED # **L.2.4.5**  
 Oneida County Surveyor's Office  
 Date **FEB. 14 1986**  
 By **M.J.H.**  
 OCS Area # \_\_\_\_\_

10000000 } ss.  
 00000000 }

I, J. H. Vaughan, do hereby certify that I have surveyed and mapped a parcel  
 situated in Town of Oneida, Lot 3, in Section 10, Town of Oneida, Oneida County,  
 North. Range 14 East, as is represented on this Map. That I made said  
 map of E. M. McVicker as President of the Oneida Farm Co., a  
 true representation of the land so surveyed and of the  
 work made. I have surveyed, subdividing and mapping the  
 same in compliance with Chapter 101 of the revised  
 laws of this State and date of July 14th, 1915.

J. H. Vaughan  
 County Surveyor of Oneida  
 County, N. Y.

Lot 3

Oneida Lake

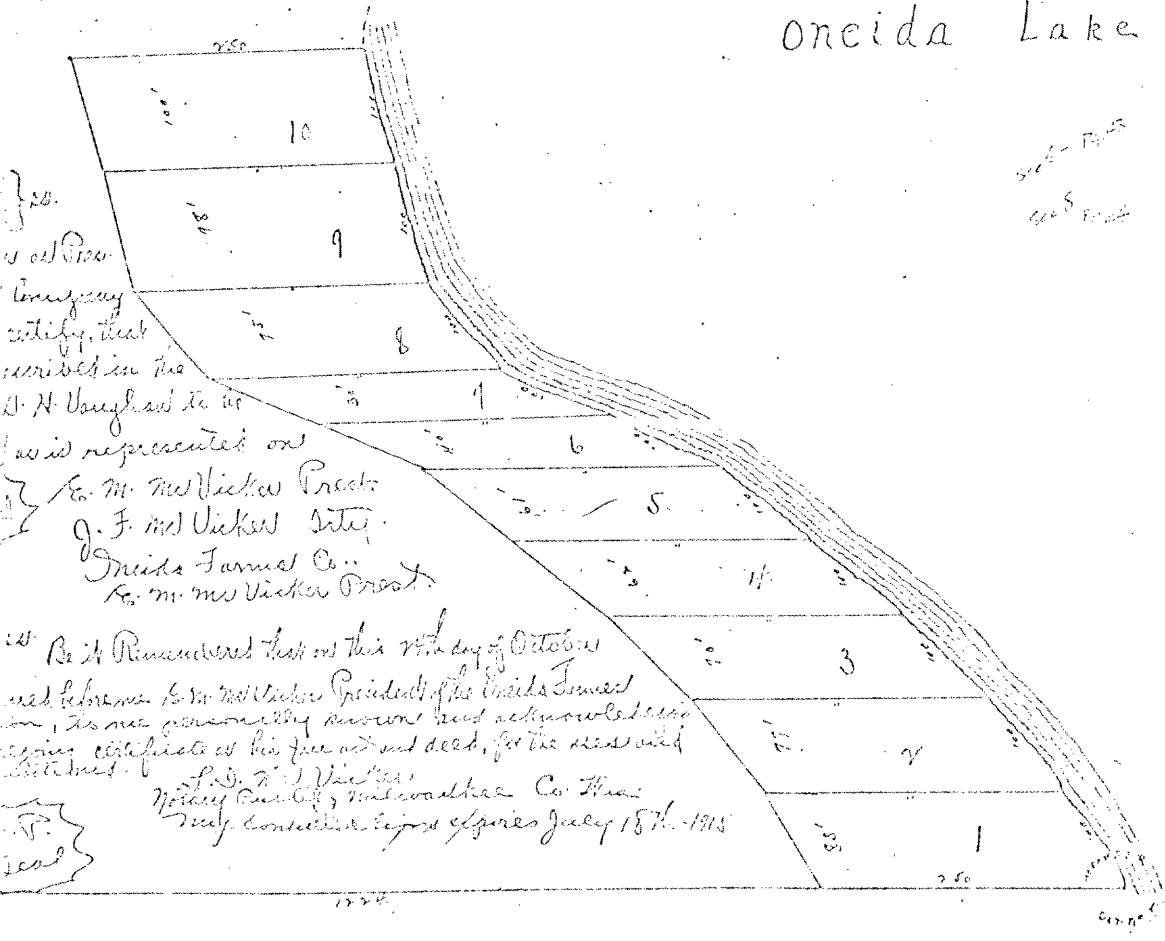

I do hereby certify that  
 as described in the  
 map is represented on  
 E. M. McVicker Pres.  
 J. F. McVicker Secy.  
 Oneida Farm Co.  
 E. M. McVicker Pres.

Be it Remembered that on this 14th day of October  
 1915, the same personally appeared and acknowledged  
 before me as his free and sole depts, for the record  
 J. H. Vaughan  
 County Surveyor of Oneida County, N. Y.  
 My Commission expires July 18th, 1915

Scale 100 feet = 1 inch



Registered Office  
 Oneida County, N. Y.  
 January 13th 1915  
 3  
 3  
 J. H. Vaughan

1245  
 12