

SURVEY LANDMARK PRESERVATION RECORD

It is the primary purpose of this record to preserve the location of any survey landmark subject to disturbance, removal or to be rendered inaccessible, as provided by Section 59.74(2), Perpetuation of Landmarks, Wisconsin Revised Statutes.

County: Oneida	City, Village, Town: Pine Lake	Section: 27	Town: 37 North	Range: 9 East
--------------------------	--	-----------------------	--------------------------	-------------------------

Describe survey landmark found or reset and origin if known, such as being a 1/16 corner, called for in a deed or shown on record land survey map or plat, also note location by Gov't. Lot, 1/4-1/4 section or other PLSS subdivisional tract.

Show approximate location of survey landmark on this Section diagram:

SW 1/16 Corner

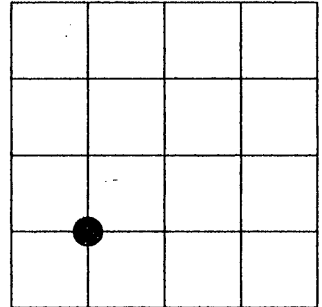

May 25th, 2006, recovered W. Birch bearing tree (now 10" in diameter, broken off & approximately 30 feet in height and still alive) mentioned on Map No. B1077. I compassed N3°E and measured 78.5', which falls near the southerly edge of pavement of Shepard Lake Road. I also measured south 228.84' from the Meander Corner shown on Map No. B1077. I made a thorough search of the area with a metal detector and was unable to recover iron pipe.

Reference materials: Survey Map No. B1077, filed 1/29/88

3709271030

MAP # **B 2493 B 2494**
 DATE FILED **MAY 02 2008**
 BY **JAB**
 DESCRIPTION FILED
 ONEIDA CO. SURVEYOR'S OFFICE

Pre-Construction

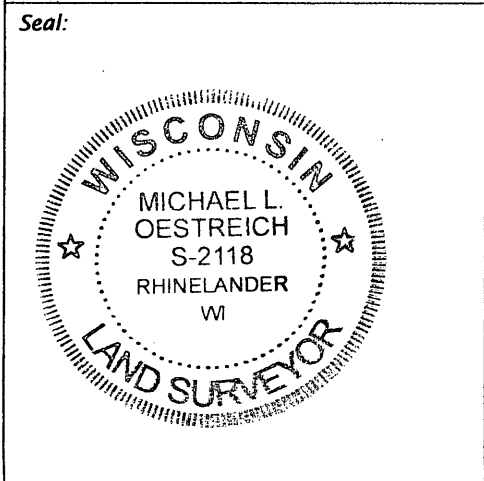

PROFESSIONAL LAND SURVEYOR CERTIFICATE:

This survey landmark is being referenced for the express purpose of location preservation and is not intended as an attestation of the legal significance and/or positional accuracy thereof.

Therefore, this survey landmark location should be further evaluated and verified for any future land surveying or related usage purposes.

I, Michael L. Oestreich, hereby certify that I am duly licensed as a Professional Land Surveyor in the State of Wisconsin; that the location of this survey landmark was referenced by me or under my direct supervision and/or control; and that the information shown is true and correct to the best of my knowledge and belief.

Signed: Michael L. Oestreich Date: 2-14-09