

SURVEY LANDMARK PRESERVATION RECORD

It is the primary purpose of this record to preserve the location of any survey landmark subject to disturbance, removal or to be rendered inaccessible, as provided by Section 59.74(2), Perpetuation of landmarks, Wisconsin revised statutes.

County: ONEIDA	City, Village, Town LITTLE RICE	Section 25	Town T36N	Range R05E
--------------------------	---	----------------------	---------------------	----------------------

Describe survey landmark found or reset and origin if known, such as being a 1/16th corner, called for in a deed or shown on a record land survey map or plat; also note location by gov't. lot 1/4 1/4 section or other PLSS subdivisional tract.

Show approximate location of survey landmark on this section diagram.

PRE-CONSTRUCTION

-JULY, 2008- Kevin Bixby found 3/4" iron rod and witnessed as shown below.

MAP # **L 2520**

DATE FILED **JUL. 09. 2008**.....

BY **JAB**.....

DESCRIPTION FILED

ONEIDA CO. SURVEYOR'S OFFICE

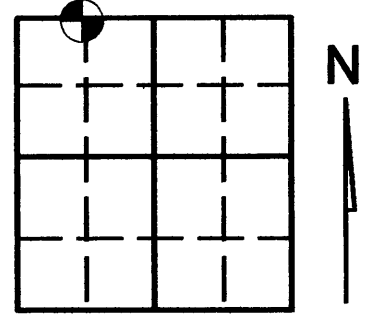

3605240030

Plan view map of survey landmark location with bearing and distance ties to a minimum of four (4) described witness or reference monuments of concrete, natural stone, metal, live bearing trees or equivalent material and/or by described GPS method and precision.

C/L LITTLE RICE DAM RD.

SCALE: 1"=30'

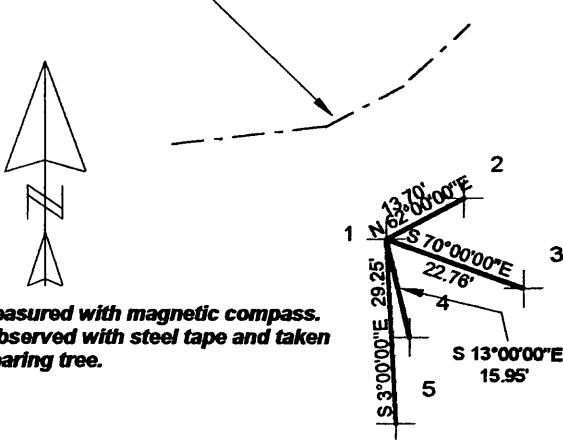

LEGEND

- 1- EXISTING 3/4" IRON ROD
- 2- 3" JACK PINE
- 3- 8" JACK PINE
- 4- 6" JACK PINE
- 5- 15" RED PINE

Bearings measured with magnetic compass.
Distances observed with steel tape and taken to face of bearing tree.

SURVEYOR'S NOTE:

No spikes, blazes in bearing trees, or iron pipes were set as witnesses, due to the residential location of the area.

PROFESSIONAL LAND SURVEYOR CERTIFICATE

This survey landmark is being referenced for the express purpose of location preservation and is not intended as an attestation of the legal significance and/or positional accuracy thereof.

Thereof, this survey land mark location should be further evaluated and verified for any future land surveying or related usage purposes.

I, Kevin P. Bixby hereby certify that I am duly licensed as a Professional Land Surveyor in the State of Wisconsin; that the location of this survey landmark was referenced by me or under my direct supervision and/or control; and that the information shown is true and correct to the best of my knowledge and belief.



SIGNED *Kevin P. Bixby*

DATE *07/06/08*