

WISCONSIN CONSERVATION DEPT. TO TOWN OF TOMAHAWK  
LAKE, ONEIDA COUNTY, WISCONSIN, C3 ROD ROAD EASEMENT  
T. 38. N. R. 7. E

MAP # **L2818**  
DATE FILED 8/22/11  
BY RA  
DESCRIPTION FILED .....  
ONEIDA CO. SURVEYOR'S OFFICE

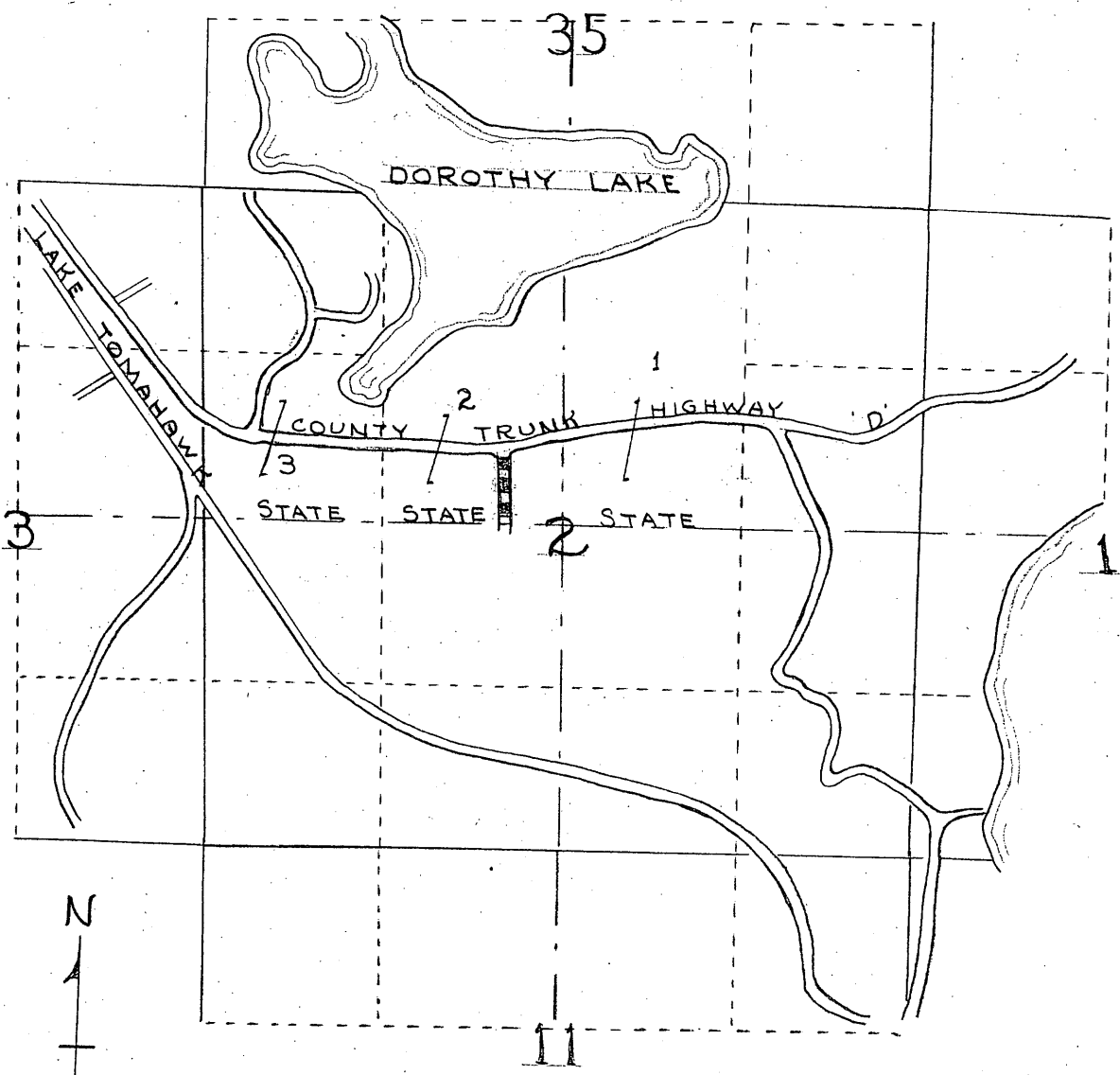

SCALE : 4 IN = 1 MI.  
REQUESTED RIGHT OF WAY  
IS IN RED