

**Part of Government Lot 1
Section 24, Township 38 North, Range 5 East
Town of Minocqua
Oneida County, Wisconsin**

Description

Part of Government Lot 1, Section 24, Township 38 North, Range 5 East, town of Minocqua, Oneida County, Wisconsin shown on a survey map by Survey North, LLC of Wisconsin with a Job No. of 12R016 dated the 30th Day of October, 2012, previously described in document no. 677891 recorded at the Oneida County Register of Deeds Office and more particularly described as follows:

Commencing at the Northeast Corner of Section 24 marked by a Brass Capped Iron Pipe; thence South 0° 00' 00" East along the East line of said Section (Assumed North, based on said Section line), a distance of 1721.41 feet to a 1.9" Capped Iron Pipe, said point being the POINT OF BEGINNING.

Thence continuing South along said Section line, a distance of 99.58 feet to a 1.7" Iron Pipe; thence leaving said Section line South 89° 57' 16" West, a distance of 309.36 feet to an Angle Iron near the Easterly shore of Bear Lake; thence meandering along said lake shore North 26° 09' 15" West, a distance of 111.00 feet to a 1.9" Iron Pipe; thence leaving said meander of said lake North 89° 58' 08" East, a distance of 358.28 feet to the POINT OF BEGINNING.

Including all those lands between the above described meander line and the water's edge of Bear Lake.

Excepting that part used for highway purposes.

MAP # **L2896** -
DATE FILED *11-20-12*
BY *JB*
DESCRIPTION FILED *2 pgs*
ONEIDA CO. SURVEYOR'S OFFICE

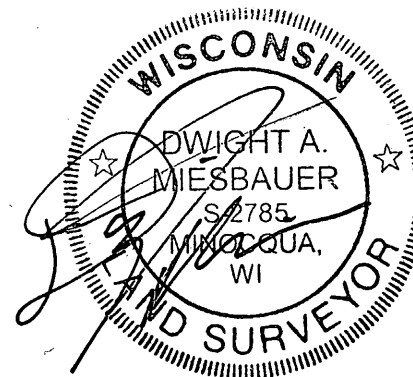

www.survey-north-llc.com
(715)-439-3226

Registered Land Surveyor No. S - 2785
Dwight A. Miesbauer Sr.

Job No. 12R016 Scale: n.a.
Dated the 30th Day of October, 2012
Sheet 2 of 2 sheets