

1011A  
EG. 2-30-5

ONEIDA COUNTY, WIS.

RECEIVED & FILED # **L292**  
 Oneida County Surveyor's Office  
 Date **FEB. 14 1900**  
 By: **MTH**  
 OCS Area #

1/8TH LINE

18.31

AC

1/8TH COR. 5' x 5" POST  
 BEING 1/8TH COR. N. 38° W. 27'  
 BEING 1/8TH COR. S. 32° E. 28'  
 (VAUGHAN'S N.W. 1/4)

SEC. LINE

SE 1/4 - N 1/4

N. 2° 56' E.  
1362.9'

MARSH

S. 2° 55' W.  
1362.9'

1/4 LINE

N. 55° 18' E.  
2571'

IRON PIPE  
 AT B. PINE'S N. 25° W. 27'

IRON PIPE  
 AT COR. SEC. 21 & 22  
 BEING VAUGHAN'S N.E. 1/4  
 BEING 1/4 COR. N. 10° 15' E. 11/4  
 BEING 1/4 COR. S. 15° W. 21'

GENERAL LOCATION THE  
 SEC. 21 & 22 N. E. 3 E.

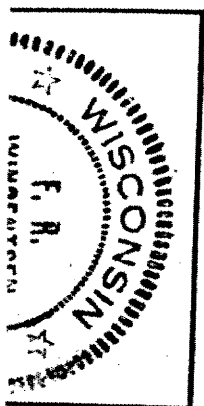
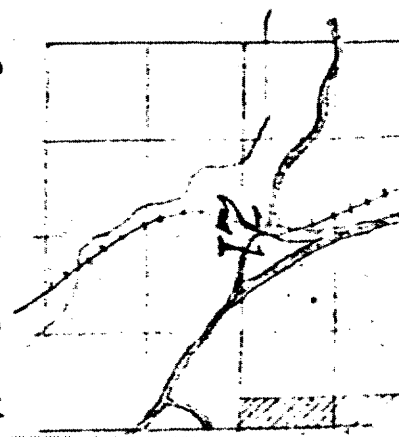

SURVEY FOR  
 KENNETH FOSS

L292

NE 1/4 - NE 1/4 &  
 SE 1/4 - NE 1/4, SEC. 21,  
 T. 37 N. R. 8 E. OF THE 4TH P.M.  
 ADA COUNTY, WIS.

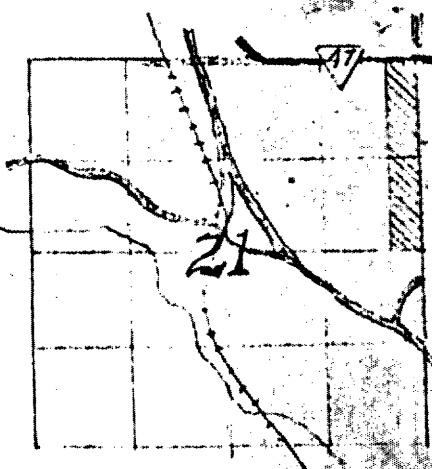

GENERAL LOCATION MAP  
 SEC. 21, T. 37 N. R. 8 E.

VAUGHAN'S N.W. B.T.)  
 2.5' x 5' Post  
 N. 38° W. 27'  
 S. 32° E. 28'

SEC. LINE

S. 2° 55' W.  
 1362.9'

IRON PIPE  
 1/4 COR. SEC. 21 & 22  
 B.T. VAUGHAN'S NE. B.T.  
 B. PINE 10.57' N 112° E  
 (NEW DO 175125' N. 2.6

" Post

N. 2° 55' E.  
 1362.9'

S. 81° 55' W.  
 257.1'

IRON PIPE  
 B.T. B. PINE 8" N 25° W. 27'

SE 1/4 - NE 1/4

MARSH

1/4 LINE



# 548-1

SURVEY  
 FOR  
 KENNETH FOSS  
 RHINELANDER, WIS.

MAY 21, 1949

SCALE 1" = 200'

DWG. NO.  
 548-1

GENISOT ENGINEERING CO.  
 RHINELANDER, WIS.

PART OF THE  
PART OF THE  
T. 37  
ONE

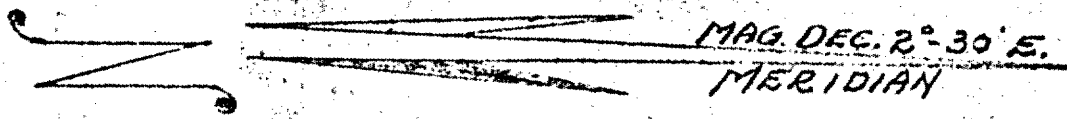

T. H.  
15 S.  
16  
17  
18  
19  
20  
21  
22  
23  
24  
25  
26  
27  
28  
29  
30  
31  
32  
33  
34  
35  
36  
37  
38  
39  
40  
41  
42  
43  
44  
45  
46  
47  
48  
49  
50  
51  
52  
53  
54  
55  
56  
57  
58  
59  
60

SEC. COR. IN ROAD

DIST. = 28'  
IRON PIPE

S. 2°-55' W.  
1334.9'

N. 2°-55' E.  
1329.9'

IRON PIPE  
R.P. { N.W. COR. OF STONE BLDG  
S. 34°-30' E. 33.1'

NE 1/4 - NE 1/4

18.31

1/8TH LINE

R/W LINES  
SEC. LINE

R/W LINES

L292  
L292