

**LOT 7
AND PART OF
LOT 8
IN THE PLAT OF
LAKE MILDRED PARK
LOCATED IN
SECTIONS 19 & 30
T37N, R8E
TOWN OF NEWBOLD
ONEIDA COUNTY, WISCONSIN**

MAP # **L3103** ✓
 DATE FILED 8/19/2016
 BY HB
 DESCRIPTION FILED
 ONEIDA CO. SURVEYOR'S OFFICE

SURVEYOR'S CERTIFICATE

I, Michael L. Oestreich, Professional Land Surveyor No. S-2118, hereby certify that I have surveyed the property shown hereon; that this map represents an accurate survey of said property to the best of my knowledge and belief; that I have performed this survey by order of Carl Corey; and that I have complied with the requirements of Wisconsin Administrative Code A-E 7.

Date: 7/13/16

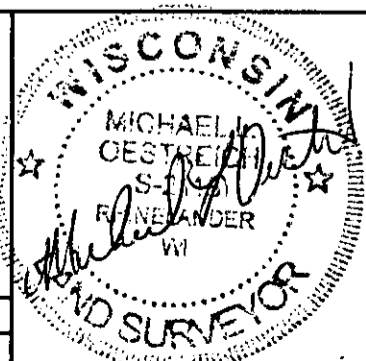

Oestreich
Surveying &
Mapping, LLC
 5946 Forest Lane
 Rhineland, WI 54501
 Tel. (715) 362-5538
 RLS2118@charter.net

Map No. 16-13	Drafted by: M. Oestreich
File No. 19&30-378	Sheet 1 of 1sheet