

copy  
Al Gault

FEB 2 1962

MJH

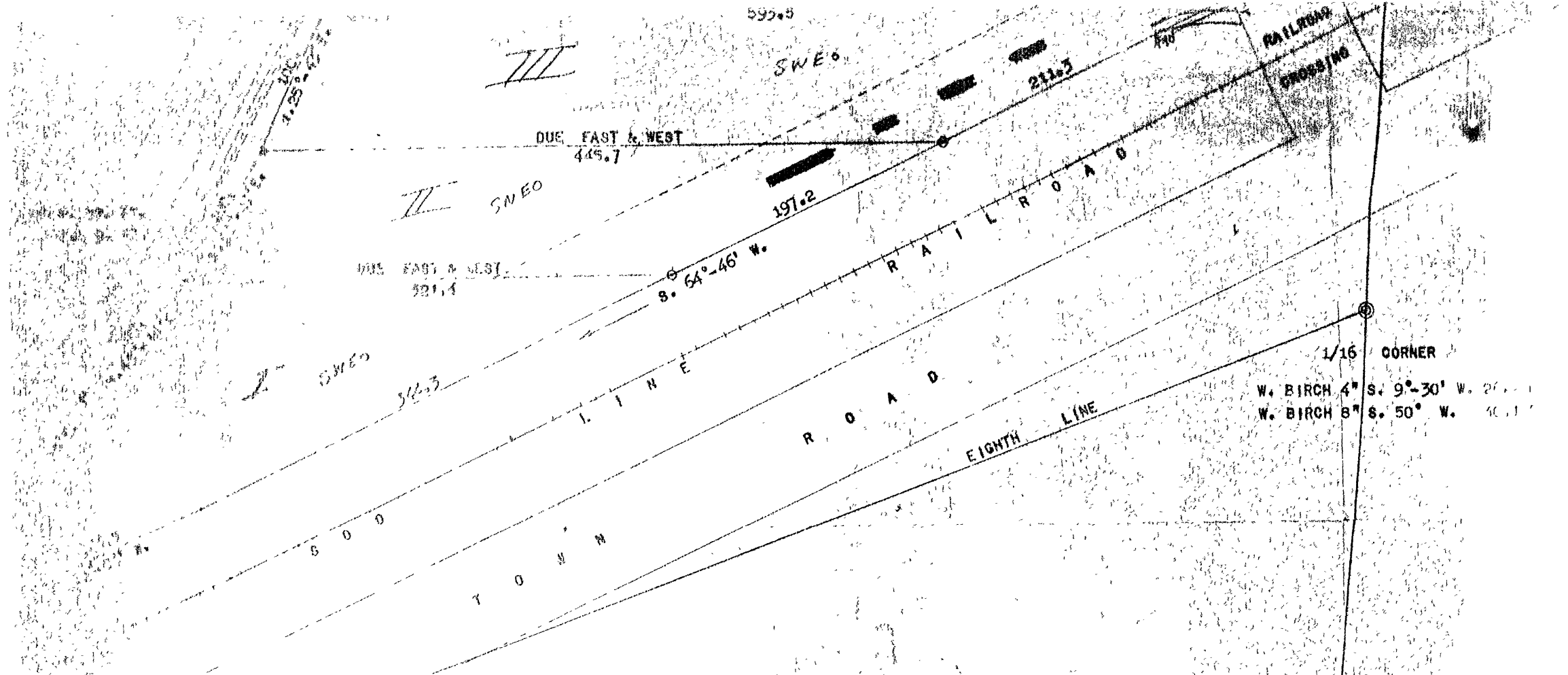

SURVEYOR'S CERTIFICATE

I, KEITH M. HALL, A DULY QUALIFIED AND LICENSED SURVEYOR, HEREBY CERTIFY THAT I HAVE, AT THE REQUEST OF JOSEPH ORY OF RHINELANDER, WISCONSIN, DIVIDED THE ABOVE LAND AS SHOWN ON THIS MAP. THAT THIS MAP WAS MADE BY ME AND IS TO THE BEST OF MY KNOWLEDGE AND BELIEF A CORRECT REPRESENTATION OF MY SURVEY. THE OUTER BOUNDARIES HAVING BEEN ESTABLISHED PRIOR TO MY WORK BY ROBERT E. BANDOW OF THE GENISOT ENG. CO, IN JAN. 1961.

SIGNED THIS 20th DAY OF January 1962.

*Keith M. Hall*  
KEITH M. HALL

REGISTERED LAND SURVEYOR NO. S - 594  
RHINELANDER, WISCONSIN

S. 85° W. 154.3 FT.  
S. 3° W. 78.5 FT.