

Lot 1 of C.S.M. No. 1703
 being part of
Gov't. Lot 4, Section 19, T39N, R7E
 Town of Woodruff
 Oneida County, Wisconsin

SURVEYOR'S CERTIFICATE

I, James D. Rein, Professional Land Surveyor No. S-1234, hereby certify that I have surveyed the property shown hereon; that this map represents an accurate survey of said property to the best of my knowledge and belief; that I have performed this survey by order of Anne Zizzo; and that I have complied with the requirements of Wisconsin Administrative Code A-E 7.

WILDERNESS

SURVEYING, INC.

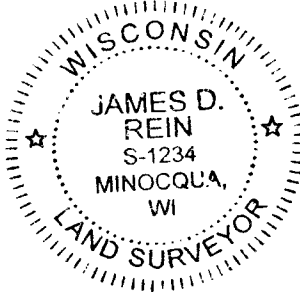

James D. Rein
 Professional Land Surveyor No. S-1234
 Dated this 5th day of June, 2020
 Field survey was completed on May 20, 2020.

Plat of
 Ridgeview
 -4-

Bearings are Oneida County Grid,
 based on GPS survey data, referenced
 to the westerly line of Lot 1, C.S.M.
 No. 1703, bearing N30°10'36"E



Possible Encroachments
 lawn ±12' over line
 corner of wall ±5' over line

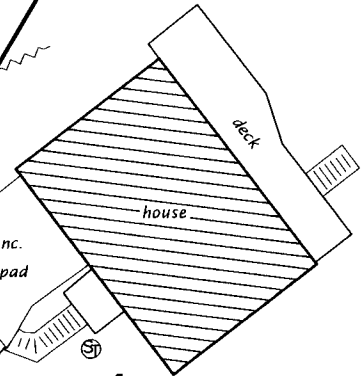

-1-
 ±0.44 acres

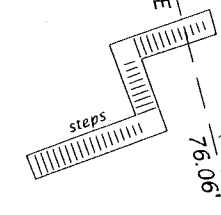

LEGEND

- ⊙ = 1.0" dia. iron pipe found in place
 - ⊙ = 1.75" dia. iron pipe found in place
 - ⊙ = 2.5" dia. iron pipe found in place
 - ⊕ = 5" x 5" concrete monument found in place
 - () = previously recorded bearing and distance
- Monument sizes are outside diameter dimensions.
 Other corner monuments are as noted.

Scale: 1" = 30'



MAP # L3230 ✓
 DATE 6-29-2020
 BY SC
 DESCR
 ONEIDA CO. SURVEYOR'S OFFICE

WILDERNESS SURVEYING, INC.
 Post Office Box 1111 - 8793 Earls Court
 Minocqua, Wisconsin 54548
 Tel. (715) 356-5100
 www.wildernesssurveying.com

Map No: 20-80 Sheet 1 of 1 sheets
 File No: 11-19-397 Drafted by: K. Zarm