

RECEIVED & FILED # **L327**
 Oneida County Surveyor's Office
 Date **FEB 14 1983**
 By **MJH**
 OCS Area #

RECEIVED & FILED # **8051**
 Oneida County Surveyor's Office
 Date **19 02 83**
 By **M. J. H.**
 OCS Area # **6811-4-382**

Note: Boundary is based on a survey by F.R. Wincentsen dated Sept. 8, 1949; northwest corner has been reset 1.63' further north than Wincentsen's corner to put it on the north line of the south 400' of the SE 1/4 of the NW 1/4, per Vol. 164 Deeds, Page 25.

Bearings magnetic

Wincentsen's 1" iron pipe found in place, S0°15'19"W, 1.63'

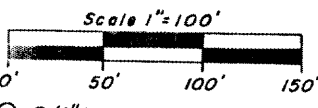

- = 3/4" Iron rod set, weighing 1.50 pounds per lineal foot
- = Iron pipe found in place
- ▨ = Existing building

1/8 Corner
 1 1/4" Well Point (capped) up 12", 3/4" iron pipe along side up 4"
 6" White Birch N65°E, 7.95'
 12" Oak S69°W, 18.55'

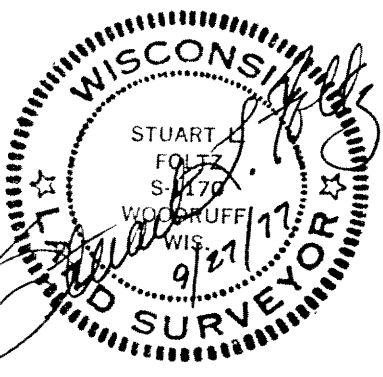

Part of the
SE 1/4 of the NW 1/4
 and of the
NE 1/4 of the SW 1/4
SECTION 14, T39N, R9E
 Sugar Camp Township
 Oneida County, Wisconsin

A parcel of land in the SE 1/4 of the NW 1/4, and in the NE 1/4 of the SW 1/4, Section 14, T39N, R9E, Sugar Camp Township, Oneida County, Wisconsin, more particularly described as follows

Beginning at the southwest corner of the SE 1/4 of the NW 1/4, a 1/8th corner; thence N0°15'19"E, 400.85 feet; thence N86°30'11"E, 385.88 feet; thence along Arbutus Lake S18°06'21"E, 105.00 feet; S0°43'46"E, 101.74 feet; S8°10'34"W, 108.00 feet and S33°18'32"E, 105.57 feet; thence leaving the lake S28°51'08"W, 186.22 feet; thence S86°30'58"W, 376.94 feet; thence N0°57'08"E, 157.95 feet to the place of beginning.

SURVEYOR'S CERTIFICATE: I, Stuart L. Foltz, Registered Land Surveyor No. S-1170, hereby certify that we have surveyed the property described above; that this plat is an accurate survey and a true representation thereof and correctly shows the exterior boundary lines and the correct measurements thereof; that we have made such survey by order of W. Douglas Macdonald, and that we have complied with Chapter 236.34 of the Wisconsin Statutes.

L327